

Flush and extended pushbuttons

Non-illuminated

Momentary and maintained

8

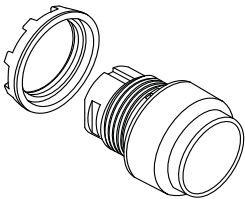
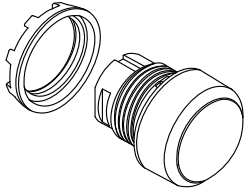

Bezel in black plastic as standard

Bezel in metal:

Replace '1' in the:

Cat No. MPX-1 0X

Ref Code 1SFA 611XXX R 1XXX

3 for metal bezel

4 for grey plastic

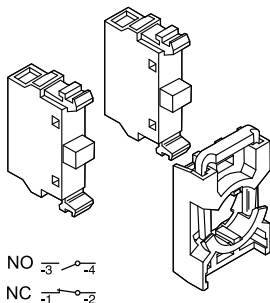

Operator ...

| Description | Catalog No. | Ref. Code |
|--------------------------|----------------|--------------------|
| with flush button | | |
| Momentary | | |
| Red | MP1-10R | 1SFA 611 100 R1001 |
| Green | MP1-10G | 1SFA 611 100 R1002 |
| Yellow | MP1-10Y | 1SFA 611 100 R1003 |
| Blue | MP1-10L | 1SFA 611 100 R1004 |
| White | MP1-10W | 1SFA 611 100 R1005 |
| Black | MP1-10B | 1SFA 611 100 R1006 |
| Clear | MP1-10C | 1SFA 611 100 R1008 |
| Maintained ① | | |
| Red | MP2-10R | 1SFA 611 101 R1001 |
| Green | MP2-10G | 1SFA 611 101 R1002 |
| Yellow | MP2-10Y | 1SFA 611 101 R1003 |
| Blue | MP2-10L | 1SFA 611 101 R1004 |
| White | MP2-10W | 1SFA 611 101 R1005 |
| Black | MP2-10B | 1SFA 611 101 R1006 |
| Clear | MP2-10C | 1SFA 611 101 R1008 |

with extended button

| | | |
|---------------------|----------------|--------------------|
| Momentary | | |
| Red | MP3-10R | 1SFA 611 102 R1001 |
| Green | MP3-10G | 1SFA 611 102 R1002 |
| Yellow | MP3-10Y | 1SFA 611 102 R1003 |
| Blue | MP3-10L | 1SFA 611 102 R1004 |
| White | MP3-10W | 1SFA 611 102 R1005 |
| Black | MP3-10B | 1SFA 611 102 R1006 |
| Clear | MP3-10C | 1SFA 611 102 R1008 |
| Maintained ① | | |
| Red | MP4-10R | 1SFA 611 103 R1001 |
| Green | MP4-10G | 1SFA 611 103 R1002 |
| Yellow | MP4-10Y | 1SFA 611 103 R1003 |
| Blue | MP4-10L | 1SFA 611 103 R1004 |
| White | MP4-10W | 1SFA 611 103 R1005 |
| Black | MP4-10B | 1SFA 611 103 R1006 |
| Clear | MP4-10C | 1SFA 611 103 R1008 |

Contact blocks, and holder

| Blocks | Catalog No. | Ref. Code |
|-------------------------|----------------|--------------------|
| 1 NO with holder | MCBH-10 | 1SFA 611 605 R1101 |
| 1 NC with holder | MCBH-01 | 1SFA 611 605 R1110 |
| 2 NO with holder | MCBH-20 | 1SFA 611 605 R1102 |
| 2 NC with holder | MCBH-02 | 1SFA 611 605 R1120 |
| 1 NO + 1 NC with holder | MCBH-11 | 1SFA 611 605 R1111 |
| 1 NO without holder | MCB-10 | 1SFA 611 610 R1001 |
| 1 NC without holder | MCB-01 | 1SFA 611 610 R1010 |
| Holder for 3 blocks | MCBH-00 | 1SFA 611 605 R1100 |

Ordering example

Requested: A modular pushbutton, momentary, with red flush button and one NO contact.

Ref.: 1 piece of MP1-10R + 1 piece of MCBH-10

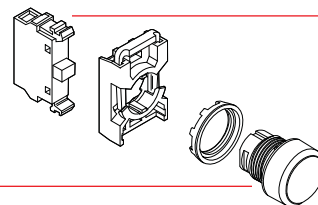

① No contact block in the center position

Flush and extended pushbuttons

Illuminated

Momentary and maintained

Bulb max 1.2 W

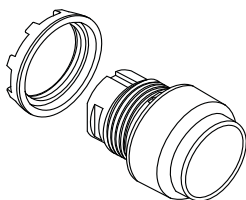
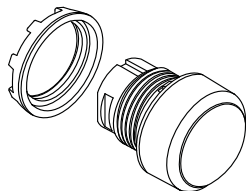

Bezel in black plastic as standard
Bezel in metal:
 Replace '1' in the:
 Catalog No. MPX-1 0X
 Ref. Code 1SFA611XXX R 1XXX
3 for metal bezel
4 for grey plastic bezel

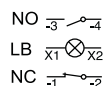
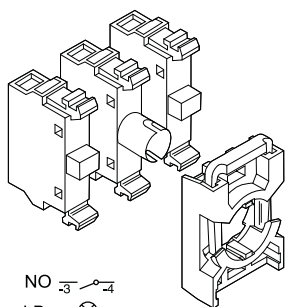

Operator ...

| Description | Catalog No. | Ref. Code |
|-----------------------------|----------------|--------------------|
| with flush button | | |
| Momentary ① | | |
| Red | MP1-11R | 1SFA 611 100 R1101 |
| Green | MP1-11G | 1SFA 611 100 R1102 |
| Yellow | MP1-11Y | 1SFA 611 100 R1103 |
| Blue | MP1-11L | 1SFA 611 100 R1104 |
| White | MP1-11W | 1SFA 611 100 R1105 |
| Clear | MP1-11C | 1SFA 611 100 R1108 |
| Maintained ①② | | |
| Red | MP2-11R | 1SFA 611 101 R1101 |
| Green | MP2-11G | 1SFA 611 101 R1102 |
| Yellow | MP2-11Y | 1SFA 611 101 R1103 |
| Blue | MP2-11L | 1SFA 611 101 R1104 |
| White | MP2-11W | 1SFA 611 101 R1105 |
| Clear | MP2-11C | 1SFA 611 101 R1108 |
| with extended button | | |
| Momentary ① | | |
| Red | MP3-11R | 1SFA 611 102 R1101 |
| Green | MP3-11G | 1SFA 611 102 R1102 |
| Yellow | MP3-11Y | 1SFA 611 102 R1103 |
| Blue | MP3-11L | 1SFA 611 102 R1104 |
| White | MP3-11W | 1SFA 611 102 R1105 |
| Clear | MP3-11C | 1SFA 611 102 R1108 |
| Maintained ①② | | |
| Red | MP4-11R | 1SFA 611 103 R1101 |
| Green | MP4-11G | 1SFA 611 103 R1102 |
| Yellow | MP4-11Y | 1SFA 611 103 R1103 |
| Blue | MP4-11L | 1SFA 611 103 R1104 |
| White | MP4-11W | 1SFA 611 103 R1105 |
| Clear | MP4-11C | 1SFA 611 103 R1108 |

Contact blocks, lamp block and holder ②

| Blocks | Catalog No. | Ref. Code |
|---|-----------------|--------------------|
| 1 NO + 1 LB with holder | MCBH-101 | 1SFA 611 605 R1201 |
| 1 NC + 1 LB with holder | MCBH-011 | 1SFA 611 605 R1210 |
| 2 NO + 1 LB with holder | MCBH-201 | 1SFA 611 605 R1202 |
| 2 NC + 1 LB with holder | MCBH-021 | 1SFA 611 605 R1220 |
| 1 NO + 1 NC + 1 LB with holder | MCBH-111 | 1SFA 611 605 R1211 |
| 1 NO without holder | MCB-10 | 1SFA 611 610 R1001 |
| 1 NC without holder | MCB-01 | 1SFA 611 610 R1010 |
| Lamp block for 2 W, max 230 V AC/DC bulb or LED | MLB-1 | 1SFA 611 620 R1001 |
| Holder for 3 blocks | MCBH-00 | 1SFA 611 605 R1100 |

Ordering example

Requested: A modular pushbutton, maintained and illuminated with green flush button and one NO + one NC contact.

Ref.: 1 piece of MP2-11G + 1 piece of MCBH-111
 Bulb - see accessories

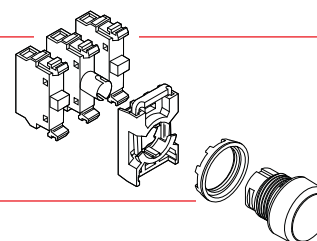

- ① No contact block in the center position
- ② Lamp block MLB-1. Bulb not included. For other lamp blocks see Accessories.
- ③ Bulb max 1.2 W, not included.