

Major League Electronics .0394 cl Surface Mount Box Contact - Straight

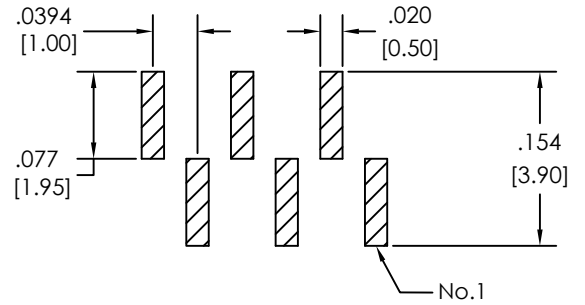

Recommended P.C. Board Layout

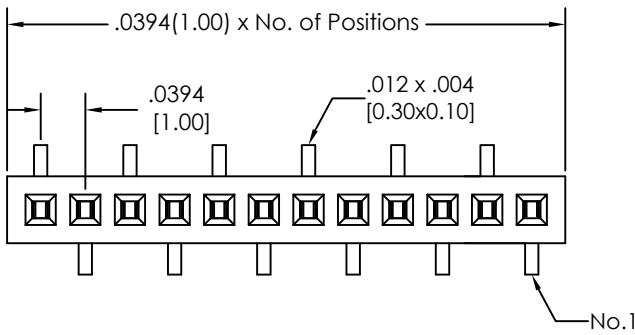
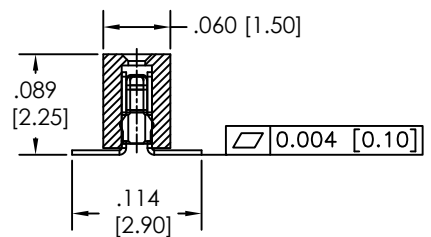
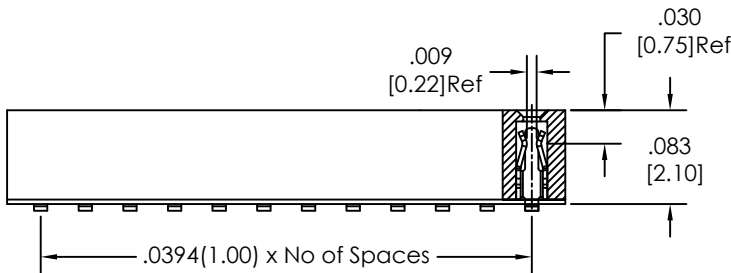

Ordering Information

LSMSS-7 - S - 06 - - - - - - LF

Pins Per Row
02-40

Row Specification
S = Single Row

Style
06 = Surface Mount

Lead Free

Packing Information

TB = Tube

TB-0 = Tube without Pick and Place Pad

TR-P = Tape and Reel with Plastic Pick and Place pad

If left blank, packaging at MLE's discretion

Pad may be metal, mylar or plastic

Polarized Position

Leave blank if not needed

If required, specify empty pin position,
e.g. 012 for Pin 12

Specification

Plating Options	
- Gold Flash over entire Pin	F
- Matte Tin over entire pin	T

Electrical:

Rated Current: 1.0AMP

Contact Resistance: 20mΩ max

Withstand Voltage: 300V AC

Insulation Resistance: 1000MΩ min

Operation Temperature: -40°C to +105°C

Max. Process Temperature

Wave Solder: Solder Temp 260 ±5°C

Immersion period: 5 ±5 secs.

Reflow Solder: Pre-Heat Temp: 100~150°C for 60 secs max.

Temperature: min. 210°C for 30 secs max.

Peak Temperature: 260 ±5°C, 10 ±5 secs.

Manual Solder: 245 ±3°C 3~5 secs.

Material:

Contact Material: Phosphor Bronze

Insulator Material: LCP, UL94V-0

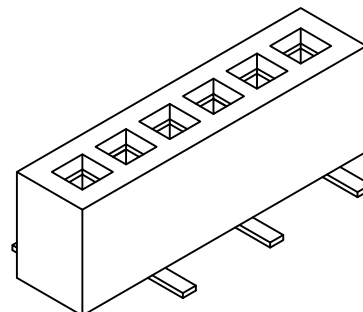

Mates with:
BSTC-7
TSHC-7
TSHCR-7

Products cut to specific sizes are uncancellable/nonreturnable

Parts are subject to change without notice

LSMSS-7-S SERIES

.0394 cl Single Row - Straight
Surface Mount Box Contact

18 NOV 10

Scale
NTS

UNLESS OTHERWISE SPECIFIED
DIMENSIONS IN INCHES [MM]
TOLERANCES ARE:

ONE PLACE DECIMALS ±.010
TWO PLACE DECIMALS ±.006
THREE PLACE DECIMALS ±.004
ANGLES: X,±3.0° .X±2.0°
.XX±1.0° .XXX±0.5°



4235 Earnings Way, New Albany, Indiana, 47150, USA

1-800-782-3486 (USA/Canada/Mexico)

Tel: 812-944-7244

Fax: 812-944-7268

E-mail: mle@mlelectronics.com

Web: www.mlelectronics.com

Edition
1

Sheet
1/1