

1. Features

1. This specification applies Low Profile Power Inductors.
2. 100% Lead(Pb) & Halogen-Free and RoHS compliant.
3. High reliability -Reliability tests comply with AEC-Q200
4. Operating temperature-55~+125°C (Including self - temperature rise)

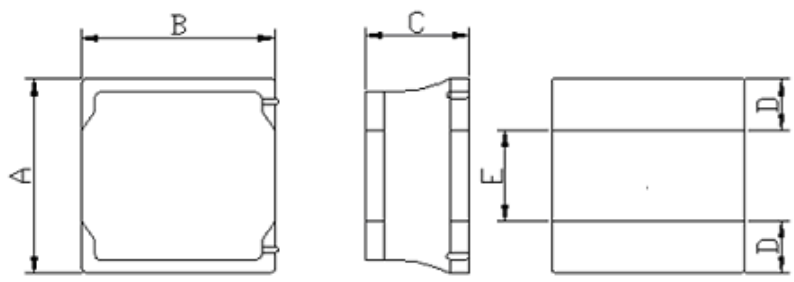

2. Dimension



| Series | A(mm) | B(mm) | C(mm) | D(mm) | E(mm) |
|-----------|---------|---------|----------|----------|----------|
| HPC4015TV | 4.0±0.2 | 4.0±0.2 | 1.5 max. | 1.2 ref. | 1.6 ref. |

Units: mm

3. Part Numbering

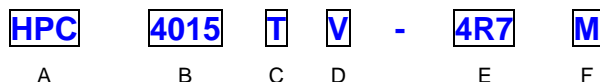

A: Series

B: Dimension

C: Lead Free

D: Inductance

4R7=4.7uH

E: Inductance Tolerance

M=±20%

4. Specification

| TAI-TECH Part Number | Inductance (uH) | Tolerance (%) | Test Frequency (Hz) | DCR (Ω) ±20% | I sat (A)typ. | I rms (A)typ. |
|----------------------|-----------------|---------------|---------------------|--------------|---------------|---------------|
| HPC4015TV-1R0M | 1.00 | ±20% | 1V100K | 33.0 | 4.00 | 3.70 |
| HPC4015TV-1R5M | 1.50 | ±20% | 1V100K | 41.0 | 3.30 | 3.30 |
| HPC4015TV-2R2M | 2.20 | ±20% | 1V100K | 55.0 | 2.90 | 2.90 |
| HPC4015TV-3R3M | 3.30 | ±20% | 1V100K | 65.0 | 2.30 | 2.30 |
| HPC4015TV-4R7M | 4.70 | ±20% | 1V100K | 85.0 | 1.90 | 1.90 |
| HPC4015TV-5R6M | 5.60 | ±20% | 1V100K | 103.0 | 1.70 | 1.70 |
| HPC4015TV-6R8M | 6.80 | ±20% | 1V100K | 110.0 | 1.60 | 1.60 |
| HPC4015TV-100M | 10.0 | ±20% | 1V100K | 160.0 | 1.40 | 1.40 |
| HPC4015TV-150M | 15.0 | ±20% | 1V100K | 230.0 | 1.10 | 1.10 |

.Note:

Isat : Based on inductance change ($\Delta L/L0 : \leq 30\%$) @ ambient temp. 25°CIrms : Based on temperature rise ($\Delta T : 40^\circ\text{C}$.) Max

