

SHIELDED SMD POWER INDUCTOR



PX13316S SERIES



- RoHS Compliant Product
- Operating Temperature: -40°C to +85°C
- Inductance test @ 100KHz, 0.1V_{RMS} @ 0ADC
- Add -M for inductance tolerance ±20% after the part no.
Optional inductance tolerance subject to request.
- I_{DC}: 10% inductance drop typical from its initial value at I_{DC}
- I_{RMS}: Δ40°C temperature rise max at I_{RMS}

ELECTRICAL SPECIFICATION @ 25°C

PART NUMBER PX13316S-	L (μH) ±20%	I _{DC} (A)	I _{RMS} (A)	R _{DC} MAX (W)
102	1.0	5.6	5.0	0.021
152	1.5	5.2	4.5	0.022
222	2.2	5.0	3.8	0.032
332	3.3	3.9	3.3	0.039
472	4.7	3.2	2.7	0.054
682	6.8	2.8	2.2	0.075
822	8.2	2.6	2.1	0.085
103	10	2.4	2.0	0.101
153	15	2.0	1.5	0.150
223	22	1.6	1.3	0.207
333	33	1.4	1.1	0.334
473	47	1.0	0.80	0.472
683	68	0.9	0.70	0.660
104	100	0.8	0.60	1.110
154	150	0.6	0.50	1.550
224	220	0.5	0.37	2.00
105	1000	0.32	0.17	8.30

Mechanical

Schematic

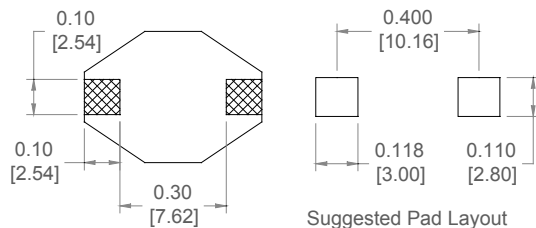
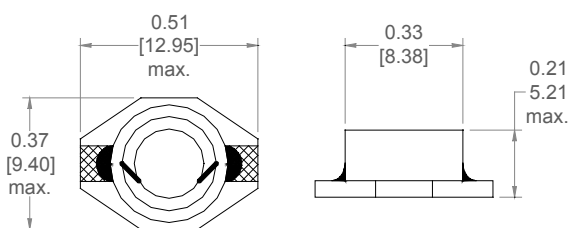

Dimensions

Unless otherwise specified, all tolerances are:

inch: .XX : ± 0.015 .XXX : ±0.010
mm: X,X : ± 0,38 X,XX : ±0,25

Product performance is limited to specified parameter. Data is subject to change without prior notice.

PX13316S-XX
0602JW

13200 Estrella Ave., Bldg. B
Gardena, CA 90248

Tel: (310) 325-1043
Fax: (310) 325-1044

www.mpsind.com
sales@mpsind.com