

Recommended P.C.B Layout

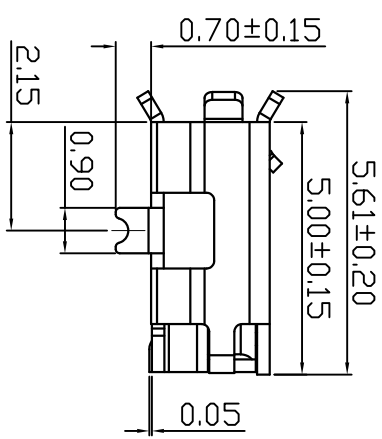
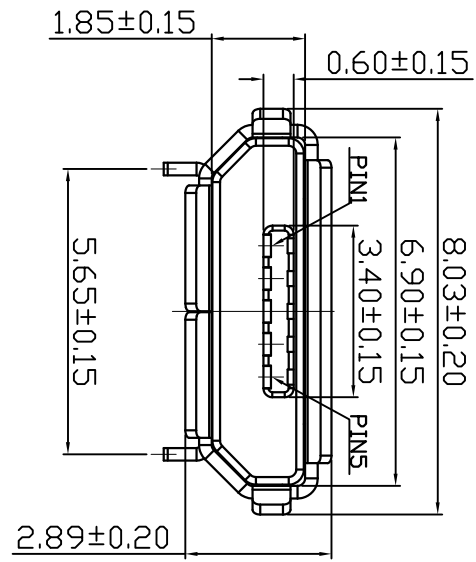

Specification:  
 1.Electrical Characteristics:  
 Current Rating:1A/Contact Terminal  
 Voltage Rating:30V DC  
 Contact Resistance:30 Milliohms Max  
 Dielectric Withstanding Voltage:AC 500V/1MINUTE.  
 Insulation Resistance:500MEGA Ohms /Min.  
 2.Mechanical Characteristics:  
 INSERTION FORCE: 3.57Kgf MAX  
 EXTRACTION FORCE:1.02Kgf Min  
 Durability:5000cycles.EXTRACTION FORCE:1.02-3.57Kgf

③	Shell	1	SPCC	Ni Plating
②	Terminal	5	Bross strip	Au Plating
①	Housing	1	PA (UL 94V-0)	Black
ITEM	PART NAME	QTY.	MATERIAL	FINISHING

APPROVALS		DATE
DRAWN	G.M.Chen	2015/5/22
CHECKED		
APPROVALS		
TOLERANCES ARE		
30 <sup>±0.15</sup>	±0.30	ANGLE
10 <sup>±0.30</sup>	±0.20	UNIT: mm
5 <sup>±0.10</sup>	±0.15	SCALE: 1:1
~ 5	±0.10	SHEET 1 OF 1
		PROJ.

ECN NO.	REV.	DATE.	DESCRIPTION.	CHANGE.	CHECK.	APPRO.
	A		NEW			
DEALON ELECTRONICS CO.,LTD						
USB CONNECTOR						
USB-MR-D-015						