

461 SERIES



DIN 41612 CONNECTORS

Features:

- High density 64 contact 2 row metal-to-metal connector on 2.54mm (.100") grid
- Contact material and finish: brass with selective gold plating and tin on tails:
- CLASS 3: 2- gold flash plating
- CLASS 2: 3- 15μ" of gold plating
- CLASS 1: 6- 30μ" of gold plating
- Contact tails: 0.6 x 0.5mm (.024" x .020")
- Contact spacing: 2.54 x 2.54mm (.100" x .100") single or double rows; or 5.08 x 2.54mm (.200" x .100") single or double rows
- Available in: 5, 8, 10, 16, 20, 32, and 64 positions
- Connectors designed to meet DIN 41612-Q (male) specifications

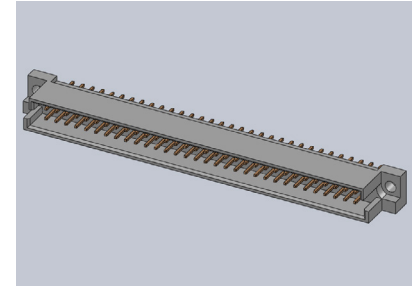

Specifications:

Insulator Material	30% Glass Filled PBT, UL 94V-0
Contact Material	Brass
Contact Plating	Selective Gold Plating
Current Rating	2 Amps @ 20°C
Contact Resistance	30 milliohms maximum
Dielectric Withstanding Voltage	1000 V AC RMS
Insulation Resistance	1000 megaohms
Basic Grid	2.54mm (.100")
Operating Temperature	-40°C to +105°C

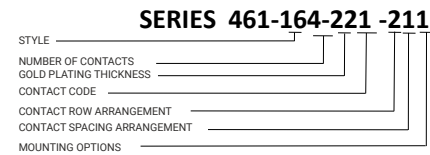

- STYLE:**
- 1- STANDARD STYLE (STRAIGHT)
- GOLD PLATING THICKNESS:**
- 2- GOLD FLASH
 - 3- 15 MICROINCHES OF GOLD
 - 6- 30 MICROINCHES OF GOLD
- CONTACT CODE:**
- 21- PCB TAIL .157 (4.0) LG.
 - 22- PCB TAIL .098 (2.5) LG.
 - 40- W.W. TAIL .512 (13.0) LG.
 - 41- W.W. TAIL .669 (17.0) LG.
 - 70- PRESS-FIT TAIL .182 (4.6) LG.
 - 73- PRESS-FIT TAIL .248 (6.3) LG.
 - 80- PRESS-FIT, W.W.TAIL .512 (13.0) LG.
 - 81- PRESS-FIT, W.W.TAIL .669 (17.0) LG.

- CONTACT ROW ARRANGEMENT:**
- 1- CONTACTS ON ROW "A"
 - 2- CONTACTS ON ROW "A" AND "B"
- CONTACT SPACING ARRANGEMENT:**
- 1- ROWS FULLY LOADED
 - 2- EVEN NUMBER LOADED
- MOUNTING OPTIONS:**
- 1- Ø.110" (Ø2.80mm) , THROUGH HOLE

PITCH	NUMBER OF CONTACTS	CONTACT ROW ARRANGEMENT	CONTACT SPACING ARRANGEMENT	
2.54MM	64	a b	1- ROWS FULLY LOADED 	
	32	a b		
	20	a b		
	2.54MM	32	a -	1- ROWS FULLY LOADED
		16	a -	
		10	a -	
5.08MM	32	a b	2- EVEN NUMBER-LOADED 	
	16	a b		
	10	a b		
	5.08MM	16	a -	2- EVEN NUMBER LOADED
		8	a -	
		5	a -	

