



SMA Female Connector Solder Attachment 2 Hole Flange
 Stub Terminal, .481 inch Hole Spacing, .050 inch Diameter

TECHNICAL DATA SHEET
PE4128-SF
SMA Female Connector Solder Attachment 2 Hole Flange Stub Terminal, .481 inch Hole Spacing, .050 inch Diameter
Configuration

Connector	SMA Female
Connector Specification	MIL-STD-348
Connector Interface Type	Stub
Cable Attachment Method (Shield/Contact)	Solder
Body Style	Straight
Mount Method	2 Hole Flange

Electrical Specifications

Frequency Range, GHz	DC to 18
Impedance, Ohms	50
Maximum VSWR	1.25:1

Mechanical Specifications
Size

Length, in [mm]	1.085 [27.56]
Width/Dia., in [mm]	0.25 [6]
Height, in [mm]	0.625 [15.88]
Weight, lbs [g]	0.005 [2.27]

Connector

Type	SMA Female
Contact Material and Plating	Beryllium Copper, Gold
Contact Plating Specification	MIL-G-45204, Type II, Class 2
Body Material and Plating	Passivated Stainless Steel
Body Plating Specification	QQ-P-35
Dielectric Type	Teflon

Compliance Certifications (visit www.Pasternack.com for current document)

RoHS Compliant	Yes
----------------	-----

Plotted and Other Data

Notes:	Values at 25 °C, sea level
--------	----------------------------

Click the following link (or enter part number in "SEARCH" on website) to obtain additional part information including price, inventory and certifications: [SMA Female Connector Solder Attachment 2 Hole Flange Stub Terminal, .481 inch Hole Spacing, .050 inch Diameter PE4128-SF](#)

The information contained in this document is accurate to the best of our knowledge and representative of the part described herein. It may be necessary to make modifications to the part and/or the documentation of the part, in order to implement improvements. Pasternack reserves the right to make such changes as required. Unless otherwise stated, all specifications are nominal.



SMA Female Connector Solder Attachment 2 Hole Flange
Stub Terminal, .481 inch Hole Spacing, .050 inch Diameter

TECHNICAL DATA SHEET

PE4128-SF

SMA Female Connector Solder Attachment 2 Hole Flange Stub Terminal, .481 inch Hole Spacing, .050 inch Diameter from Pasternack Enterprises has same day shipment for domestic and International orders. Our RF, microwave and fiber optic products maintain a 99% availability and are part of the broadest selection in the industry.

Click the following link (or enter part number in "SEARCH" on website) to obtain additional part information including price, inventory and certifications: [SMA Female Connector Solder Attachment 2 Hole Flange Stub Terminal, .481 inch Hole Spacing, .050 inch Diameter PE4128-SF](http://www.pasternack.com/sma-female-standard-stub-terminal-connector-pe4128-sf-p.aspx)

URL: <http://www.pasternack.com/sma-female-standard-stub-terminal-connector-pe4128-sf-p.aspx>

The information contained in this document is accurate to the best of our knowledge and representative of the part described herein. It may be necessary to make modifications to the part and/or the documentation of the part, in order to implement improvements. Pasternack reserves the right to make such changes as required. Unless otherwise stated, all specifications are nominal.

PE4128-SF CAD Drawing

SMA Female Connector Solder Attachment 2 Hole Flange Stub
Terminal, .481 inch Hole Spacing, .050 inch Diameter

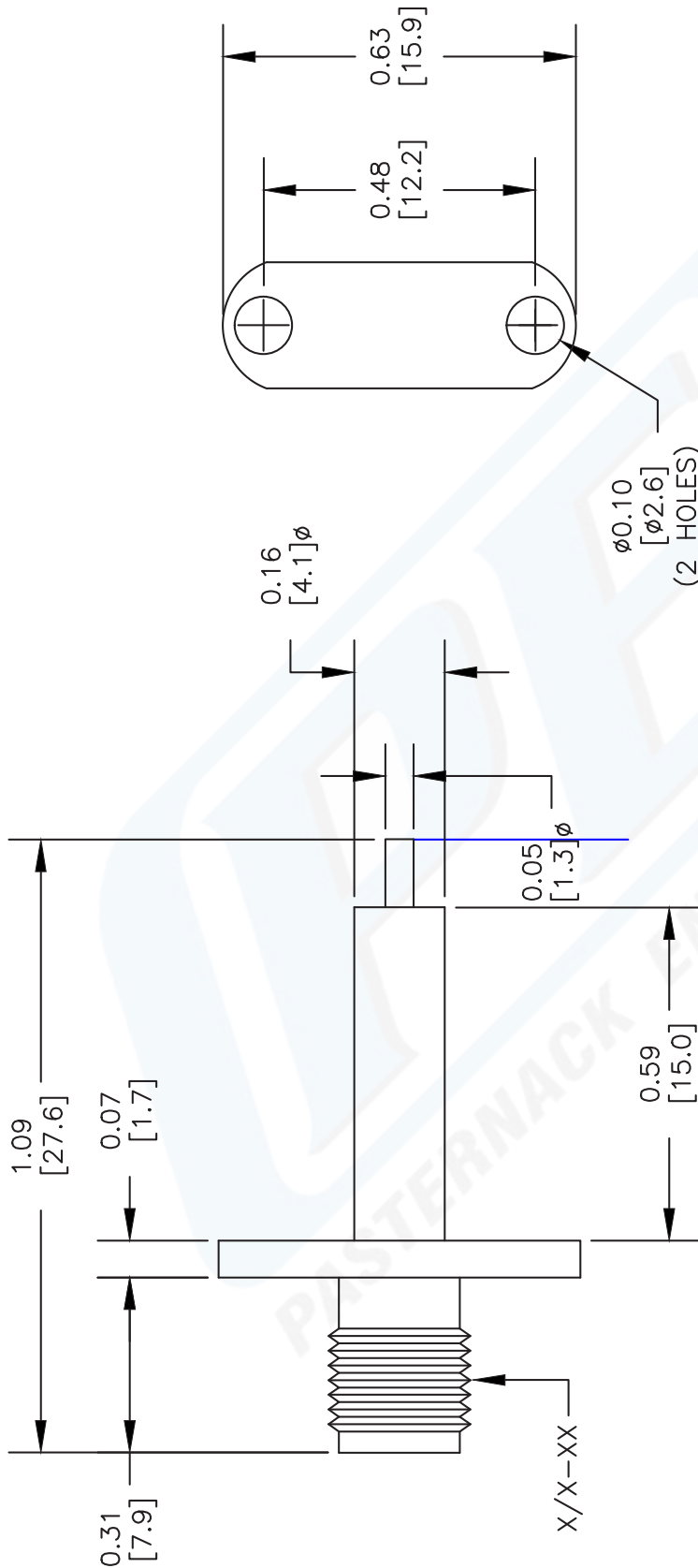

NOTES:
1. UNLESS OTHERWISE SPECIFIED ALL DIMENSIONS ARE NOMINAL.
2. ALL SPECIFICATIONS ARE SUBJECT TO CHANGE WITHOUT NOTICE AT ANY TIME.
3. DIMENSIONS ARE IN INCHES [mm].
4. FITS MIL-C-17 AND EQUIVALENT CABLES.

DWG TITLE
PE4128-SF

FSCM NO. 53919

CAD FILE 011904
SCALE N/A
SIZE A
XXXX

PE PASTERNAK
Pasternack Enterprises, Inc.
P.O. Box 16759 | Irvine | CA | 92623
Phone: (949) 261-1920 | Fax: (949) 261-7451
Website: www.pasternack.com | E-Mail: sales@pasternack.com