

C/A-5001X SINGLE DIGIT DISPLAY

| Shape | Part No. | | Chip | | Wave Length λ_p (nm) | Electro-Optical Characteristics | | | Fig. No. |
|---|----------------|--------------|--------------|---------------|---------------------------------|---------------------------------|------|-------------|----------|
| | Common Cathode | Common Anode | Raw Material | Emitted Color | | Vf(V)20mA | | Iv(ucd)10mA | |
| | | | | | | Typ. | Max. | Typ. | |
|  | C-5001H | A-5001H | GaP | Red | 700 | 21.0 | 23.0 | 8000 | D24 |
| | C-5001E | A-5001E | GaAsP/GaP | Hi. effi Red | 635 | 20.0 | 22.0 | 30000 | |
| | C-5001G | A-5001G | GaP | Green | 565 | 21.0 | 23.0 | 30000 | |
| | C-5001Y | A-5001Y | GaAsP/GaP | Yellow | 585 | 21.0 | 23.0 | 30000 | |
| | C-5001SR | A-5001SR | GaAlAs | Super Red | 660 | 18.0 | 20.0 | 60000 | |

Fig.D24



C-5001X

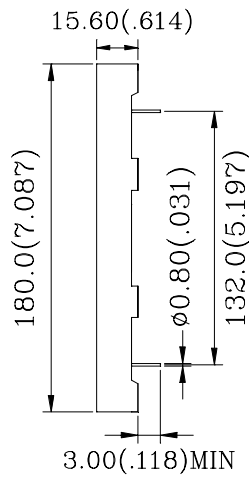
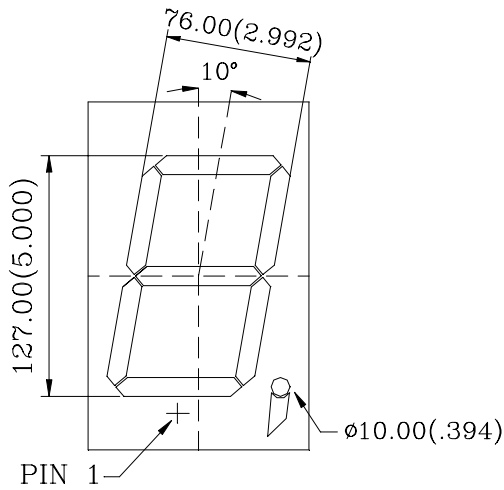
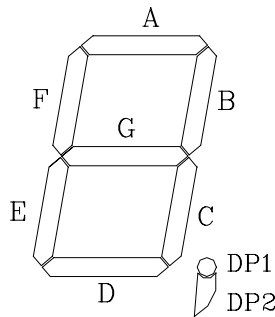
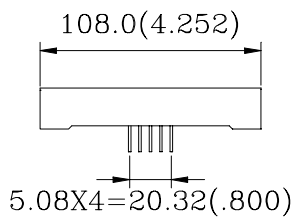
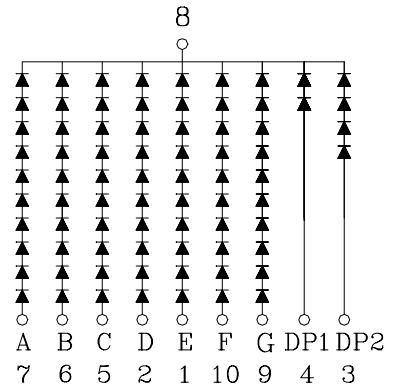

A-5001X

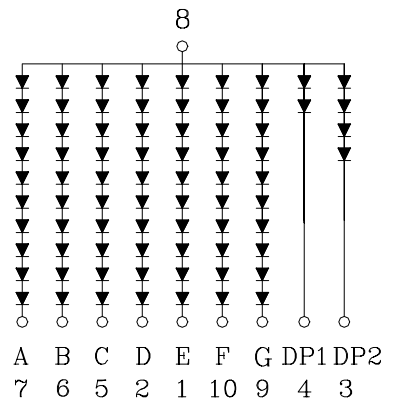

1.All dimension are in millimeters (inches).
2.Tolerance is ± 0.25 mm (0.01") unless otherwise specified.