

NO.	ECN NO.	DESCRIPTION	REV.	DRAW	DATE
1					

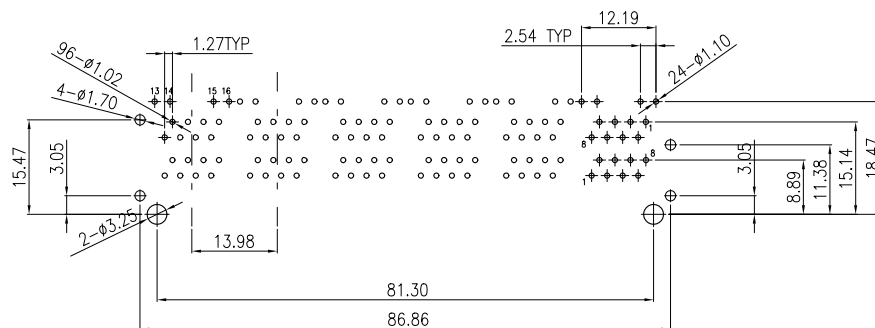

RECOMMENDED P.C.B LAYOUT TOP VIEW  
(COMPONENT SIDE TOLERANCE ±0.05)

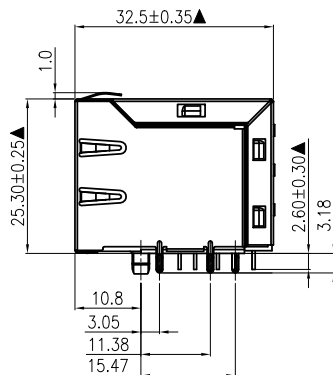
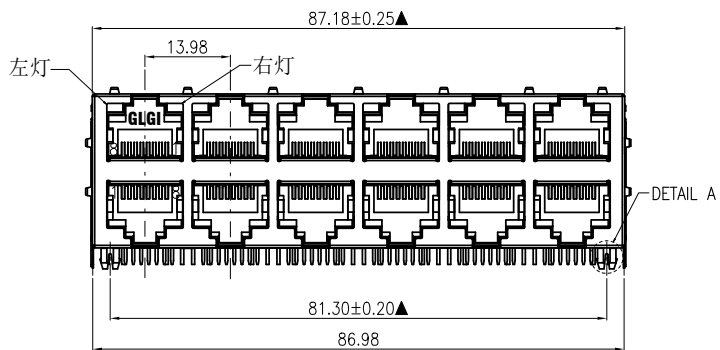
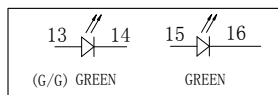
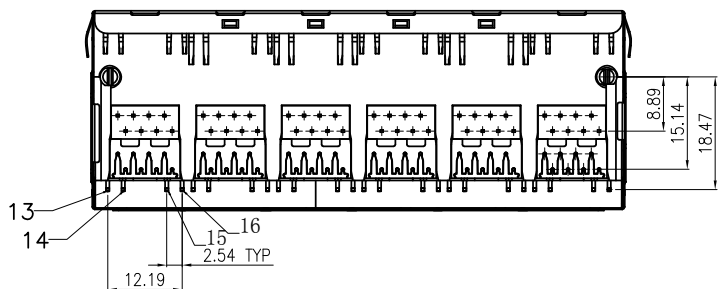

LED PIN DEFINE

MATERIALS:

- Housing: PA46 BLACK (RoHS).
  - Insert: PBT BLACK (RoHS).
  - Shielding: SUS201 T=0.20mm (RoHS).
  - Contact: C5210 T=0.35x0.44mm (RoHS).
  - Led1: GREEN (RoHS).
  - Led2: GREEN (RoHS).
- ※MATES WITH MODULAR PLUG CONFORMING TO FCC PART 68, SUBPART F.  
※凡标注▲记号者, 为重点尺寸.

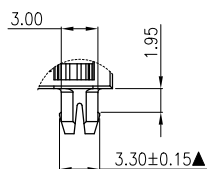

DETAIL A (2:1)

45048-XX X X X 1

规格流水码

电镀代码

电镀规格  
M 半金雾锡

11-3u"

产品客户图 Customer Drw		GLGNET® 深圳市方向电子股份有限公司 SHEN ZHEN GLGNET ELECTRONICS CO., LTD.			
未注公差 TOLERANCE UNLESS OTHERWISE SPECIFIED	.X	±0.35	设计 DESIGN	品名 TITLE	5931-Q-S-K11-2x6-L-8C-99(G/G)
	.XX	±0.25			
	.XXX	±0.15			
	X°	±3°			
比例 SCALE	1:1	角法 PROJ.	设计 DESIGN	品名 TITLE	
张数 SHEET	1/1	大小 SIZE	A4	校对 CHECKED	料号 ITEM NO.
单位 UNIT	mm	版本 REV.	J3	核准 APPROVED	图号 DWG NO.
					45048-99M11
					GLG-WL-209