

DASH NO. M CODE MADE FROM

REVISIONS

| ISSUE | CHANGES |
|-------|--|
| 1 | CN 29221 C REDRAWN EAJ 10 SEP 87 |

879-2-1

GSD

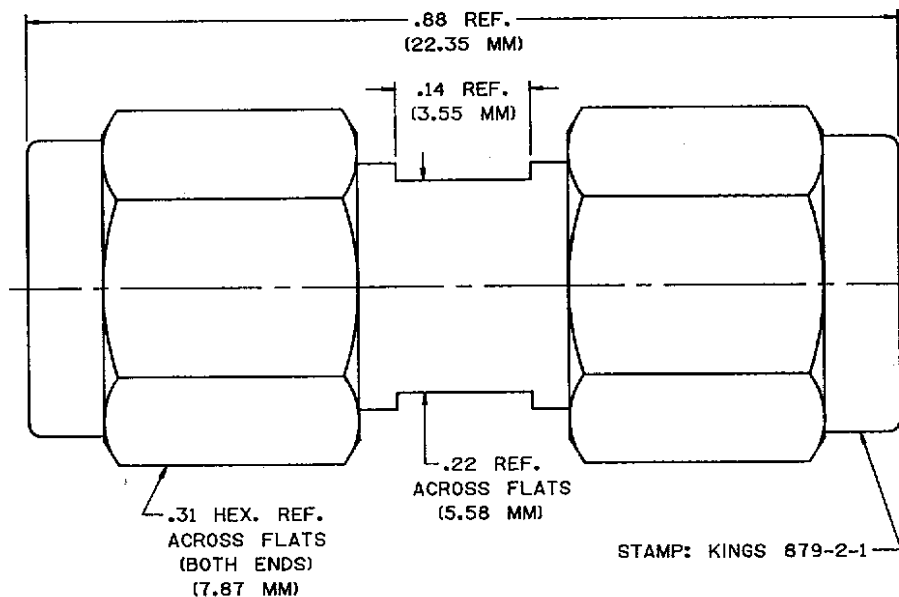

NOTES:

- MATERIALS:
INSULATOR: TEFLON, L-P-403
GASKET: SILICONE RUBBER, ZZ-R-765
CENTER CONTACT: BRASS, QQ-B-626
C-RING: BERYLLIUM COPPER, QQ-C-530
ALL OTHER METAL PARTS:
STAINLESS STEEL, 303
- FINISHES:
CENTER CONTACT } GOLD PLATE PER
BODY } MIL-G-45204
COUPLING NUT }
- ELECTRICAL CHARACTERISTICS:
NOMINAL IMPEDANCE: 50 OHMS
FREQUENCY RANGE: 0 TO 12.4 GHZ
DIELECTRIC WITHSTANDING VOLTAGE:
1000 VOLTS RMS 60 HZ AT SEA LEVEL

SCALE: 8:1

APPROX. SURFACE AREA

USED ON:

REF:

DISC NO. FA35 FILE NO. FA0235.SD

SMA ADAPTER (M-M)

DRAWN EAJ DATE 10SEP87

APPR. GA DATE 16SEP87

APPR. W DATE 9/21/87

KINGS
ELECTRONICS CO., INC.
TUCKAHOE, NEW YORK 10701

GSD

879-2-1

UNLESS OTHERWISE SPECIFIED:

- TOLERANCES: FRACTIONS ± 2 PLACE DECIMALS ± .010
3 PLACE DECIMALS ± .004 ANGLES ± 0°30'
- T.I.R. CONCENTRICITY OF ANY 2 DIAMETERS MAY NOT EXCEED HALF THE SUM OF THEIR TOLERANCES.

- REMOVE ALL BURRS, BREAK ALL SHARP EDGES .005 MAX.
- NO FILLETS PERMITTED.
- SURFACE ROUGHNESS 83 MICROINCHES RMS MAX.
- ALL DIMENSIONS PRIOR TO PLATING
- ALL PLATING IN ACCORDANCE WITH KER 10004