

REV	CONTENT	CHK	DATE
VO.0	CONTENT	YL	22.11.19

Electrical :

- | | | |
|--|------|------|
| | UL | IEC |
| 1. Rated Voltage : | 300V | 320V |
| 2. Rated Current : | 15A | 20A |
| 3. Withstanding Voltage : AC1600V/1Min. | | |
| 4. Operating Temperature : -40°C~+105°C | | |
| 5. RoHS Compliance | | |
| 6. Safety Approval : | | |
| 7. "★" is the key quality control point. | | |

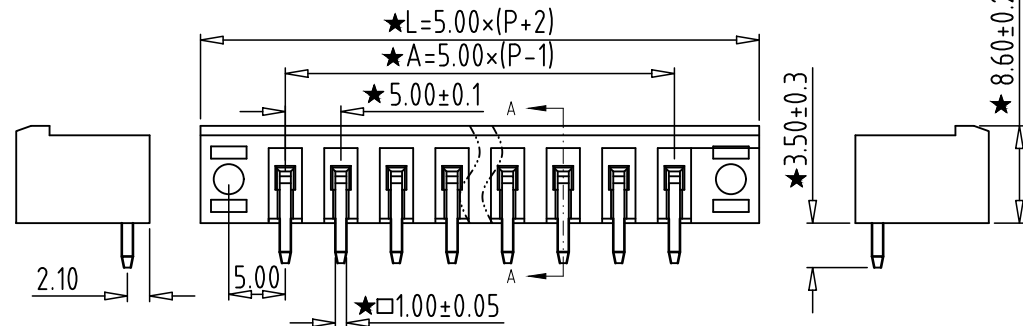
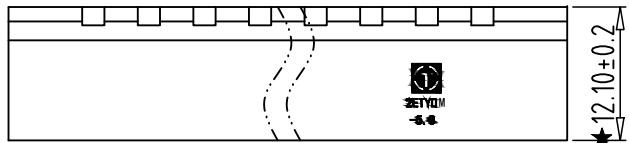
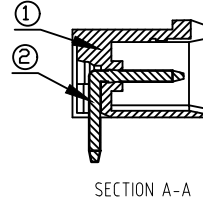
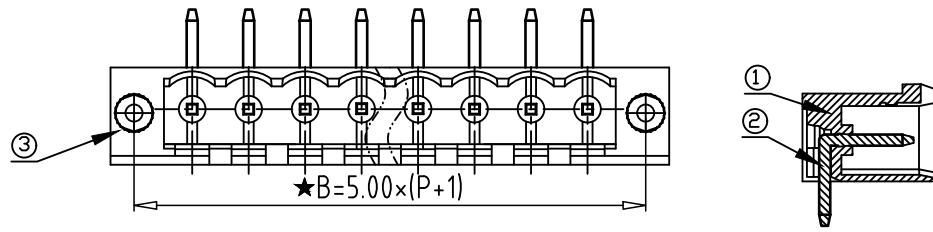
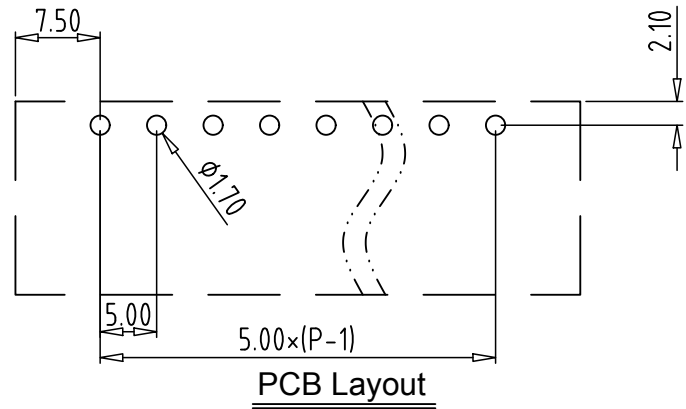

2ETYRM - 5.0 -XXP - X X - 100AH

- | | |
|-----------------------------------|------------------|
| ① Series NO. | ④ 1 Single Pitch |
| | ④ 2 Double Pitch |
| ② Pitch | ⑤ Color: 1 Grey |
| | ⑤ 2 Blue |
| | ⑤ 3 Black |
| | ⑤ 4 Green |
| ③ Poles | ⑤ 5 Orange |
| ③ 02 02Contacts | ⑤ 6 Red |
| ③ 03 03Contacts | ⑤ 7 Transparent |
| ③ ... | ⑤ 8 Yellow |
| ③ 24 24Contacts | ⑤ 9 White |
| ⑥ Customer Request: 100--Standard | |

Total Pitch Tolerances in mm									Nominal dimension range in mm										⊥		=			-			//						
over 0	over 30	over 53	over 70	over 90	over 115	over 150	over 250	over 350	over 0	over 30	over 53	over 70	over 90	over 115	over 150	over 200	over 250	over 320	0	over 10	all	0	100	150	0	100	150	0	100	150	0	100	150
±0.18	±0.20	±0.25	±0.3	±0.35	±0.44	±0.60	±0.70	±0.85	±0.20	±0.25	±0.30	±0.35	±0.44	±0.55	±0.70	±0.80	±0.90		0.2	0.3	0.3	0.2	0.3	0.5	0.2	0.3	0.5	0.2	0.3	0.5	0.2	0.3	0.5

3	NUT	XX	2	BRASS	/			
2	PIN	XX	P	BRASS	Tin Plated			
1	HOUSING	XX	1	PA66 UL94V-0	SEE NOTE			
ITEM	NAME OF PART		NO. OF PART		Q'TY	MATERIAL	NOTE	
DWG.	YL	DATE	22.11.19		SIZE	A4	UNITS	mm
CHK.	DATE				SCALE	1:1		
APP.	DATE				NAME	2ETYRM-5.0-XXP-XX-100AH		
拓宜(上海)工控电器设备有限公司 Topone (Shanghai) Industrial Control Electrical Equipment Co., LTD.					DWGNO.	XXXXX		