

# Major League Electronics .100 cl Low Profile Side Wipe Socket Strip

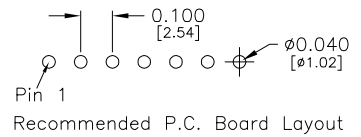
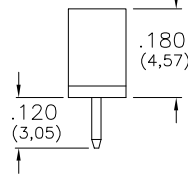
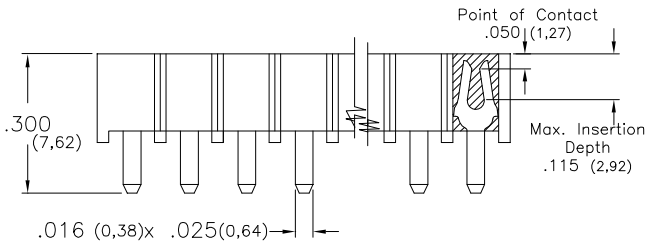
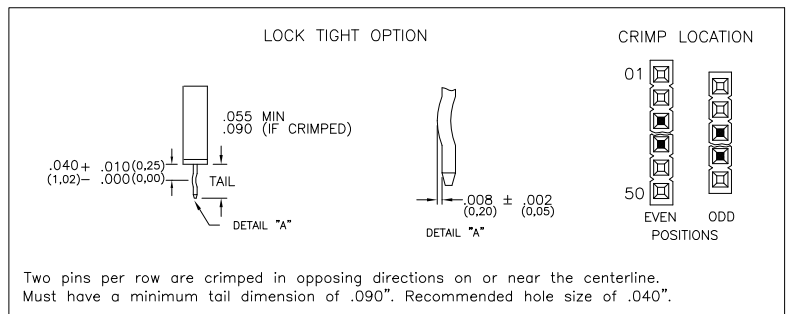
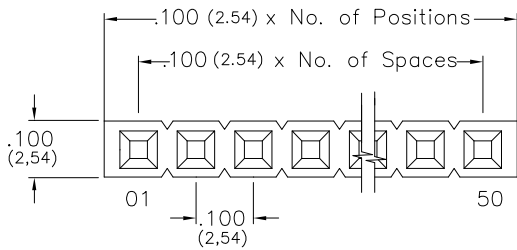

Tails may be clipped to achieve desired pin length

## Ordering Information

**LSWSS-1** [XX] - **S** - **02** - [XX] - [XX] - [XXX] - [X] - **LF**

Pins Per Row: 01 - 50

Row Specification: S = Single Row

Pin Style	
.120 (3.05) - Tail/Foot	02

Plating Options	
- 10µ Gold on Contact area/Flash on Tail	G
- Matte Tin all Over	T
- 10µ Gold on Contact Area / Matte Tin on Tail	GT
- 30µ Gold on Contact Area / Matte Tin on Tail	H
- Gold Flash over Entire Pin	F

Lead Free

Every Other Pin Filled  
Leave blank if not needed  
E = Filled

Polarized Position  
Leave blank if not needed  
If required, specify empty pin position, e.g. 012 for Pin 12

Lock Tight "LT" (Optional)  
Leave blank if not needed  
LT = With

## Specifications

Insertion Depth: .085 (2,16mm) to .115 (2,92mm)  
 Insertion Force - Per Contact:  
 12oz. Avg (3,34N) with .025 (0,64mm) sq. pin  
 Withdrawal Force - Per Contact:  
 6oz. Avg (1,67N) with .025 (0,64mm) sq. pin  
 Current Rating: 3.0 Ampere  
 Insulation Resistance: 1000MΩ Min.  
 Dielectric Withstanding: 600V AC  
 Contact Resistance: 10 mΩ Max.  
 Operating Temperature: -40°C to + 105°C  
 Max. Process Temperature:  
 Peak: 260°C up to 20 secs.  
 Process: 230°C up to 60 secs.  
 Wave: 260°C up to 6 secs.  
 Manual Solder: 350°C up to 5 secs.

## Materials

Contact Material: Phosphor Bronze  
 Insulator Material: Nylon 6T  
 Plating: Au or Sn over 50µ" (1,27) Ni

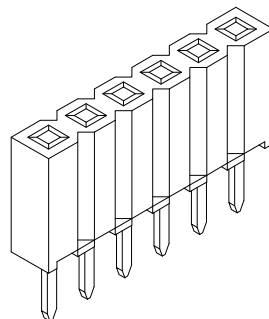

## Mates with:

BSTC, TSHCR,  
 BSTCM, TSHCRE,  
 BSTCR, TSHCRSM,  
 BSTCRSM, TSHR,  
 BSTS, TSHRE,  
 LBSTCM, TSHS,  
 LTSHCR, TSHSCM,  
 LTSHCRE, TSHSM,  
 LTSHR, ULTSHSM,  
 LTSHRE, ULTSHC,  
 LTSHSM, ULTSHCR,  
 TSHC,

Products cut to specific sizes are uncancellable/nonreturnable

Parts are subject to change without notice

**LSWSS-1-S-02 SERIES**

.100 cl Single Row  
Side Wipe Socket Strip

16 JAN 07

Scale  
NTS

UNLESS OTHERWISE SPECIFIED  
DIMENSIONS IN INCHES (MM)  
TOLERANCES ARE:

ONE PLACE DECIMALS ±.100  
TWO PLACE DECIMALS ±.010  
THREE PLACE DECIMALS ±.005  
FOUR PLACE DECIMALS ±.0020

ANGLES  
±.5



4235 Earnings Way, New Albany, Indiana, 47150, USA  
 1-800-782-3486 (USA/Canada/Mexico)  
 Tel: 812-944-7244  
 Fax: 812-944-7268  
 E-mail: mle@mlelectronics.com  
 Web: www.mlelectronics.com

Edition  
B

Sheet  
1/2

## Revisions

Revision B - 27th May 2010

Plastic height dimension - conversion amended  
*previously .180 (6,73)*  
now .180 (4,57)

LSWSS-1-S-02 SERIES

.100 cl Single Row  
Side Wipe Socket Strip

16 JAN 07

Scale  
NTS

UNLESS OTHERWISE SPECIFIED  
DIMENSIONS IN INCHES (MM)  
TOLERANCES ARE:

ONE PLACE DECIMALS ±.100  
TWO PLACE DECIMALS ±.010  
THREE PLACE DECIMALS ±.005  
FOUR PLACE DECIMALS ±.0020

ANGLES  
±3°



4235 Earnings Way, New Albany, Indiana, 47150, USA  
1-800-782-3486 (USA/Canada/Mexico)

Tel: 812-944-7244  
Fax: 812-944-7268

E-mail: [mle@mlelectronics.com](mailto:mle@mlelectronics.com)  
Web: [www.mlelectronics.com](http://www.mlelectronics.com)

Edition  
B

Sheet  
2/2