

DWG. NO.		312-010-6143G	
REV.	DESCRIPTION	BY DATE	APPD.
F	ECR 6794	10/01/98 GJC	<i>[Signature]</i>

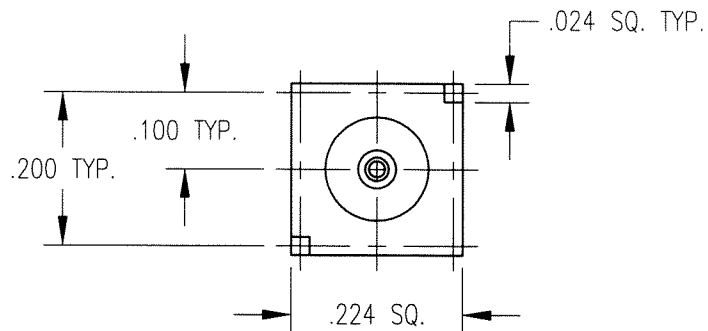
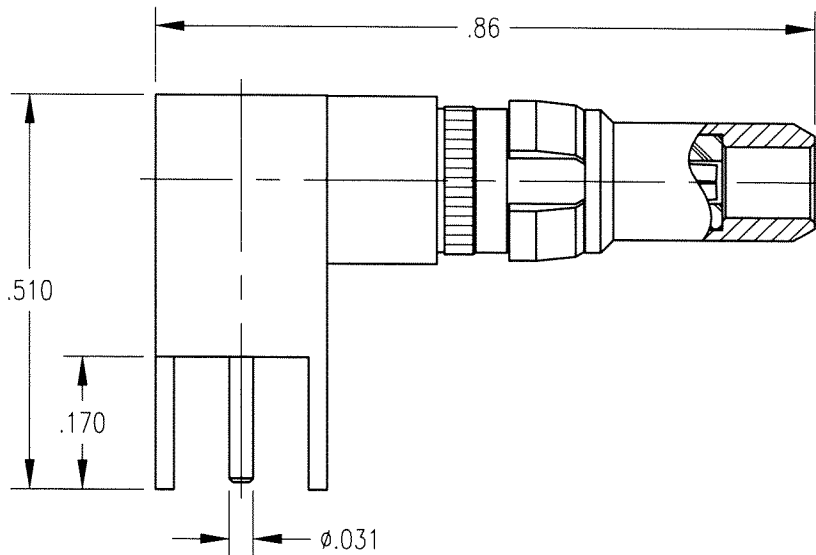
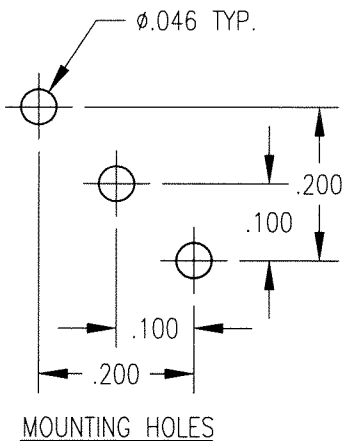

NOTES:

1. MATERIALS:  
 BODY: BRASS PER ASTM B16  
 FRONT CONTACT: COPPER ALLOY  
 INSULATOR: TEFLON PER ASTM D1710  
 CLIP RING: BERYLLIUM COPPER PER ASTM B194
2. FINISH:  
 BODY AND CONTACT: .000030 MIN. GOLD PER MIL-G-45204  
 OVER .000050 MIN. NICKEL PER QQ-N-290  
 CLIP RING: .000100 MIN. NICKEL PER QQ-N-290 OVER  
 COPPER FLASH

PER ASME Y14.5M-1994 UNLESS OTHERWISE SPECIFIED: DIMENSIONS ARE IN INCHES [MM]				<b>Litton</b> <b>Winchester/Retconn</b> 400 Park Road Waterford, Connecticut 06795				
TOLERANCES: DECIMALS .xx ± .01/0.254 xxx ± .005/0.127 ANGLES ± 2° SCALE: 6:1								
CUSTOMER DRAWING				A	312-010-6143G	SMT	OF	
DRAWN	DATE	CHECKED	DATE					1
JMC	8/5/98	EJW	8/5/98					
APPROVED	DATE	APPROVED	DATE					
PRP	8/5/98	PRP	8/5/98					