

## SURFACE MOUNT COMMON MODE CHOKES

### XFCMC1,CMC2,CMC3,CMC6 SERIES

- \* Designed for DC/DC converters or where ever common mode attenuation is required
- \* Tape & reel packaging available
- \* 500Vac Isolation
- \* High perm ferrite toroid design
- \* Maximum versatility
- \* Custom variations available at no extra charge
- \* Operating Temperature:  $-30^{\circ}$  to  $+120^{\circ}$

### Electrical Specifications @ 25°C:

Part Number	Rated Current For 55°C Rise (Amps)	Inductance (mH±25)	DCR Ohms Max	PACKAGE STYLE
XF0013-CMC1	1.5	1.00	0.060	CMC1
XF0103-CMC1	1.0	10.00	0.450	CMC1
XF0223-CMC1	0.50	22.00	0.850	CMC1
XF0013-CMC2	3.60	1.0	0.050	CMC2
XF0033-CMC2	2.50	3.0	0.080	CMC2
XF2256-CMC3	3.30	0.225	0.060	CMC3
XF7686-CMC3	4.70	0.768	0.040	CMC3
XF1323-CMC3	3.30	1.320	0.060	CMC3
XF5906-CMC3	5.60	0.590	0.020	CMC3
XF0023-CMC3	2.80	1.590	0.080	CMC3
XF0013-CMC6	1.22	1.170	0.220	CMC6
XF8846-CMC6	1.63	0.884	0.110	CMC6

### Schematics:

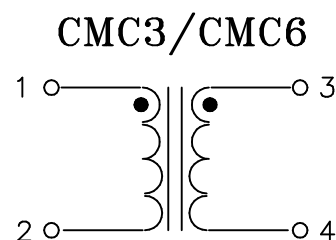
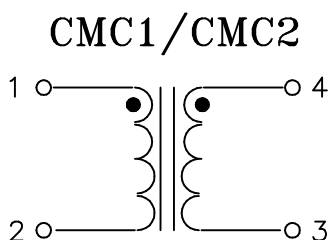

## Mechanical:

### XFCMC1

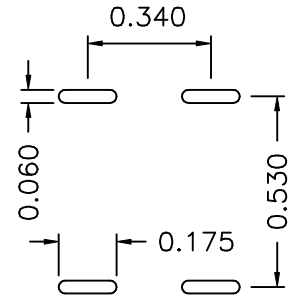
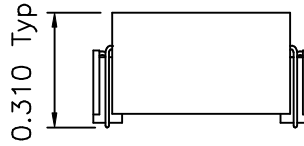
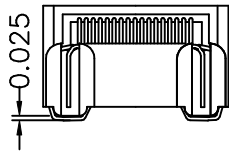
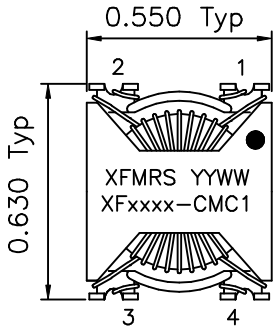

(SUGGESTED MOUNTING PAD)

### XFCMC2

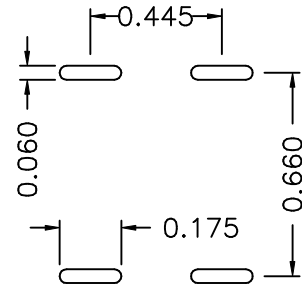
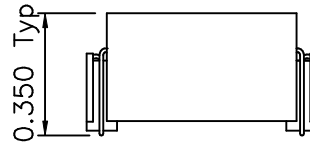
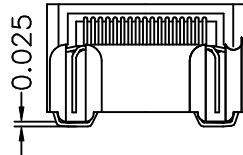
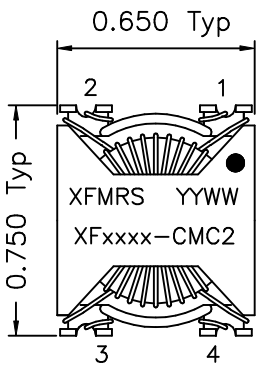

(SUGGESTED MOUNTING PAD)

### XFCMC3

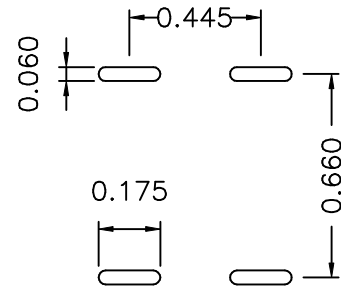
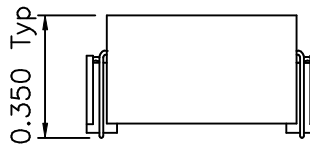
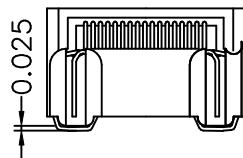
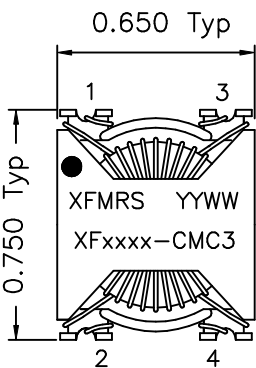

(SUGGESTED MOUNTING PAD)

### XFCMC6

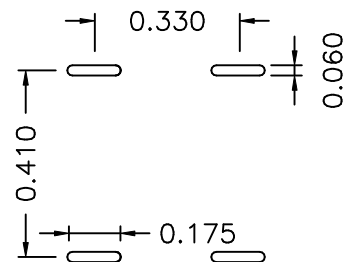
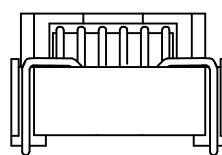
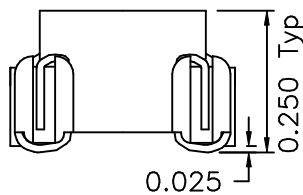
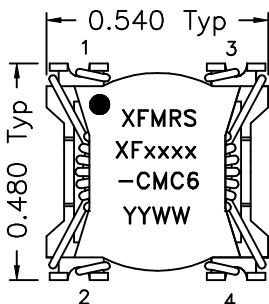

(SUGGESTED MOUNTING PAD)