

Storage Choke, fully potted resign



Approvals and Compliances

Description

- Storage choke
- THT-terminals
- Reduced magnetic reversal
- Constant inductance at high alternating field modulation and large DC magnetization
- Constant inductance at high alternating field modulation and large DC magnetization
- Fully potted resign

Applications

- Storage of energy in switched power supplies
- Switch-mode
- Chopper amplifiers
- DC drives and stepper motor controls

Weblinks

[pdf datasheet](#), [html-datasheet](#), [General Product Information](#), [Distributor-Stock-Check](#), [Detailed request for product](#), [SPICE Library](#)

Technical Data

| | |
|---------------------------|------------------------|
| Rated voltage | up to 600VDC |
| Rated Current | 0.5 - 16A @ Ta 70 °C |
| Rated inductance | 0.01 - 1 mH, Tol. ±15% |
| Power Operating Frequency | up to 1 MHz |
| Terminal Type | THT |
| Weight | 7 - 243g |
| Material: Housing | UL 94V-0 |
| Sealing Compound | UL 94V-0 |

| | |
|---------------------------|-------------------------------|
| Isolation Voltage | 2 kV eff., winding to ambient |
| Climatic Category | 40/125/21 acc. to IEC 60068-1 |
| Allowable Operation Temp. | -40 °C to 125 °C |

Approvals and Compliances

Detailed information on product approvals, code requirements, usage instructions and detailed test conditions can be looked up in [Details about Approvals](#)





Application standards

Application standards where the product can be used

| Organization | Design | Standard | Description |
|---|--------------------------------|--------------|---|
|  | Designed for applications acc. | IEC/UL 60950 | IEC 60950-1 includes the basic requirements for the safety of information technology equipment. |

Compliances

The product complies with following Guide Lines

| Identification | Details | Initiator | Description |
|---|--|-------------|---|
|  | CE declaration of conformity | SCHURTER AG | The CE marking declares that the product complies with the applicable requirements laid down in the harmonisation of Community legislation on its affixing in accordance with EU Regulation 765/2008. |
|  | RoHS | SCHURTER AG | EU Directive RoHS 2011/65/EU |
|  | China RoHS | SCHURTER AG | The law SJ / T 11363-2006 (China RoHS) has been in force since 1 March 2007. It is similar to the EU directive RoHS. |
|  | REACH | SCHURTER AG | On 1 June 2007, Regulation (EC) No 1907/2006 on the Registration, Evaluation, Authorization and Restriction of Chemicals 1 (abbreviated as "REACH") entered into force. |

Dimension [mm]

Case 20

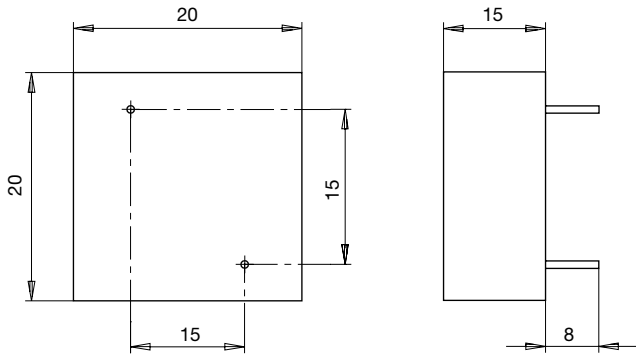

Case 25

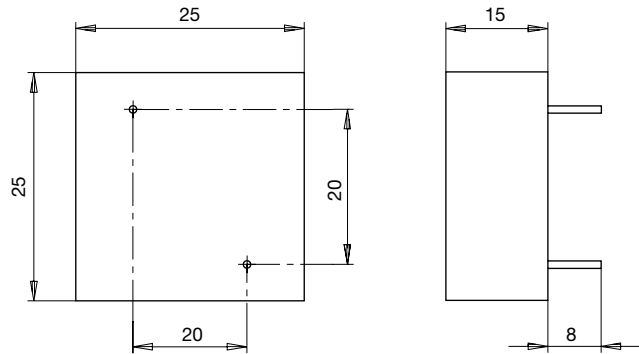

Case 30

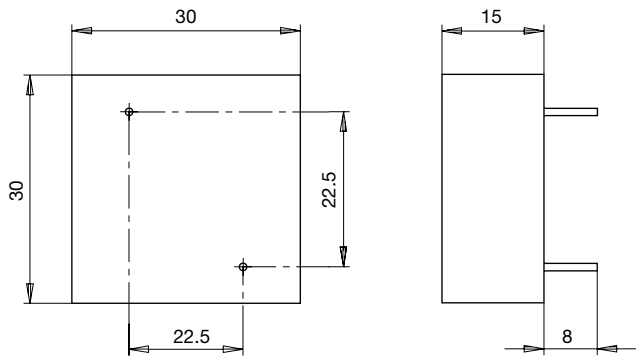

Case 40

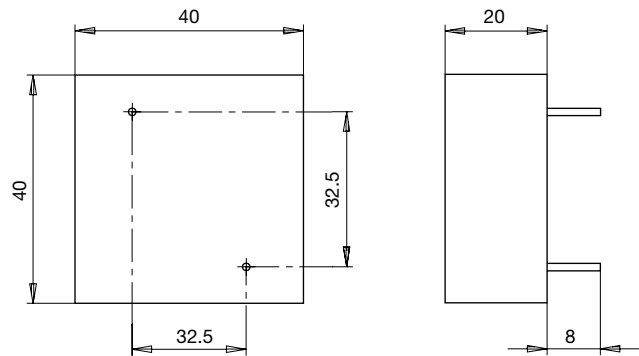

Case 48

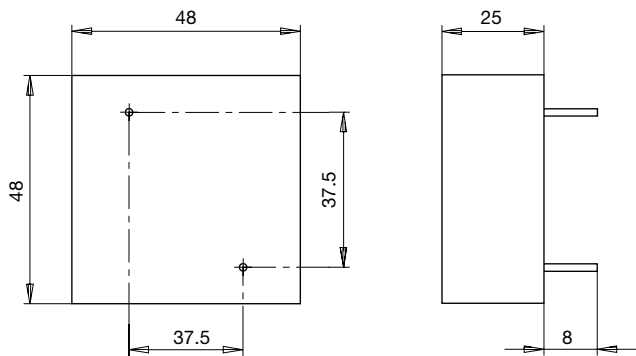

Case 175

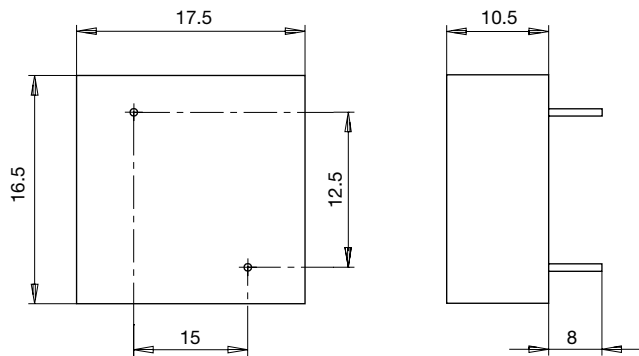

Diagrams

Switch-mode

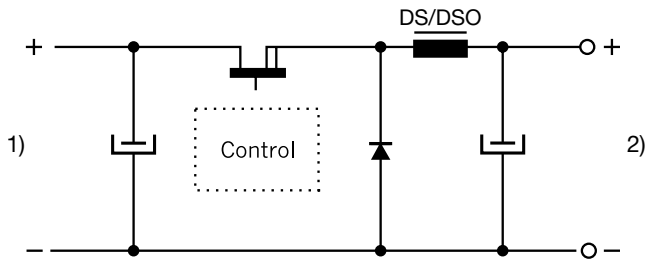

- 1) Input
- 2) DC output regulated

All Variants

| I_n [A] | L_n [mH] | R_{cu} [mΩ] | f_{RES} [MHz] | Conne- tion pins ø | Weight [g] | Housings | Packing unit [pcs.] | Order Number |
|-----------|------------|---------------|-----------------|-----------------------|------------|----------|---------------------|--------------|
| 0.5 | 0.8 | 700 | 2 | 0.5 | 7g | 175 | 100 | DS1-175-0001 |
| 0.63 | 0.5 | 500 | 2.5 | 0.5 | 7g | 175 | 100 | DS1-175-0002 |
| 1 | 0.2 | 180 | 5 | 0.5 | 7g | 175 | 100 | DS1-175-0003 |
| 1.4 | 0.1 | 80 | 6.5 | 0.5 | 7g | 175 | 100 | DS1-175-0004 |
| 3 | 0.035 | 26 | 11 | 0.5 | 7g | 175 | 100 | DS1-175-0005 |
| 0.63 | 1 | 700 | 1.2 | 0.5 | 14g | 20 | 75 | DS1-20-0001 |
| 1.4 | 0.2 | 175 | 4 | 0.5 | 14g | 20 | 75 | DS1-20-0002 |
| 3.15 | 0.04 | 26 | 10 | 0.7 | 14g | 20 | 75 | DS1-20-0003 |
| 6.3 | 0.01 | 8 | - | 0.7 | 14g | 20 | 75 | DS1-20-0004 |
| 1.4 | 0.5 | 200 | 1 | 1 | 23g | 25 | 50 | DS1-25-0001 |
| 2 | 0.2 | 100 | 3.5 | 1 | 23g | 25 | 50 | DS1-25-0002 |
| 3.15 | 0.1 | 40 | 5.7 | 1 | 23g | 25 | 50 | DS1-25-0003 |
| 7 | 0.02 | 10 | - | 1 | 23g | 25 | 50 | DS1-25-0004 |
| 1.6 | 0.5 | 200 | - | 1 | 34g | 30 | 30 | DS1-30-0001 |
| 2 | 0.3 | 140 | - | 1 | 34g | 30 | 30 | DS1-30-0002 |
| 3.15 | 0.15 | 55 | 4.5 | 1 | 34g | 30 | 30 | DS1-30-0003 |
| 4 | 0.1 | 36 | 6 | 1 | 34g | 30 | 30 | DS1-30-0004 |
| 2 | 1 | 190 | - | 1.5 | 84g | 40 | 35 | DS1-40-0001 |
| 3.15 | 0.5 | 90 | - | 1.5 | 85g | 40 | 35 | DS1-40-0002 |
| 4 | 0.2 | 55 | 3 | 1.5 | 84g | 40 | 35 | DS1-40-0003 |
| 6 | 0.1 | 26 | 4.5 | 1.5 | 84g | 40 | 35 | DS1-40-0004 |
| 3.15 | 1 | 160 | 1 | 1.5 | 243g | 48 | 20 | DS1-48-0001 |
| 4 | 0.5 | 80 | 1.5 | 1.5 | 243g | 48 | 20 | DS1-48-0002 |
| 5 | 0.3 | 75 | - | 1.5 | 243g | 48 | 20 | DS1-48-0003 |
| 9 | 0.1 | 20 | - | 1.5 | 243g | 48 | 20 | DS1-48-0004 |
| 15 | 0.035 | 7 | - | 1.5 | 243g | 48 | 20 | DS1-48-0005 |
| 16 | 0.16 | 12 | - | 1.5 | 243g | 48 | 10 | DS1-48-0006 |

Most Popular.

Availability for all products can be searched real-time: <https://www.schurter.com/en/Stock-Check/Stock-Check-SCHURTER>