

"Stay Connected" with



HEYware Products

a PennEngineering® Company



## HEYClip™ Nylon Push Screws

- Installs like a traditional nylon push rivet but removable/reusable
- Remove by unscrewing like a traditional threaded fastener
- Saves time by installing with finger-tip pressure
- Low insertion force but high extraction force

Threaded Mounting Hole	PART NO.		DESCRIPTION	PART DIMENSIONS									
	Natural	Black		A Head Height		B Overall Length		C Head Diameter		Push In Force Max.		Pull Out Force Min.	
				in.	mm.	in.	mm.	in.	mm.	LB	N	LB	N
M3	11500	11500B	PS-M3X0.5X8.5MM	.10	2,5	.33	8,5	.22	5,5	7	30	11	50
M4	11501	11501B	PS-M4X0.5X9.5MM	.12	3,0	.37	9,5	.29	7,3	8	35	20	90
M5	11502	11502B	PS-M5X0.5X12.5MM	.14	3,5	.49	12,5	.33	8,5	8	35	22	100
M6	11503	11503B	PS-M6X0.5X15.0MM	.18	4,5	.59	15,0	.39	10,0	8	35	27	120
M8	11504	11504B	PS-M8X0.5X18.0MM	.22	5,5	.71	18,0	.51	13,0	9	40	31	140

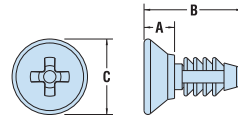

## HEYClip™ Nylon Push Screws – HPLP Series

Style	Threaded Hole Type		Clearance Hole ±.015 (0,4mm)		Min Panel Thickness E		Max Panel Thickness F		PART NO.		DESCRIPTION	PART DIMENSIONS									
	Imperial	Metric	in.	mm.	in.	mm.	in.	mm.	Natural	Black		A Head Height		B Overall Length		C Head Diameter		Push In Force Max.		Pull Out Force Min.	
												in.	mm.	in.	mm.	in.	mm.	lbf	N	lbf	N
1	#4	M3	.083	2,1	.14	3,6	.24	6,0	15500	15500B	.07	1,7	.32	8,0	.22	5,5	6,7	30	11,2	50	
					.19	4,8	.32	8,0	15502	15502B											
					.23	5,8	.39	10,0	15504	15504B											
					.23	5,8	.39	10,0	15504	15504B											
					.38	9,7	.47	12,0	15506	15506B											
	#8	M4	.125	3,2	.20	5,1	.30	7,7	15508	15508B	.11	2,7	.39	10,0	.33	8,4	7,9	35	20,2	90	
					.26	6,6	.38	9,7	15510	15510B											
					.31	7,9	.46	11,7	15512	15512B											
					.41	10,4	.54	13,7	15514	15514B											
					.53	13,5	.70	17,7	15516	15516B											
	#10	M5	.161	4,1	.23	5,8	.33	8,4	15518	15518B	.11	2,7	.47	12,0	.37	9,3	7,9	35	22,5	100	
					.29	7,4	.41	10,4	15520	15520B											
					.35	8,9	.49	12,4	15522	15522B											
					.43	10,9	.65	16,4	15524	15524B											
					.43	10,9	.65	16,4	15524	15524B											
	1/4-20	M6	.201	5,1	.24	6,1	.37	9,4	15526	15526B	.13	3,3	.55	14,0	.44	11,3	7,9	35	27,0	120	
					.30	7,6	.45	11,4	15528	15528B											
					.44	11,2	.61	15,4	15530	15530B											
					.57	14,5	.80	20,4	15532	15532B											
					.57	14,5	.80	20,4	15532	15532B											
	5/16-18	M8	.250	6,4	.43	10,9	.57	14,5	15534	15534B	.19	4,7	.79	20,0	.62	15,8	12,4	55	40,5	180	
					.58	14,7	.77	19,5	15536	15536B											
					.73	18,5	.96	24,5	15538	15538B											
					.88	22,4	1.16	29,5	15540	15540B											
.88					22,4	1.16	29,5	15540	15540B												

- Can be used in a Clearance hole or a threaded hole (see chart). Removable when used in a threaded hole.
- Product line offers a wide range of assembled panel thicknesses from .03" to 1.16" and hole sizes from .083" to .250" Dia.

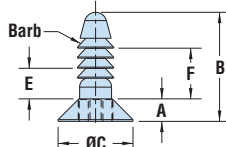

Style 1

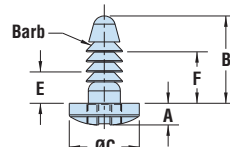

Style 2

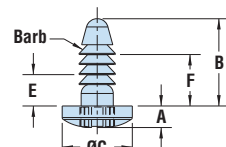

Style 3

Quick Specs

Material Nylon 6/6  
 Flammability Rating 94V-2  
 Temperature Range 40°F (-40°C) to 185°F (85°C)

“Stay Connected” with



HEYware Products

a PennEngineering® Company

## HEYClip™ Nylon Push Screws – HPLP Series (continued)

Style	Threaded Hole Type		Clearance Hole ±.015 (0,4mm)		Min Panel Thickness E		Max Panel Thickness F		PART NO.		DESCRIPTION	PART DIMENSIONS																				
									Natural	Black		A Head Height		B Overall Length		C Head Diameter		Push In Force Max.		Pull Out Force Min.												
	Imperial	Metric	in.	mm.	in.	mm.	in.	mm.				in.	mm.	in.	mm.	in.	mm.	lbf	N	lbf	N											
2	#4	M3	.083	2,1	.03	0,7	.16	4,0	<b>15542</b>	<b>15542B</b>	HPLPB 083-024	.09	2,4	.24	6,0	.22	5,6	6.7	30	11.2	50											
					.12	3,0	.24	6,0	<b>15544</b>	<b>15544B</b>	HPLPB 083-032			.32	8,0																	
					.18	4,6	.32	8,0	<b>15546</b>	<b>15546B</b>	HPLPB 083-039			.39	10,0																	
					.26	6,7	.39	10,0	<b>15548</b>	<b>15548B</b>	HPLPB 083-047			.47	12,0																	
	#8	M4	.125	3,2	.10	2,6	.22	5,7	<b>15550</b>	<b>15550B</b>	HPLPB 125-032	.12	3,1	.32	8,0	.32	8,0	9	40	27.0	120											
					.04	1,1	.24	6,2	<b>15552</b>	<b>15552B</b>	HPLPB 125-033			.33	8,5																	
					.15	3,7	.30	7,7	<b>15554</b>	<b>15554B</b>	HPLPB 125-039			.39	10,0																	
					.18	4,6	.38	9,7	<b>15556</b>	<b>15556B</b>	HPLPB 125-047			.47	12,0																	
					.25	6,4	.46	11,7	<b>15558</b>	<b>15558B</b>	HPLPB 125-055			.55	14,0																	
					.32	8,1	.54	13,7	<b>15560</b>	<b>15560B</b>	HPLPB 125-063			.63	16,0																	
	#10	M5	.161	4,1	.08	2,0	.21	5,4	<b>15562</b>	<b>15562B</b>	HPLPB 161-035	.15	3,7	.35	9,0	.37	9,5	10.1	45	33.7	150											
					.14	3,6	.25	6,4	<b>15564</b>	<b>15564B</b>	HPLPB 161-039			.39	10,0																	
					.12	3,0	.33	8,4	<b>15566</b>	<b>15566B</b>	HPLPB 161-047			.47	12,0																	
					.24	6,1	.45	11,4	<b>15568</b>	<b>15568B</b>	HPLPB 161-059			.59	15,0																	
					.28	7,1	.49	12,4	<b>15570</b>	<b>15570B</b>	HPLPB 161-063			.63	16,0																	
					.36	9,1	.57	14,4	<b>15572</b>	<b>15572B</b>	HPLPB 161-071			.71	18,0																	
					.38	9,7	.65	16,4	<b>15574</b>	<b>15574B</b>	HPLPB 161-079			.79	20,0																	
					1/4-20	M6	.201	5,1	.10	2,6	.21			5,4	<b>15576</b>							<b>15576B</b>	HPLPB 201-039	.18	4,6	.39	10,0	.47	12,0	10.1	45	38.2
	.17	4,3	.29	7,4					<b>15578</b>	<b>15578B</b>	HPLPB 201-047	.47	12,0																			
	.12	3,0	.35	8,9					<b>15580</b>	<b>15580B</b>	HPLPB 201-053	.53	13,5																			
	.18	4,6	.41	10,4					<b>15582</b>	<b>15582B</b>	HPLPB 201-059	.59	15,0																			
	.16	4,1	.45	11,4					<b>15584</b>	<b>15584B</b>	HPLPB 201-063	.63	16,0																			
	.29	7,4	.53	13,4					<b>15586</b>	<b>15586B</b>	HPLPB 201-071	.71	18,0																			
	.38	9,7	.61	15,4					<b>15588</b>	<b>15588B</b>	HPLPB 201-079	.79	20,0																			
.53	13,5	.80	20,4	<b>15590</b>					<b>15590B</b>	HPLPB 201-098	.98	25,0																				
5/16-18	M8	.250	6,4	.07					1,8	.26	6,5	<b>15592</b>	<b>15592B</b>	HPLPB 250-047	.24	6,0	.47	12,0	.63	16,0	12.4	55	40.5			180						
				.14					3,5	.41	10,5	<b>15594</b>	<b>15594B</b>	HPLPB 250-063			.63	16,0														
				.21	5,3	.49	12,5	<b>15596</b>	<b>15596B</b>	HPLPB 250-071	.71	18,0																				
				.32	8,0	.57	14,5	<b>15598</b>	<b>15598B</b>	HPLPB 250-079	.79	20,0																				
				.51	13,0	.77	19,5	<b>15600</b>	<b>15600B</b>	HPLPB 250-098	.98	25,0																				
				.70	17,7	.96	24,5	<b>15602</b>	<b>15602B</b>	HPLPB 250-118	1.18	30,0																				
				.90	22,9	1.16	29,5	<b>15604</b>	<b>15604B</b>	HPLPB 250-138	1.38	35,0																				
				3	#4	M3	.083	2,1	.03	0,7	.16	4,0	<b>15606</b>	<b>15606B</b>			HPLPC 083-024	.09						2,4	.24		6,0	.22	5,6	6.7	30	11.2
.12	3,0	.24	6,0						<b>15608</b>	<b>15608B</b>	HPLPC 083-032	.32	8,0																			
.18	4,6	.32	8,0						<b>15610</b>	<b>15610B</b>	HPLPC 083-039	.39	10,0																			
.26	6,7	.39	10,0						<b>15612</b>	<b>15612B</b>	HPLPC 083-047	.47	12,0																			
#8	M4	.125	3,2		.10	2,6	.22	5,7	<b>15614</b>	<b>15614B</b>	HPLPC 125-032	.12	3,1	.32	8,0	.32	8,0	9	40	27.0	120											
					.04	1,1	.24	6,2	<b>15616</b>	<b>15616B</b>	HPLPC 125-033			.33	8,5																	
					.15	3,7	.30	7,7	<b>15618</b>	<b>15618B</b>	HPLPC 125-039			.39	10,0																	
					.18	4,6	.38	9,7	<b>15620</b>	<b>15620B</b>	HPLPC 125-047			.47	12,0																	
					.25	6,4	.46	11,7	<b>15622</b>	<b>15622B</b>	HPLPC 125-055			.55	14,0																	
					.32	8,1	.54	13,7	<b>15624</b>	<b>15624B</b>	HPLPC 125-063			.63	16,0																	
#10	M5	.161	4,1		.08	2,0	.21	5,4	<b>15626</b>	<b>15626B</b>	HPLPC 161-035	.15	3,7	.35	9,0	.37	9,5	10.1	45	33.7	150											
					.14	3,6	.25	6,4	<b>15628</b>	<b>15628B</b>	HPLPC 161-039			.39	10,0																	
					.12	3,0	.33	8,4	<b>15630</b>	<b>15630B</b>	HPLPC 161-047			.47	12,0																	
					.24	6,1	.45	11,4	<b>15632</b>	<b>15632B</b>	HPLPC 161-059			.59	15,0																	
					.28	7,1	.49	12,4	<b>15634</b>	<b>15634B</b>	HPLPC 161-063			.63	16,0																	
					.36	9,1	.57	14,4	<b>15636</b>	<b>15636B</b>	HPLPC 161-071			.71	18,0																	
					.38	9,7	.65	16,4	<b>15638</b>	<b>15638B</b>	HPLPC 161-079			.79	20,0																	
					1/4-20	M6	.201	5,1	.10	2,6	.21			5,4	<b>15640</b>							<b>15640B</b>	HPLPC 201-039	.18	4,6	.39	10,0	.47	12,0	10.1	45	38.2
.17	4,3	.29	7,4						<b>15642</b>	<b>15642B</b>	HPLPC 201-047	.47	12,0																			
.12	3,0	.35	8,9						<b>15644</b>	<b>15644B</b>	HPLPC 201-053	.53	13,5																			
.18	4,6	.41	10,4						<b>15646</b>	<b>15646B</b>	HPLPC 201-059	.59	15,0																			
.16	4,1	.45	11,4						<b>15648</b>	<b>15648B</b>	HPLPC 201-063	.63	16,0																			
.29	7,4	.53	13,4						<b>15650</b>	<b>15650B</b>	HPLPC 201-071	.71	18,0																			
.38	9,7	.61	15,4						<b>15652</b>	<b>15652B</b>	HPLPC 201-079	.79	20,0																			
.53	13,5	.80	20,4	<b>15654</b>					<b>15654B</b>	HPLPC 201-098	.98	25,0																				
5/16-18	M8	.250	6,4	.07					1,8	.26	6,5	<b>15656</b>	<b>15656B</b>	HPLPC 250-047	.24	6,0	.47	12,0	.63	16,0	12.4	55	40.5			180						
				.14					3,5	.41	10,5	<b>15658</b>	<b>15658B</b>	HPLPC 250-063			.63	16,0														
				.21	5,3	.49	12,5	<b>15660</b>	<b>15660B</b>	HPLPC 250-071	.71	18,0																				
				.32	8,0	.57	14,5	<b>15662</b>	<b>15662B</b>	HPLPC 250-079	.79	20,0																				
				.51	13,0	.77	19,5	<b>15664</b>	<b>15664B</b>	HPLPC 250-098	.98	25,0																				
				.70	17,7	.96	24,5	<b>15666</b>	<b>15666B</b>	HPLPC 250-118	1.18	30,0																				
				.90	22,9	1.16	29,5	<b>15668</b>	<b>15668B</b>	HPLPC 250-138	1.38	35,0																				