

# molex® RJ-45 Field Wireable Ethernet Connectors

## Features and Benefits

- Meets Open DeviceNet Vendors' Association and ControlNet Vendors' Association IP Specifications
- IP 67 NEMA 6P Rating
- One piece molded plug is more robust than competition
- One Sealing Surface means less likelihood of failure
- Easy termination allows custom length cable to be made in field



## Specifications

### Reference Information:

Packaging: Bag  
 Minimum Order Qty.: 5  
 Standard Pack Size: 1

### Environmental:

Temperature Rating: -40 to +85°C  
 Waterproof: Meets requirements of NEMA 6P and IP67 for water tightness  
 UL RTI Electrical: 130°C at 0.03"  
 UL RTI Mechanical Without Impact: 140°C at 0.03"

### Electrical:

Type: Category 5E  
 Transmission Performance: Category 5  
 RJ-45 Connection Interface: TIA/EIA-568-B  
 Voltage: 150V  
 Current Rating: 1.5A  
 Shielding Effectiveness: 20dB min.  
 Contact Resistance: 20 milliohms max.  
 Insulation Resistance: 500 Megohms min.

### Mechanical:

Durability: 500 cycles min.

### Physical:

Tether-Dust Cap: PP or PA  
 Nut-Jam/Lock: Zinc/Steel  
 Gaskets: Panel – Neoprene  
 O-ring – Nitrile  
 Assemblies: Strain Relief/Cable Seal – PA, TPE Gland  
 Plug Holde, Receptacle, Dust Cap, Locking Ring  
 Wedge – PBTP  
 Screw-Dust Cap: Zinc/Steel

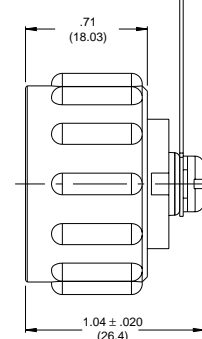
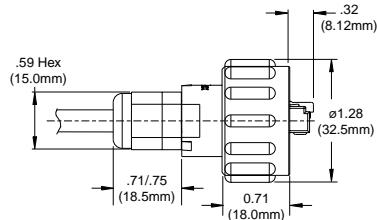
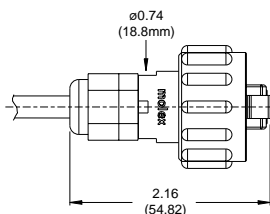
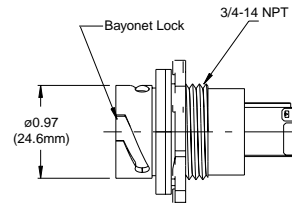
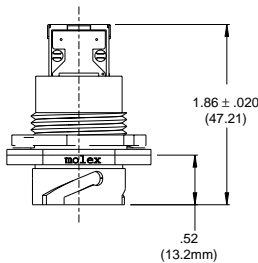
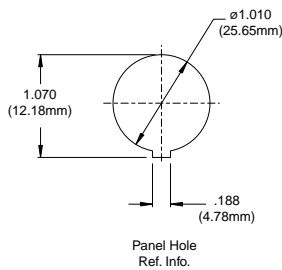

### Features and Benefits

#### 84700-0001 Field attachable plug

- Robust bayonet style lock
- Only one sealing surface provides a low likelihood of failure
- Superior strain relief
- Meets NEMA 6P and IP 67 rating
- Easy plug termination

#### 84700-0002 Receptacle

- Simple error free mating
- Keyed receptacle housing allows easy damage-free mating

#### 84700-0003 Receptacle

- Same design as plug maintains all of its features

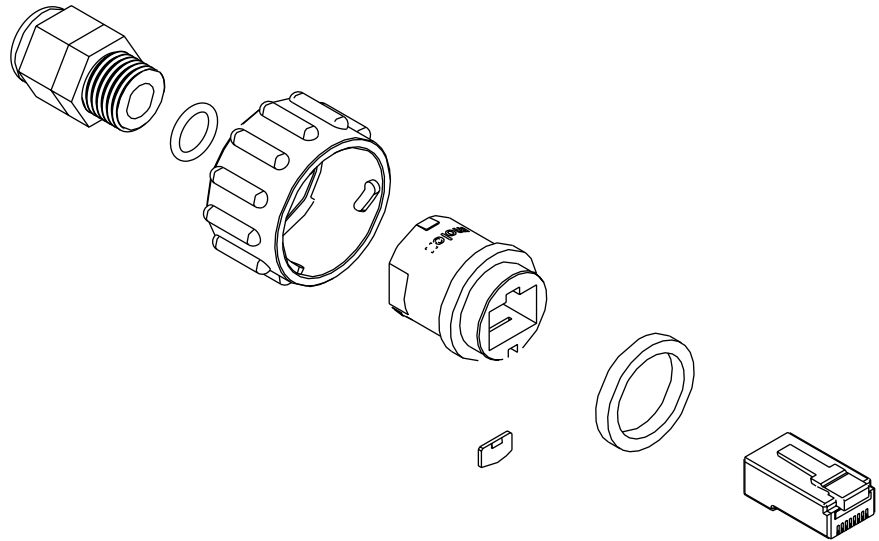

### ORDERING INFORMATION

Order No.	Description
84700-0001	Receptacle
84700-0002	Field Wireable Plug
84700-0003	Dust Cap

### APPLICATIONS

- Industrial Environment
  - Food and Beverage
  - Automotive
  - Chemical
  - Other continuous and batch processes
- Water Treatment plants
  - Waste water
  - Municipal drinking water
- Transportation Hubs
  - Airports
  - Bus Stations
  - Rail Stations

#### Industrial Headquarters

4650 62nd Ave. N.  
Pinellas Park, FL 33781  
727-521-2700  
amerinfo@molex.com

#### Far East North Headquarters

Yamato, Kanagawa, Japan  
81-462-65-2324  
feninfo@molex.com

#### Far East South Headquarters

Jurong, Singapore  
65-6-268-6868  
fesinfo@molex.com

#### European Headquarters

Munich, Germany  
49-89-413092-0  
eurinfo@molex.com

#### Corporate Headquarters

2222 Wellington Ct.  
Lisle, IL 60532 U.S.A.  
630-969-4550  
Fax:630-969-1352

Visit our Web site at <http://www.molex.com>