

DWG. NO.		201-910-1160J	
REV	DESCRIPTION	DATE	APPD
D	ECR 7281	2/25/02	[Signature]

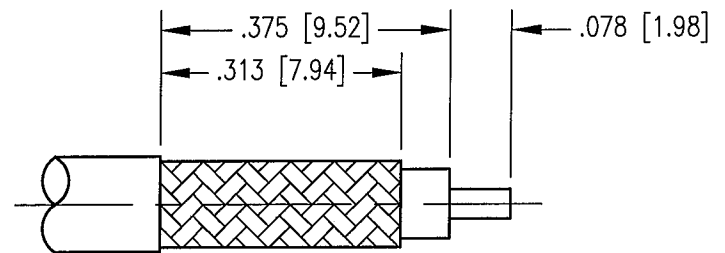
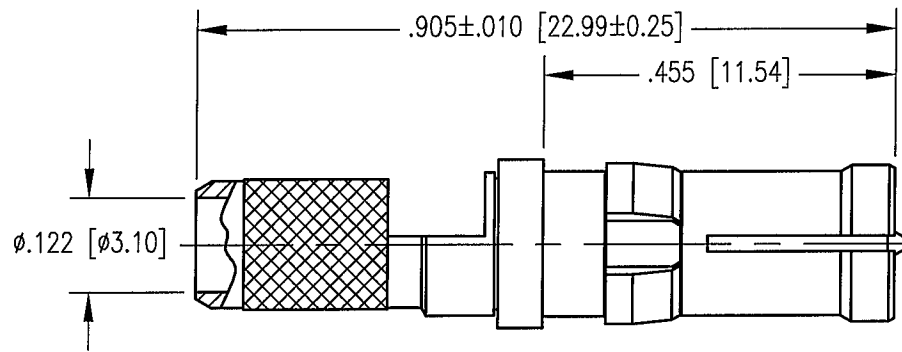
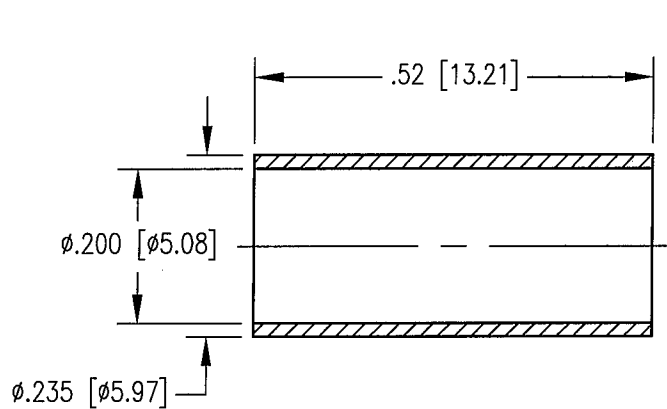

CABLE TRIMMING DIMENSIONS

NOTES:

- MATERIALS:
 FRONT BODY: BERYLLIUM COPPER PER ASTM B196
 CLIP RING: BERYLLIUM COPPER PER ASTM B194
 FERRULE: COPPER ALLOY
 ALL OTHER METAL PARTS: BRASS PER ASTM B16
 INSULATOR: TEFLON PER ASTM D1710
- FINISH:
 BODY AND CENTER CONTACT: .000015 MIN. GOLD PER MIL-G-45204 OVER
 .000100 MIN. COPPER PER MIL-C-14550
 FERRULE: .000100 MIN. BRIGHT TIN PER MIL-T-10727 OVER
 COPPER FLASH
 CLIP RING: UNPLATED
- ELECTRICAL:
 IMPEDANCE: 50 OHMS NOMINAL
 FREQUENCY RANGE: 0 - 900 MHz
- DESIGNED FOR USE WITH RG-58 CABLE OR EQUIVALENT.
- FOR CABLING PROCEDURES USE CAP 9-01 WITH TRIMMING DIMENSIONS SHOWN.
- CRIMP FERRULE USING .213 HEX DIE.

PER ASME Y14.5M-1994 UNLESS OTHERWISE SPECIFIED: DIMENSIONS ARE IN INCHES [MM]				NORTHROP GRUMMAN			
TOLERANCES: DECIMALS .XX ± .01 [0.254] .XXX ± .005 [0.127] ANGLES ± 2° SCALE: 4:1				Winchester Electronics 400 Park Road Watertown, CT 06795			
CUSTOMER DRAWING			TITLE			RDM STRAIGHT RECEPTACLE	
DRAWN MJF	DATE 2/18/02	CHECKED KJT	DATE 2/19/02	A		201-910-1160J	
APPROVED JEM	DATE 2/19/02	APPROVED JED	DATE 2/19/02	SHT.	OF	REV.	
				1	1	D	