

# HSF

NOTES:  
 Current Rating:1A AMP  
 Contact Resistance:30milliohm Max  
 Withstand Voltage:250V AC/DC  
 Insulation Resistance:1000Megohm Min  
 Operation Temperature:-40°C to +105°C

Housing Material:PA9T+30%GF(UL94V-0)  
 Contact Material:Copper alloy  
 Contact plating:Au or Sn over Ni Plating

## Ordering Information

3135-XX R XX B K00 X 1

No. of Pins	Contact Plating	Color Insulator	Packing
4 8	G0=Gold Flash	B=Black	A=Type
6 34	G3=10u"Gold	U=Blue	T=Tube
10 40	G4=15u"Gold	W=White	
14 44	G5=30u"Gold		
16 50	S0=Gold Flash/Tin		
20 60	S3=10u"Gold/Tin		
24 64	S4=15u"Gold/Tin		
26 80	S5=30u"Gold/Tin		
30 100	SN=Tin		
32			

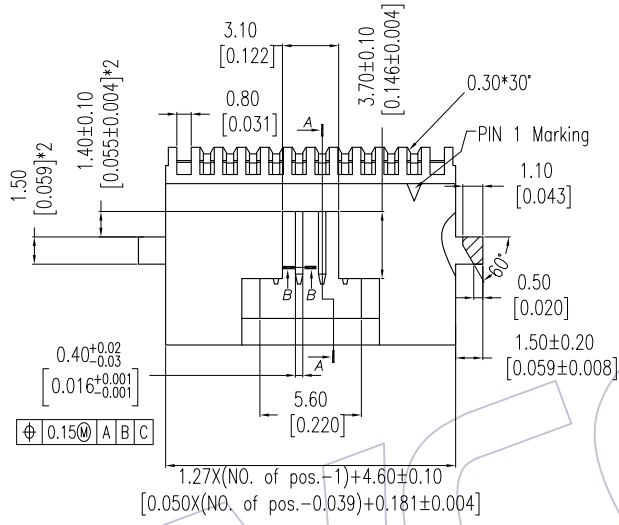

Recommended P.C.B Layout (Top Side)  
 (PCB BOARD TOLERANCE ± 0.05)

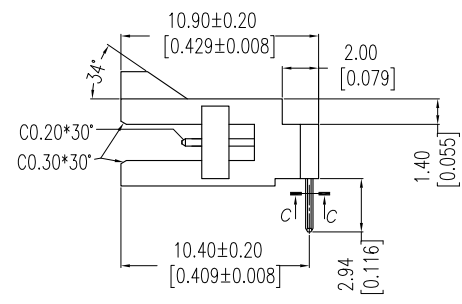
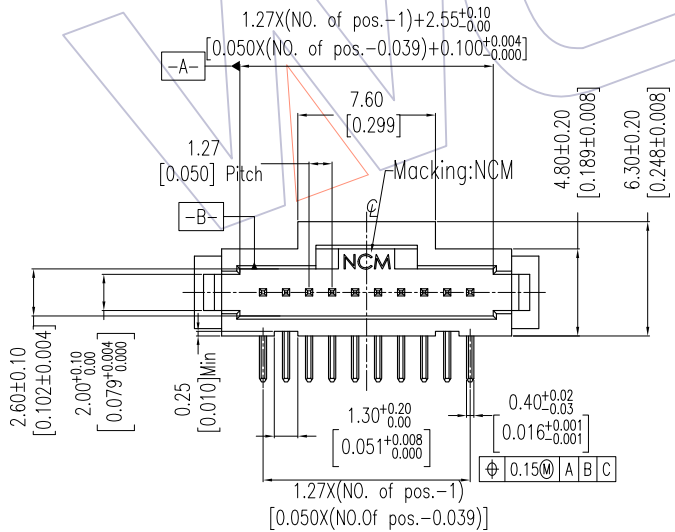
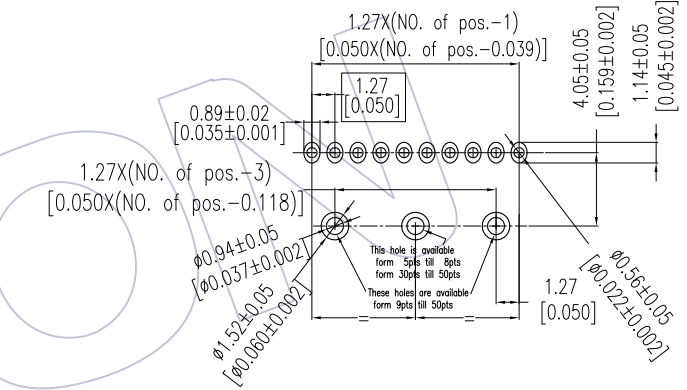

REV	DATE	MODIFICATION DESCRIPTION	CHANGE	OPERATION	DRAW	DATE	SCALE	FIT	PART NO.
A2	2015/01/20	MODIFY	△	X.X ±0.40	Allen	2015/01/20	UNIT	mm	3135-XXRXXBK00X1
A1	2012/07/16	MODIFY	△	X.XX ±0.25	CHECK	DATE	inch	TITLE:	
A0	2011/11/18	NEW	—	X.XXX ±0.15	APPROVE	DATE	SIZE	A4	1.27mm Box 90° DIP (Without fixing)
				Angle ± 3°			SHEET	1/2	Customer NO.
				DIM TOL			PROJ.	⊕	K4021

**WCON**  
 Http: www.wcon.com

WCON-Dongguan Tel: +86 769 85358920  
 WCON-Kunshan Tel: +86 512 57468408  
 Fax: +86 769 85358915  
 Fax: +86 512 57468468  
 E-mail: sales@wcon.com  
 E-mail: salesks@wcon.com

# HSF

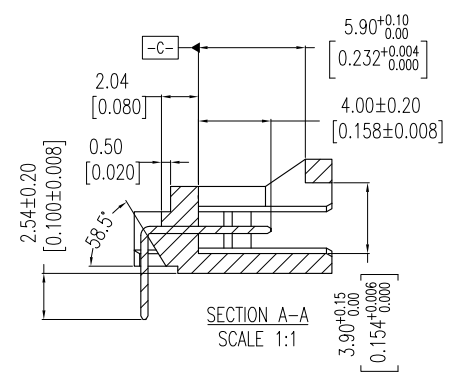
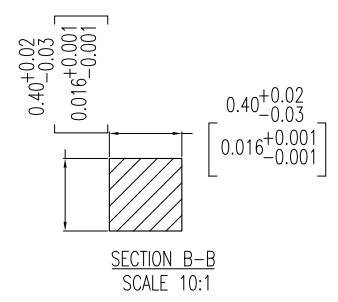
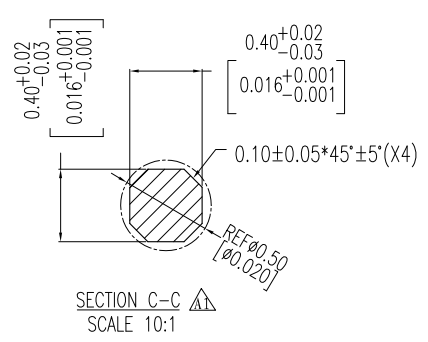
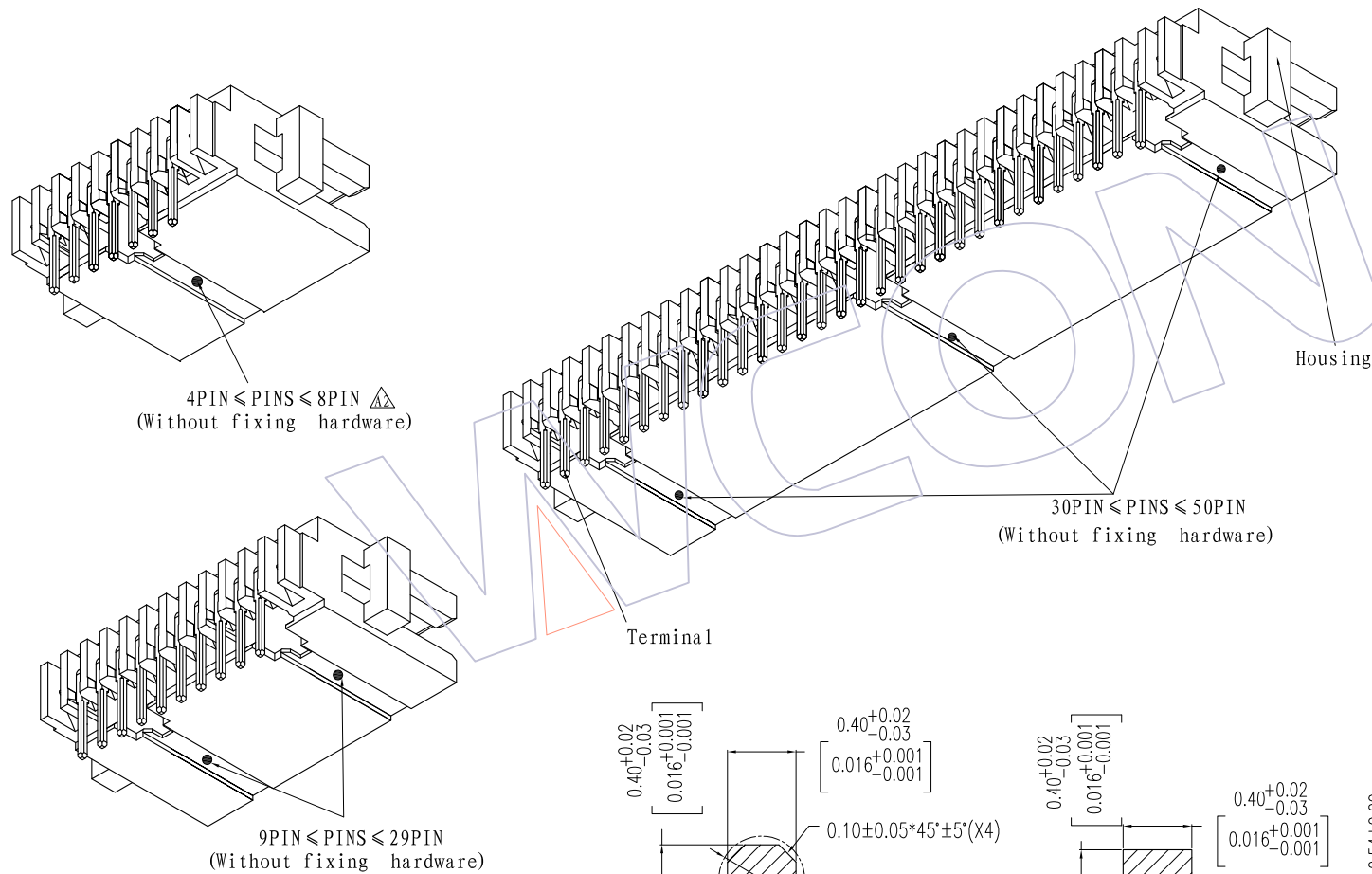

REV	DATE	MODIFICATION DESCRIPTION	CHANGE	OPERATION	DRAW	DATE	SCALE	FIT	PART NO.
A2	2015/01/20	MODIFY	△	X.X ±0.40	Allen	2015/01/20	UNIT	mm	3135-XXRXXBK00X1
A1	2012/07/16	MODIFY	△	X.XX ±0.25	CHECK	DATE	inch	TITLE:	
A0	2011/11/18	NEW	—	X.XXX ±0.15	APPROVE	DATE	SHEET	A4	1.27mm Box 90° DIP (Without fixing)
				Angle ± 3'			2/2		Customer NO. K4021
				DIM TOL			PROJ.		



Http: www.wcon.com

WCON-Dongguan Tel: +86 769 85358920 Fax: +86 769 85358915 E-mail: sales@wcon.com	WCON-Kunshan Tel: +86 512 57468408 Fax: +86 512 57468468 E-mail: salesks@wcon.com
-------------------------------------------------------------------------------------------	--------------------------------------------------------------------------------------------