

Rev	AWO #	Description	Date	Appr
-		RELEASED	11/23/10	

APPROVED: _____
 DATE: _____ TITLE: _____

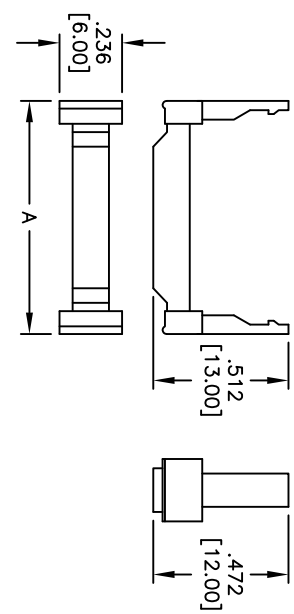
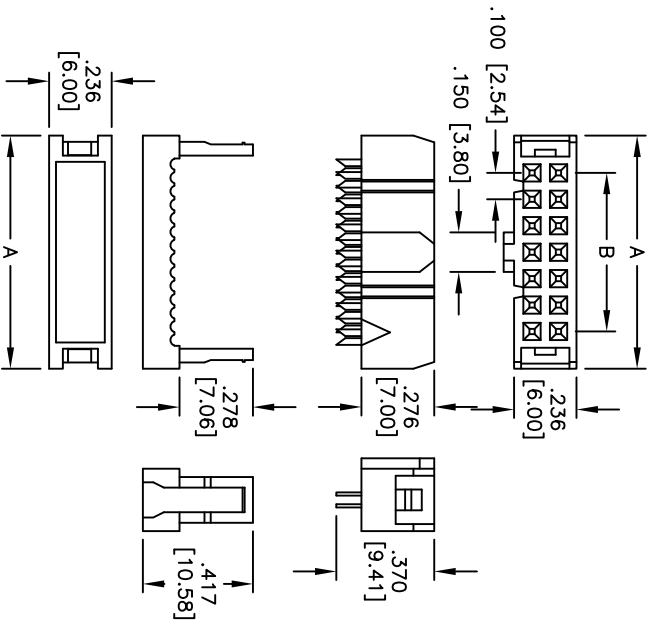

Positions	A
6	.479 [12.16]
8	.580 [14.74]
10	.680 [17.27]
12	.781 [19.85]
14	.882 [22.40]
16	.982 [24.94]
18	1.081 [27.46]
20	1.181 [30.00]
24	1.382 [35.10]
26	1.480 [37.59]
30	1.680 [42.66]
34	1.882 [47.80]
36	1.980 [50.29]
40	2.180 [55.37]
44	2.384 [60.56]
50	2.684 [68.18]
56	2.982 [75.74]
60	3.181 [80.80]
62	3.281 [83.35]
64	3.382 [85.90]

Positions: 6 thru 16, 20, 24, 26, 30, 34, 36, 40, 44, 50, 56, 60, 62, & 64
 B = .100 [2.54] x No. of Spaces per Row

SPECIFICATIONS:

Material: Insulator: PBT, glass reinforced, rated UL 94V-0
 Insulator color: Gray
 Contacts: Copper alloy
Plating: Gold flash over Nickel on contact area, Tin over Copper underplate on IDC area
Electrical: Operating voltage: 250 VAC max.
 Current rating: 1 Amp max.
 Contact resistance: 20 mohms max. initial
 Insulation resistance: 5,000 Mohms min @ 500 VDC.
 Dielectric withstanding voltage: 500 VAC for 1 minute
Temperature Rating: Operating temperature: -40°C to +105°C
Environmental: Lead free, RoHS compliant



ADAM TECH

909 Railway Avenue, Union, NJ 07083
 Phone: 908-687-5000 Fax: 908-687-5710

TITLE: .100 [2.54] FLAT CABLE IDC SOCKET
 STANDARD SINGLE WIPE CONTACTS

UNLESS OTHERWISE SPECIFIED ALL DIMENSIONS ARE INCHES [MM] TOLERANCES: EXCEPT AS NOTED		DRAWN: AY		DATE: 11/23/10	
INCHES: .10 ± .010 .020 ± .015 .015 ± .010 HOLDS: .015 ± .010 Ø: .015 ± .010 Ø: .015 ± .010 Ø: .015 ± .010		CHECKED: AW		DATE: 11/23/10	
APPROVALS:		SIZE: X		PART NO.: FCS-XX-SG-GY	
APPROVED:		REF: S0008T		SCALE: NTS	
		SHEET: 1 OF 1		REV: -	