

660-072 and 660-073 MIL-PRF-28876 Type Threaded Protective Covers

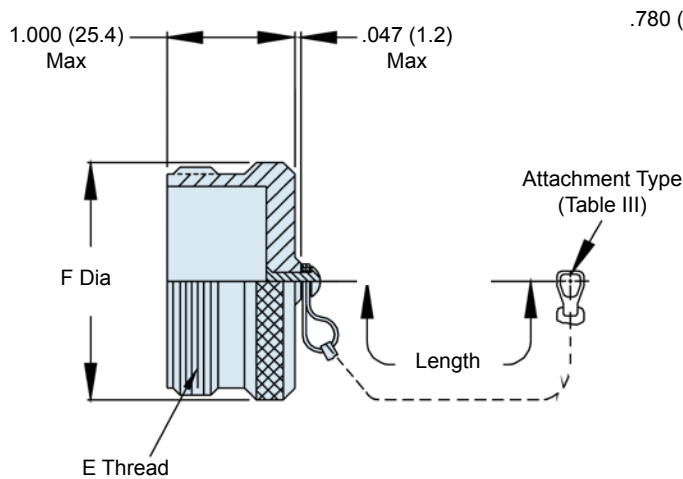

660-072 Plug Cover
MIL-PRF-28876/10 Style

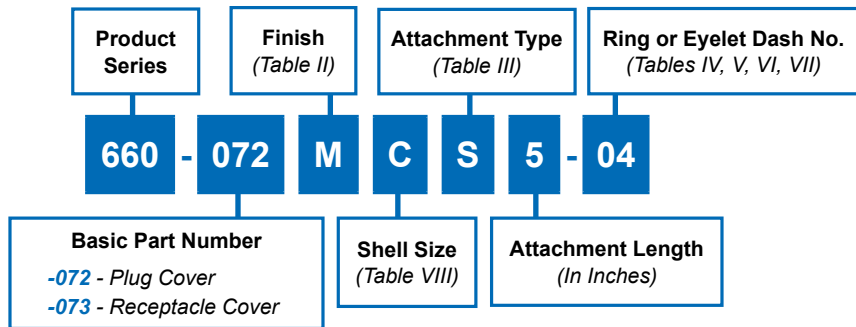
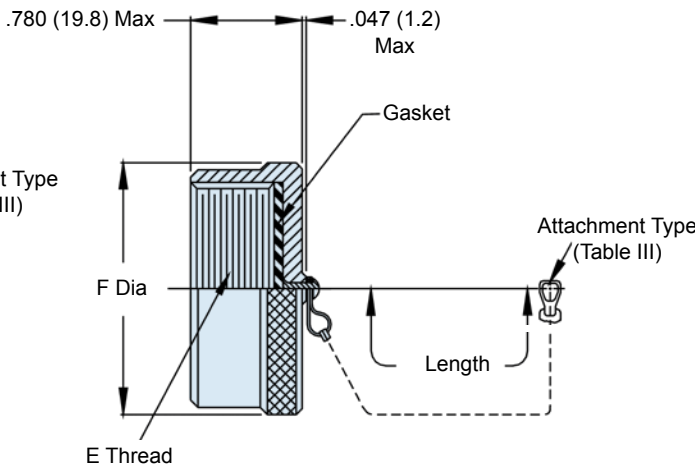

660-073 Receptacle Cover
MIL-PRF-28876/15 Style

TABLE I: CONNECTOR SHELL SIZE			
Designator	Shell Size (Ref)	A Thread	B Dia Max
A	11	.750-.1P-.2L-DS	1.028 (26.1)
B	13	.875-.1P-.2L-DS	1.141 (29.0)
C	15	1.062-.1P-.2L-DS	1.263 (32.1)
D	17	1.125-.1P-.2L-DS	1.387 (35.2)
E	19	1.312-.1P-.2L-DS	1.513 (38.4)
F	23	1.500-.1P-.2L-DS	1.703 (43.5)
G	25	1.625-.1P-.2L-DS	1.825 (46.4)
H	29	1.812-.1P-.2L-DS	2.143 (54.4)
J	33	2.000-.1P-.2L-DS	2.329 (59.2)

TABLE II: FINISH		
SYM	MATERIAL	FINISH
C	Aluminum	Black Anodize
M	Aluminum	Electroless Nickel (Coupling Nut Electrodeposited)
NF	Aluminum	Olive Drab Cadmium over Electroless Nickel
ZN	Aluminum	Zinc-Nickel/Olive Drab over Electroless Nickel
Z1	Stainless Steel	Passivate

660-072 and 660-073
MIL-PRF-28876 Typer
Threaded Protective Covers



MIL-PRF-
28876

C

ROPE
(Types F, G, H, R, T, U)

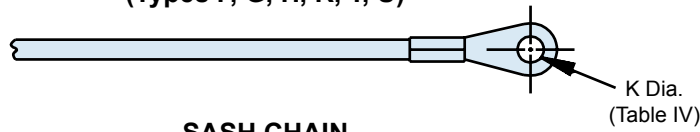

SASH CHAIN
(Type S)

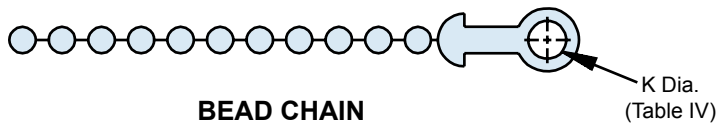
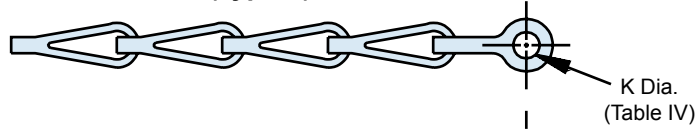

BEAD CHAIN
(Type D)

SPLIT RING - Style C

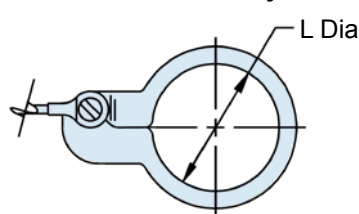

SOLID RING - Style B

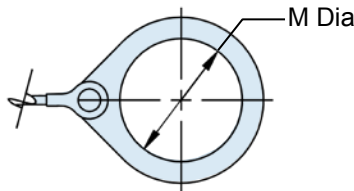

SOLID RING - Style A

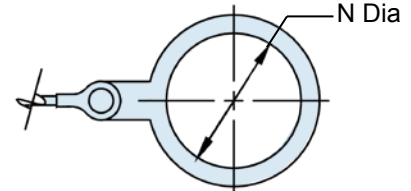

TABLE V: SPLIT RING

Dash No.	L Dia ±.015 (4.0)	Dash No.	L Dia ±.015 (4.0)
50	.425 (10.8)	74	1.625 (41.3)
52	.485 (12.3)	76	1.750 (44.5)
54	.640 (16.3)	78	1.220 (31.0)
56	.750 (19.1)	80	1.980 (50.3)
58	.890 (22.6)	82	2.060 (52.3)
60	1.015 (25.8)	84	2.235 (56.8)
62	1.095 (27.8)	86	2.310 (58.7)
64	1.130 (28.7)	88	2.475 (62.9)
66	1.250 (31.8)	90	2.655 (67.4)
68	1.350 (34.3)	92	2.810 (71.4)
70	1.390 (35.3)	94	3.045 (77.3)
72	1.485 (37.7)		

TABLE VI: SOLID RING STYLE B

Dash No.	M Dia ±.015 (4.0)	Dash No.	M Dia ±.015 (4.0)
08	.468 (11.9)	24	1.484 (37.7)
10	.593 (15.1)	25	1.577 (40.1)
12	.718 (18.2)	27	1.640 (41.7)
13	.765 (19.4)	28	1.687 (42.8)
14	.844 (21.4)	29	1.765 (44.8)
15	.890 (22.6)	30	1.890 (48.0)
16	.968 (24.6)	31	1.953 (49.6)
17	1.015 (25.8)	32	1.968 (50.0)
18	1.093 (27.8)	33	2.077 (52.8)
19	1.140 (29.0)	35	2.140 (54.4)
20	1.203 (30.6)	36	2.187 (55.5)
21	1.265 (32.1)	40	2.406 (61.1)
22	1.343 (34.1)	44	2.656 967.5)
23	1.453 (36.9)	48	3.031 (77.0)

TABLE VII: SOLID RING STYLE A

Dash No.	N Dia ±.015 (4.0)	Dash No.	N Dia ±.015 (4.0)
095	.312 (7.9)	109	1.266 (32.2)
100	.391 (9.9)	209	1.312 (33.3)
101	.516 (13.1)	110	1.391 (35.3)
102	.583 (14.8)	210	1.391 (35.3)
103	.641 (16.3)	111	1.521 (38.6)
104	.708 (18.0)	211	1.536 (39.0)
105	.766 (19.5)	112	1.641 (41.7)
205	.788 (20.0)	113	1.766 (44.9)
106	.896 (22.8)	213	1.812 (46.0)
206	.907 (23.0)	114	1.891 (48.0)
107	1.016 (25.8)	214	1.938 (49.2)
207	1.025 (26.0)	115	2.078 (52.8)
108	1.141 (29.0)	116	2.406 (61.1)
308	1.188 (30.2)	117	2.510 (63.8)
208	1.203 (30.6)		

TABLE III: ATTACHMENT TYPE	
Sym	Attachment Type
D	Bead Chain, Cres., Passivate
F	Wire Rope, Nylon Jacket
G	Nylon Rope
H	Wire Rope, Teflon Jacket
N	No Attachment
R	Wire Rope, PVC Jacket
S	#8 Sash Chain, Cres., Passivate
T	Wire Rope, No Jacket
U	Wire Rope, Polyurethane Jacket with Terminal

TABLE IV: EYELET	
Dash No.	K Dia ±.010 (3.6)
01	.140 (3.6)
02	.182 (4.6)
03	.191 (4.9)
04	.197 (5.0)
05	.167 (4.2)
06	.125 (3.2)
07	.218 (5.5)
09	.156 (4.0)
00	No Eyelet

Metric dimensions (mm) are indicated in parenthesis.