

RECOMMENDED P.C. BOARD LAYOUT

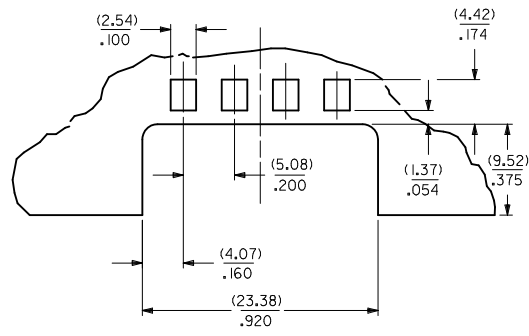
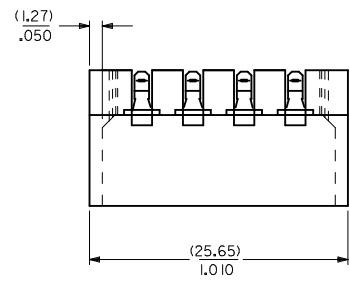

NOTES:

- MOLDED RIBS TO PROVIDE AN INTERFERENCE FIT TO A (1.62± 0.10)/ P.C. BOARD
- PLATING
POSTPLATE (0.00254)/.000100 MIN. TIN OVER
0.00127/(.000050) MIN. NICKEL OVERALL.
- PART INTENDED TO MATE WITH HOUSING 8981-4P2 AND TERMINAL 8980-3*.
- PRODUCT SPEC. PS-8981-4SM* APPLIES.
- MATERIAL:
HOUSING - NYLON 46, GLASS FILLED,
UL 94V-0, COLOR: NATURAL (OFF-WHITE)
TERMINAL - PHOSPHOR BRONZE
- PARTS TO BE PACKED IN MOISTURE BARRIER BAG.

ADD NOTE 6. EC NO: S2012-0445 DRWN:SKANG 2011/12/07 CHKD:ATSEE 2012/01/05 APPR:MLONG 2012/01/10	QUALITY SYMBOLS ▽=0 ◻=0	GENERAL TOLERANCES (UNLESS SPECIFIED) mm INCH 4 PLACES ± --- ± --- 3 PLACES ± --- ± .008 2 PLACES ± 0.20 ± --- 1 PLACE ± --- ± --- ANGULAR ± 3 °	DIMENSION STYLE MM/IN DRAWN BY: JWAN CHECKED BY: SKTOH APPROVED BY: MSIMMEL MATERIAL NO.: 15-24-4784	SCALE NTS DESIGN UNITS METRIC THIRD ANGLE PROJECTION	DATE: 1995/06/29 DATE: 1995/06/29 DATE: 1995/06/30	TITLE POWER CONNECTOR, 4 CKTS DUAL SLOTS, SMT	MOLEX INCORPORATED	DOCUMENT NO.: SD-8981-4SM8 SHEET NO.: 1 OF 1	
	DRAFT WHERE APPLICABLE MUST REMAIN WITHIN DIMENSIONS		SIZE A3	THIS DRAWING CONTAINS INFORMATION THAT IS PROPRIETARY TO MOLEX INCORPORATED AND SHOULD NOT BE USED WITHOUT WRITTEN PERMISSION					
	C2	REV							
	ADDITIONAL NOTES AND REVISIONS								