

**PLEASE CHECK WWW.MOLEX.COM FOR LATEST PART INFORMATION**

**Part Number:** [0887419100](#)  
**Status:** **Active**  
**Description:** MicroCross™ DVI Digital Visual Interface, Shielded I/O Adapter, DVI-I-Analog/Digital Receptacle to VGA Plug

**Documents:**

[Drawing \(PDF\)](#) [RoHS Certificate of Compliance \(PDF\)](#)

**General**

Product Family	I/O Connectors
Series	<a href="#">88744</a>
Application	Wire-to-Board
Comments	DVI-I-Analog/Digital Receptacle to VGA Plug
Component Type	Adapter
Product Name	MicroCross™DVI
Type	N/A

**Physical**

Circuits (Loaded)	29
Circuits (maximum)	29
Color - Resin	Natural
Durability (mating cycles max)	100
Lock to Mating Part	Yes
Material - Metal	Phosphor Bronze, Steel
Material - Plating Mating	Gold
Material - Plating Termination	Tin
Material - Resin	High Temperature Thermoplastic
Orientation	Vertical
PCB Retention	Yes
Packaging Type	Bag
Panel Mount	No
Pitch - Mating Interface (in)	0.075 In, 0.100 In
Pitch - Mating Interface (mm)	1.90 mm, 2.54 mm
Plating min: Mating (µin)	2, 30
Plating min: Mating (µm)	0.05, 0.75
Plating min: Termination (µin)	100, 150
Plating min: Termination (µm)	2.5, 3.75
Polarized to Mating Part	Yes
Surface Mount Compatible (SMC)	N/A
Temperature Range - Operating	-20°C to +85°C
Termination Interface: Style	Through Hole
Wire Size AWG	N/A

**Electrical**

Current - Maximum per Contact	3A
Shielded	Yes
Voltage - Maximum	40V

**Material Info**

**Reference - Drawing Numbers**

Product Specification	RPS-88741-001
Sales Drawing	SD-88741-012

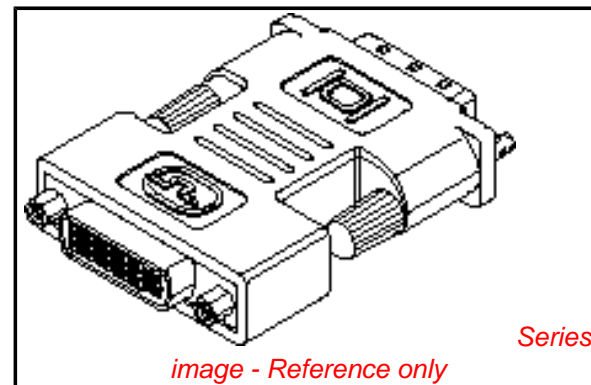

*image - Reference only*

**EU RoHS**

**ELV and RoHS  
Compliant**  
**REACH SVHC**  
 Not Reviewed  
**Halogen-Free  
Status**  
 Not Reviewed

**China RoHS**



**Need more information on product  
environmental compliance?**

Email [productcompliance@molex.com](mailto:productcompliance@molex.com)  
 For a multiple part number RoHS Certificate of Compliance, [click here](#)

Please visit the [Contact Us](#) section for any non-product compliance questions.

**Search Parts in this Series**

[88744Series](#)

**Mates With**

[74320](#) receptacles

**PLEASE CHECK [WWW.MOLEX.COM](http://WWW.MOLEX.COM) FOR LATEST PART INFORMATION**

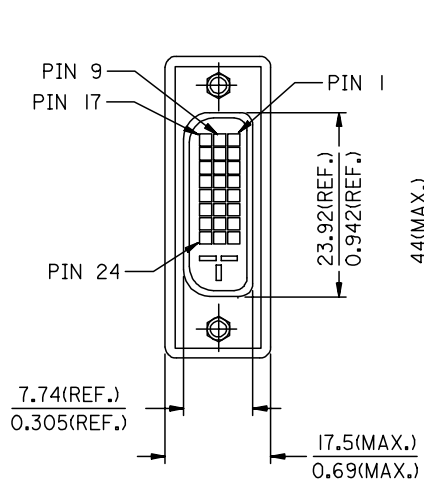

DVI-D(F)

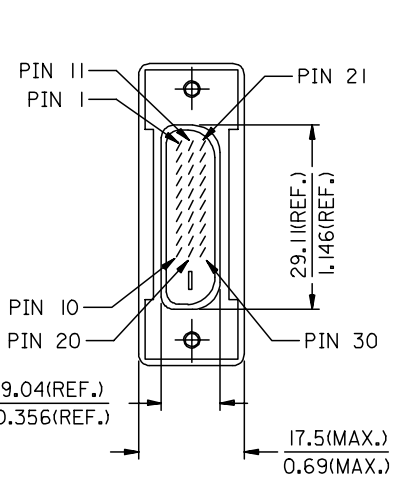
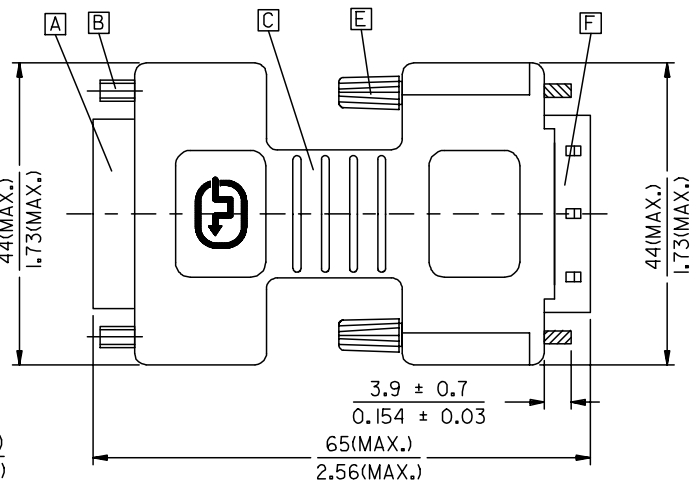

P&D-D(M)

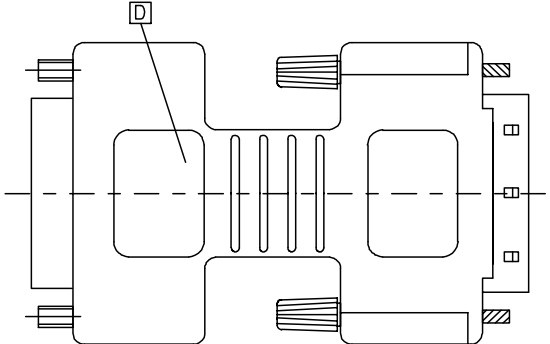

BACK SIDE

ENTER DESCRIPTION EC NO: DG2006-0186 DRWN:PDAI CHKD: APPR:TKAN	2006/03/09 2006/03/09 2006/03/10	QUALITY SYMBOLS ▽=0 ◻=0	GENERAL TOLERANCES (UNLESS SPECIFIED)		DIMENSION STYLE MM/IN		SCALE ---	DESIGN UNITS METRIC	THIRD ANGLE PROJECTION			
	DESCRIPTION		mm	INCH	DRAWN BY	DATE	TITLE					
	REV		4 PLACES	± ---	± ---	PDAI	2006/03/07	DVI_D(F)-P&D(M) ADAPTER				
			3 PLACES	± ---	± ---	CHECKED BY	DATE	MOLEX INCORPORATED				
	2 PLACES	± ---	± ---	ZXDENG	2006/03/07	MATERIAL NO.						
	1 PLACE	± ---	± ---	APPROVED BY	DATE	88741-9200		DOCUMENT NO.				
				BORON	2006/03/07			SD-88741-013				
						SIZE		SHEET NO.				
						A 4		1 OF 2				
DRAFT WHERE APPLICABLE MUST REMAIN WITHIN DIMENSIONS			THIS DRAWING CONTAINS INFORMATION THAT IS PROPRIETARY TO MOLEX INCORPORATED AND SHOULD NOT BE USED WITHOUT WRITTEN PERMISSION									

NOTE:1. PLASTIC COVER: SNOW WHITE UL GRADE ABS.  
 2. DVI CONNCEOTOR SPECIFICATION  
 2.1 REFER TO PRODUCT SPEC. PS74320-0001.  
 2.2 CONTACT PLATING: AU FLASH.  
 3. ELECTRICAL PERFORMANCE  
 3.1 INSULATION RESISANCE: 20 M Ohms MIn  
 3.2 DIELECTRIC STRENGTH: 300V DC FOR 10 MILLISECONDS.  
 4. ADAPTOR SPECIFICATION  
 4.1 REFER TO PRODUCT SPEC. PS88741-8800.  
 5. THIS PRODUCT MUST MEET MX RoHS COMPLIANCE.

7. MATERIAL LIST

F	P&D CONNECTOR ASSY 674850009
E	ADAPTER SCREW 887806003
D	DVI(F) TO P&D(M) ADAPTER BOTTOM COVER 887899308
C	DVI(F) TO P&D(M) ADAPTER TOP COVER 887899301
B	DVI_D FEMALE SCREW 887806066
A	DVI_D FEMALE CONNECTOR 743207000
ITEM	DESCRIPTION

6. CONNECTION DIAGRAM

SHIELD	SHIEDL	GROUND
PIN 24	PIN 15	TMDS CLOCK-
PIN 23	PIN 14	TMDS CLOCK+
PIN 22	PIN 7	TMDS CLOCK SHIELD
PIN 19	PIN 23	TMDS DATA 0 SHIELD
PIN 18	PIN 21	TMDS DATA 0+
PIN 17	PIN 22	TMDS DATA 0-
PIN 16	PIN 8	HOT PLUG DETECT
PIN 15	PIN 25	GROUND(+5V & HV SYNC.)
PIN 14	PIN 28	POWER +5V
PIN 11	PIN 13	TMDS DATA 1 SHIELD
PIN 10	PIN 11	TMDS DATA 1+
PIN 9	PIN 12	TMDS DATA 1-
PIN 7	PIN 26	DDC DATA
PIN 6	PIN 27	DDC CLOCK
PIN 3	PIN 3	TMDS DATA 2 SHIELD
PIN 2	PIN 1	TMDS DATA 2+
PIN 1	PIN 2	TMDS DATA 2-
DVI-D(F)	P&D-D(M)	CABLE FUNCTION

ENTER DESCRIPTION EC NO: DG2006-0186 DRWN:PDAI CHKD: APPR:TKAN 2006/03/09 2006/03/09 2006/03/10	QUALITY SYMBOLS 	GENERAL TOLERANCES (UNLESS SPECIFIED)		DIMENSION STYLE MM/IN	SCALE ---	DESIGN UNITS METRIC	THIRD ANGLE PROJECTION		
		4 PLACES ± --- ± ---	3 PLACES ± --- ± ---	DRAWN BY PDAI	DATE 2006/03/07	TITLE DVI_D(F)-P&D_D(M) ADAPTER			
		2 PLACES ± --- ± ---	1 PLACE ± --- ± ---	CHECKED BY ZXDENG	DATE 2006/03/07	APPROVED BY BORON			
		ANGULAR ± ---°		MATERIAL NO. 88741-9200		DOCUMENT NO. SD-88741-013		SHEET NO. 2 OF 2	
DRAFT WHERE APPLICABLE MUST REMAIN WITHIN DIMENSIONS		THIS DRAWING CONTAINS INFORMATION THAT IS PROPRIETARY TO MOLEX INCORPORATED AND SHOULD NOT BE USED WITHOUT WRITTEN PERMISSION							