

PLEASE CHECK WWW.MOLEX.COM FOR LATEST PART INFORMATION

Part Number: **0493900004**
Status: **Active**
Description: 6.60mm (.259") Pitch Wire-to-Board Header, Dual Row, Vertical, 8 Circuits, Polyester Carbonate UL94V-0, Blue

Documents:

[3D Model](#) [Product Specification PS-49390-001 \(PDF\)](#)
[Drawing \(PDF\)](#) [RoHS Certificate of Compliance \(PDF\)](#)

General

Product Family	PCB Headers
Series	49390
Application	Wire-to-Board
Comments	Polarized to Mating Part
Product Name	N/A

Physical

Breakaway	No
Circuits (Loaded)	8
Circuits (maximum)	8
Durability (mating cycles max)	30
First Mate / Last Break	No
Glow-Wire Compliant	No
Guide to Mating Part	No
Keying to Mating Part	None
Lock to Mating Part	Yes
Material - Plating Mating	Tin
Material - Plating Termination	Tin
Number of Rows	2
Orientation	Vertical
PC Tail Length (in)	0.130 In
PC Tail Length (mm)	3.30 mm
PCB Locator	Yes
PCB Retention	Yes
Packaging Type	Bag
Pitch - Mating Interface (in)	0.236 In
Pitch - Mating Interface (mm)	6.00 mm
Pitch - Term. Interface (in)	0.236 In
Pitch - Term. Interface (mm)	6.00 mm
Plating min: Mating (µin)	40
Plating min: Mating (µm)	1
Plating min: Termination (µin)	40
Plating min: Termination (µm)	1
Polarized to Mating Part	No
Polarized to PCB	Yes
Shrouded	Fully
Stackable	No
Surface Mount Compatible (SMC)	No
Temperature Range - Operating	-40°C to +120°C
Termination Interface: Style	Through Hole

Electrical

Current - Maximum per Contact	0.5A
Voltage - Maximum	300V AC (RMS)/DC

Material Info

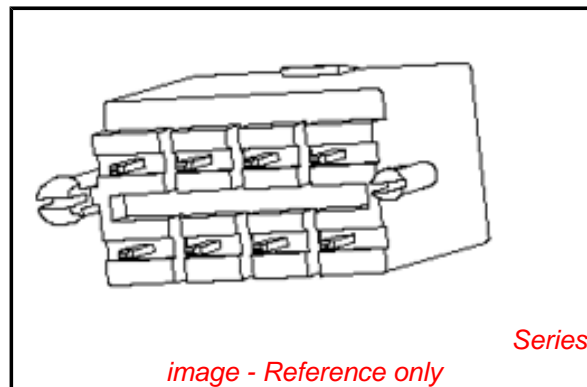

EU RoHS

ELV and RoHS Compliant
REACH SVHC
 Not Reviewed
Halogen-Free
Status
Not Reviewed

China RoHS



Need more information on product environmental compliance?

Email productcompliance@molex.com
 For a multiple part number RoHS Certificate of Compliance, [click here](#)

Please visit the [Contact Us](#) section for any non-product compliance questions.

Search Parts in this Series
[49390Series](#)

Reference - Drawing Numbers

Product Specification
Sales Drawing

PS-49390-001
SD-49390-001

This document was generated on 04/21/2010

PLEASE CHECK WWW.MOLEX.COM FOR LATEST PART INFORMATION

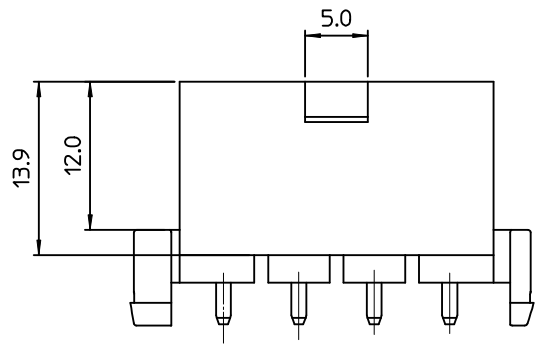
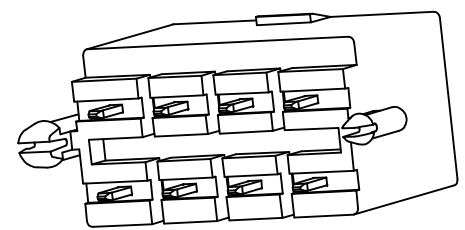

Notes

1. MATERIAL : WAFER : PC/PET UL94V-0
 ◎PIN : BRASS, PRE TIN-PLATED
2. COLOR : SEE TABLE
3. MATED HOUSING : 49391-000*
4. PRODUCT SPECIFICATION : PS-49390-001
5. PACKING SPECIFICATION : PK-49390-001

NO.	ENG NO.	COLOR	MATERIAL
1	49390-0001	NATURAL	PC/PET (UL94V-0)
2	49390-0002	RED	
3	49390-0004	BLUE	

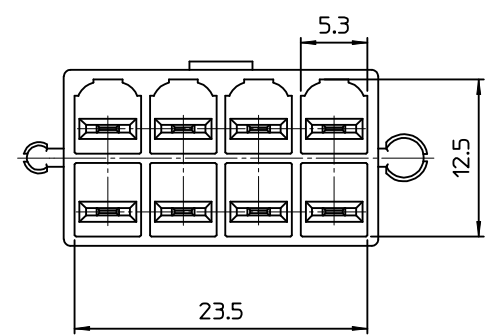
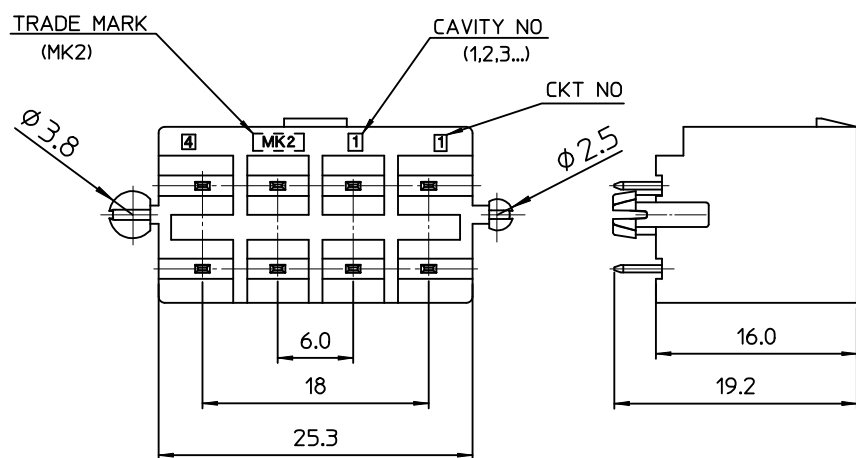
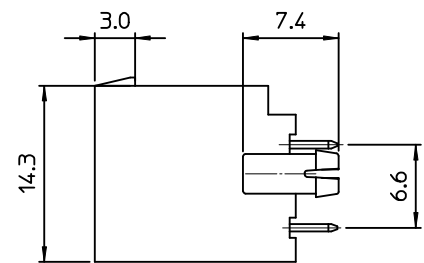

REVISED EC NO: KOR2010-0047 DRAWN: JHPARK01 2009/09/16 CHKD: WYANG 2009/09/18 APPR: YUNSIKKIM 2009/09/18	QUALITY SYMBOLS ▽=0 ▽=0	GENERAL TOLERANCES (UNLESS SPECIFIED) <table border="1"> <thead> <tr> <th></th> <th>mm</th> <th>INCH</th> </tr> </thead> <tbody> <tr> <td>4 PLACES</td> <td>± ---</td> <td>± ---</td> </tr> <tr> <td>3 PLACES</td> <td>± ---</td> <td>± ---</td> </tr> <tr> <td>2 PLACES</td> <td>± 0.2</td> <td>± ---</td> </tr> <tr> <td>1 PLACE</td> <td>± 0.3</td> <td>± ---</td> </tr> </tbody> </table> ANGULAR ± 1 °		mm	INCH	4 PLACES	± ---	± ---	3 PLACES	± ---	± ---	2 PLACES	± 0.2	± ---	1 PLACE	± 0.3	± ---	DIMENSION STYLE MM ONLY	SCALE 2.5:1	DESIGN UNITS METRIC	THIRD ANGLE PROJECTION
		mm	INCH																		
	4 PLACES	± ---	± ---																		
	3 PLACES	± ---	± ---																		
2 PLACES	± 0.2	± ---																			
1 PLACE	± 0.3	± ---																			
DESCRIPTION .070 W/B CONNECTOR-8P HEADER	DRAWN BY JH.PARK	DATE 2006/05/30	CHECKED BY WY.YANG	DATE 2006/05/30	TITLE																
APPROVED BY SH.CHOI	DATE 2006/05/30	MATERIAL NO.		MOLEX INCORPORATED		SHEET NO. 1 OF 01															
DRAFT WHERE APPLICABLE MUST REMAIN WITHIN DIMENSIONS	SEE TABLE	DOCUMENT NO. SD-49390-001		THIS DRAWING CONTAINS INFORMATION THAT IS PROPRIETARY TO MOLEX INCORPORATED AND SHOULD NOT BE USED WITHOUT WRITTEN PERMISSION																	