

SURGING

紹 鑫 實 業

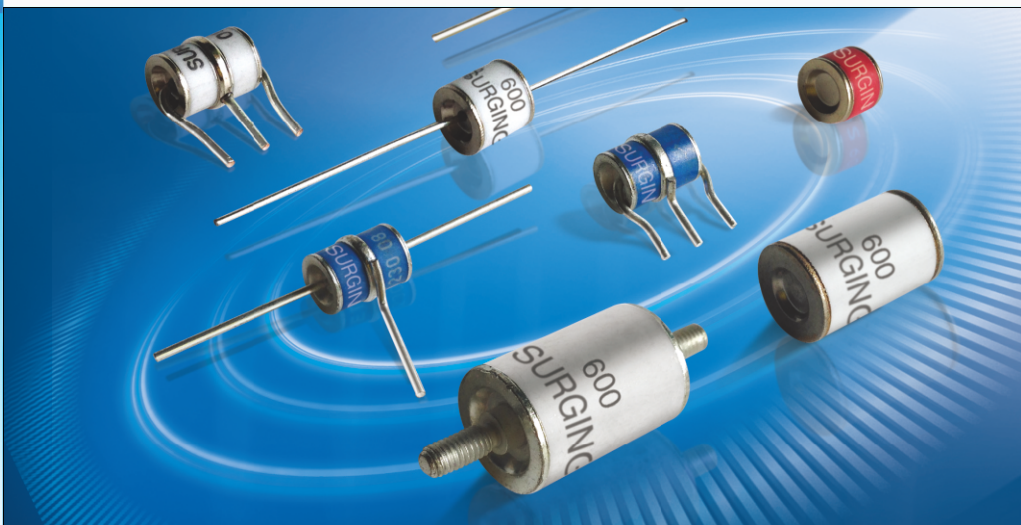

Surge Arresters

陶瓷气体放电管

S50 Series

Type S50-SMD Series/贴片氣體放電管 Surface mounted Gas Discharge Tube

RoHS

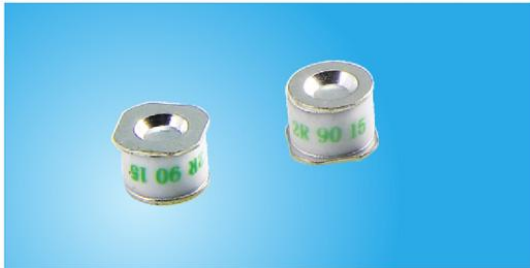

Dimensions(mm)尺寸

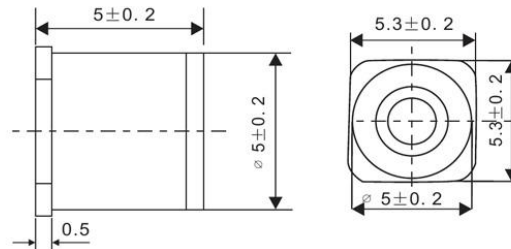

Features 特性

- Fast response time to rapid surge
- Good insulation and low capacitance
- Impulse current capacity 2.5kA 8x20μs
- Symmetry in both direction
- UL Recognized 

Applications 應用

- Cable TV/Coaxial cable protection
- AC Line Protection
- Power Supply Protection
- Telecommunications

Electrical Specifications 電氣特性

Catalog Number 料號	DC Spark-Over Voltage 標稱直流擊穿電壓 100V/S VS (V)	Impulse Spark Over 衝擊擊穿電壓 1KV/μs Vis(V) Max	Nom Impulse Discharge Current 耐衝擊電流 8/20μs (KA)	Nom Discharge Current(L) 耐工頻電流 IS, 50Hz(A)	Insulation Resistance 絕緣電阻 Min DC MΩ V		Capacitance 電容值 C 1KHZ<6V pF Max
S50-75XSMD	75±30%	700	2.5	2.5	1000	50	1.0
S50-90XSMD	90±30%	700	2.5	2.5	1000	50	1.0
S50-150XSMD	150±30%	700	2.5	2.5	1000	50	1.0
S50-230XSMD	230±20%	800	2.5	2.5	1000	100	1.0
S50-350XSMD	350±20%	800	2.5	2.5	1000	100	1.0
S50-470XSMD	470±20%	900	2.5	2.5	1000	100	1.0
S50-600XSMD	600±20%	1200	2.5	2.5	1000	100	1.0
S50-1000XSMD	1000±20%	1800	2.5	2.5	1000	100	1.0

Materials 材料

Ceramic Body/End plate
Element: Silver or Silver
Metallization of ceramic body
High temperature solder preform
End termination overcoat: Nickel Flash, Tin/Lead

Operation Temperature 工作溫度

-40°C to 125°C

Packaging 包裝

On Taping: S50-SMD series-1500pcs Per Reel
S50-SMD series-24000pcs outer box