

**PLEASE CHECK WWW.MOLEX.COM FOR LATEST PART INFORMATION**

**Part Number:** [0191640010](#)  
**Status:** **Active**  
**Description:** Perma-Seal™ Male Snap Plug for 18-22 AWG Wire, Diameter 3.96mm (.156")

**Documents:**

[Drawing \(PDF\)](#) [RoHS Certificate of Compliance \(PDF\)](#)

**Agency Certification**

CSA LR18689  
 UL E152602

**General**

Product Family Quick Disconnects  
 Series [19164](#)  
 Crimp Quality Equipment Yes  
 Product Name Perma-Seal™  
 Type Snap Plug

**Physical**

Barrel Type Closed  
 Flammability 94V-2  
 Gender Male  
 Glow-Wire Compliant No  
 Insulation NiAc™  
 Lock to Mating Part None  
 Material - Metal Copper  
 Orientation Straight  
 Packaging Type Bag  
 Tab Thickness N/A  
 Tab Width N/A  
 Temperature Range - Operating -55°C to +125°C  
 Wire Insulation Diameter 5.97mm (.235") max.  
 Wire Size AWG 18, 20, 22  
 Wire Size mm² 0.25 - 1.50

**Electrical**

Voltage - Maximum 600V

**Material Info**

Old Part Number SA-269

**Reference - Drawing Numbers**

Sales Drawing SD-19164-031



image - Reference only

Series

**EU RoHS**

**ELV and RoHS**

**Compliant**

**REACH SVHC**

Not Reviewed

**Halogen-Free**

**Status**

**Not Reviewed**

**China RoHS**



**Need more information on product environmental compliance?**

Email [productcompliance@molex.com](mailto:productcompliance@molex.com)  
 For a multiple part number RoHS Certificate of Compliance, [click here](#)

Please visit the [Contact Us](#) section for any non-product compliance questions.

**Search Parts in this Series**

[19164Series](#)

**Application Tooling | FAQ**

*Tooling specifications and manuals are found by selecting the products below. Crimp Height Specifications are then contained in the Application Tooling Specification document.*

**Global**

Description	Product #
Hand Crimp Tool	<a href="#">0640010100</a>
Hand Crimp Tool	<a href="#">0640010300</a>
Crimp Head for the AT-200™ Pneumatic Hand Tool	<a href="#">0640050100</a>
Crimp Head for the AT-200™ Pneumatic Hand Tool	<a href="#">0640050300</a>

	13	12	11	10	9	8	7	6	5	4	3	2	1
J	MATERIAL NUMBER	ENGINEERING NUMBER	MATERIAL NUMBER TAPE	ENGINEERING NUMBER TAPE	WIRE AWG	MWID $\triangle 4$	ID MIN	INSULATION COLOR					
	I91640010	SA-269	I91640807	SA-269T	22-18	.235/5.97	.054/1.37	RED					
	I91640040	SB-289	I91640315	SB-289T	16-14	.264/6.71	.080/2.03	BLUE					

(A)

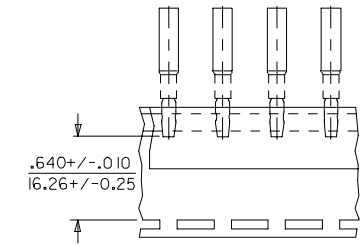

PARTS ON TAPE

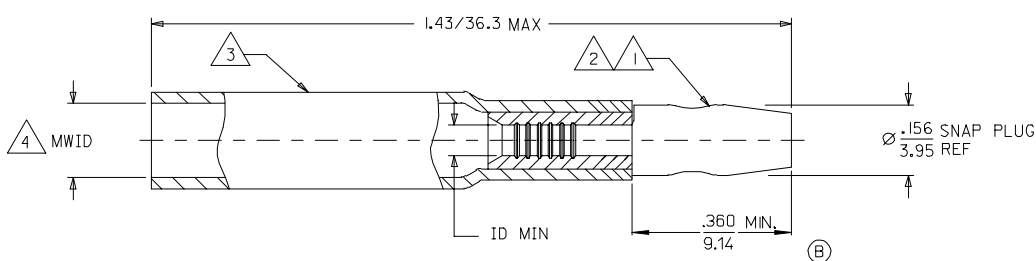

NOTES:

- $\triangle 1$  TERMINAL MATERIAL: COPPER ALLOY
- $\triangle 2$  FINISH: ELECTRO TIN PLATE.
- $\triangle 3$  INSULATION MATERIAL: HEAT SHRINKABLE TUBING WITH HOTMELT ADHESIVE INNER LINER. COLOR: SEE CHART
- $\triangle 4$  MWID = MAXIMUM WIRE INSULATION DIAMETER.

SALES DRAWING

RELEASED FC NO: ETC2007-0054 DRWN: JLOMASTRO 2006/08/16 CHKD: RDEROSS 2006/08/16 APPR: JMACNEIL 2006/08/17 REVISIONS DESCRIPTION	QUALITY SYMBOLS	GENERAL TOLERANCES (UNLESS SPECIFIED)	DIMENSION STYLE	SCALE	DESIGN UNITS	THIRD ANGLE PROJECTION	
	$\nabla = 0$ $\nabla = 0$	mm INCH	IN/MM	---	INCH		
		4 PLACES ± --- ± ---	DRAWN BY ASAYDEH	DATE 05/12/13	TITLE .156 BULLET PLUG PERMA-SEAL		
		3 PLACES ± --- ± ---	CHECKED BY JLOMASTRO	DATE 05/12/13	MOLEX INCORPORATED		
	2 PLACES ± --- ± ---	APPROVED BY RDEROSS	DATE 05/12/13	DOCUMENT NO. SD-19164-031			
	1 PLACE ± --- ± ---	ANGULAR ± --- °		SHEET NO. 1 OF 1			
DRAFT WHERE APPLICABLE MUST REMAIN WITHIN DIMENSIONS		SEE CHART		THIS DRAWING CONTAINS INFORMATION THAT IS PROPRIETARY TO MOLEX INCORPORATED AND SHOULD NOT BE USED WITHOUT WRITTEN PERMISSION			