

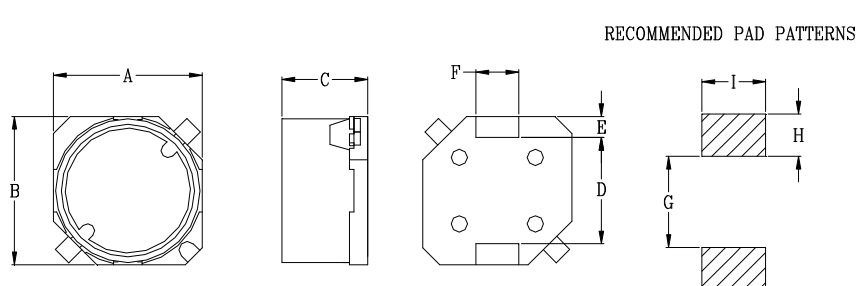

## DELTA P/N : SIWC75 Series

### Mechanical dimensions



Dimensions (Unit : mm)

A	7.6 MAX
B	7.6 MAX
C	5.2 MAX
D	5.3
E	1.0
F	2.0
G	4.4
H	2.0
I	3.0

### Electrical Characteristics @25°C 100KHz, 0.1V

Delta P/N	L <sup>1</sup> (uH)	DCR (mΩ) MAX	I <sub>rated</sub> <sup>2</sup> (A <sub>dc</sub> )
SIWC75-1R0	1.0	20	2.8
SIWC75-1R5	1.5	24	2.6
SIWC75-2R2	2.2	28	2.4
SIWC75-3R3	3.3	34	2.2
SIWC75-4R7	4.7	39	2.0
SIWC75-6R8	6.8	50	1.8
SIWC75-100	10	55	1.7
SIWC75-120	12	73	1.5
SIWC75-150	15	81	1.4
SIWC75-180	18	102	1.2
SIWC75-220	22	115	1.1
SIWC75-270	27	159	1.0
SIWC75-330	33	182	0.85
SIWC75-390	39	199	0.8
SIWC75-470	47	221	0.75
SIWC75-560	56	306	0.65
SIWC75-680	68	345	0.6
SIWC75-820	82	390	0.57
SIWC75-101	100	432	0.5
SIWC75-121	120	440	0.47
SIWC75-151	150	730	0.4
SIWC75-181	180	780	0.39
SIWC75-221	220	940	0.33
SIWC75-271	270	1250	0.31
SIWC75-331	330	1400	0.27
SIWC75-391	390	1520	0.27
SIWC75-471	470	1700	0.25
SIWC75-561	560	2390	0.23

1. Tolerance of inductance : ± 20%
2. I<sub>rated</sub> is the DC current which cause the inductance drop 10% typical of it's nominal inductance without current and the surface temperature of the part increase less than 45 °C.
3. Operating temperature: -40°C to 105°C (Self-temperature rise included).