

NOTES:
 Current Rating: 3.0AMP
 Contact Resistance: 20mΩ Max
 Withstand Voltage: 1000V AC/DC
 Insulation Resistance: 1000MΩ Min
 Operation Temperature: -40℃ to +105℃

Contact Material: Brass
 Contact plating: Au over Ni
 Insulator Material: PA9T+33%G.F UL94V-0

Recommended P.C.B Layout(Top Side)
 (PCB BOARD TOLERANCE±0.05)

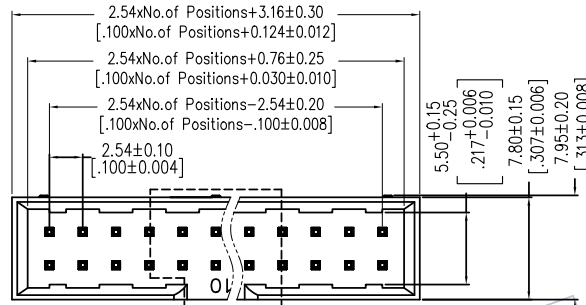
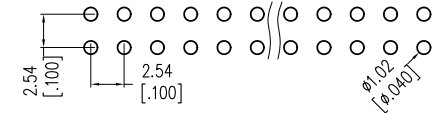

DIM. K	FH NO.	DIM. H
10.30	2171 SMT TYPE WITH BUMP	8.95
12.80		11.50
16.00		14.70
18.00		16.70
20.00		18.70
25.00		23.70
30.00		28.70
35.00		33.70
37.00		35.70
40.00		38.70
45.00	43.70	

DIM. K	FH NO.	DIM. H
11.20	2185 DIP TYPE WITHOUT BUMP	8.95
13.80		11.50
16.00		13.70
18.00		15.70
20.00		17.70
25.00		22.70
30.00		27.70
35.00		32.70
37.00		34.70
40.00		37.70
45.00	42.70	

Ordering Information

3110A-XX S XX B D00 X X

- No. of Pins: 02-80P
- Contact Plating: G0=Gold Flash, G3=10u"Gold, G4=15u"Gold, G5=30u"Gold, S0=Gold Flash/Tin, S3=10u"Gold/Tin, S4=15u"Gold/Tin, S5=30u"Gold/Tin
- Color Insulator: B=Black, G=Gray(427C)
- Packing: A=Tray, T=Tube

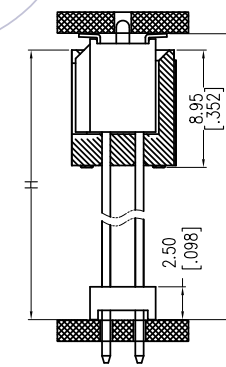
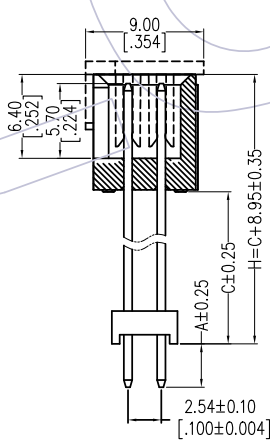
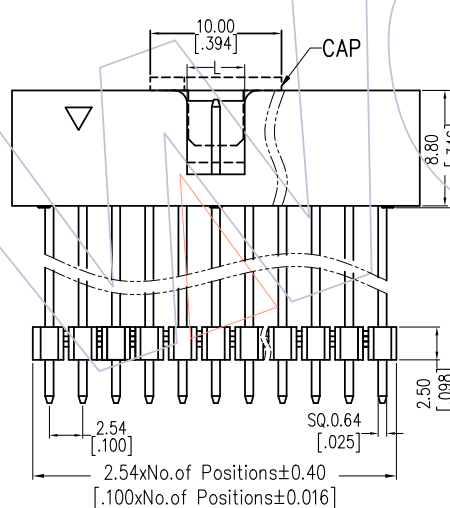

Mating With 2171

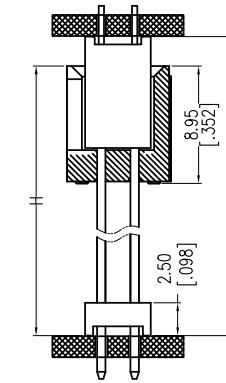

Mating With 2185

Dimension antitheses list		
NO. Pin	STANDARD(A)	L
6P-8P	3.3mm	4.00
10P-80P		4.40

PART NO.	"WCON"LOGO
3110A-XXSXXBDXXXX	无
3110A-XXSXXBDXXXXW	有

OPERATION	DRAW	DATE	SCALE	FIT	PART NO.
X.X ±0.40	Ding	2019/06/13	UNIT	mm	3110A-XXSXXBD00XX
X.XX ±0.25	CHECK	DATE	SIZE	A4	
X.XXX ±0.15	APPROVE	DATE	SHEET	1/1	2.54 BOX HEADER 180° H=8.95 ADD HOUSING
Angle ± 3'	DIM	TOL	PROJ.	Customer NO.	

REV	DATE	MODIFICATION DESCRIPTION	CHANGE
A0	2019/06/13	NEW	-----

WCON

Http: www.wcon.com

WCON-Dongguan
 Tel: +86 769 85358920
 Fax: +86 769 85358915
 E-mail: sales@wcon.com

WCON-Kunshan
 Tel: +86 512 57468408
 Fax: +86 512 57468468
 E-mail: salesks@wcon.com