

1

2

3

4

5

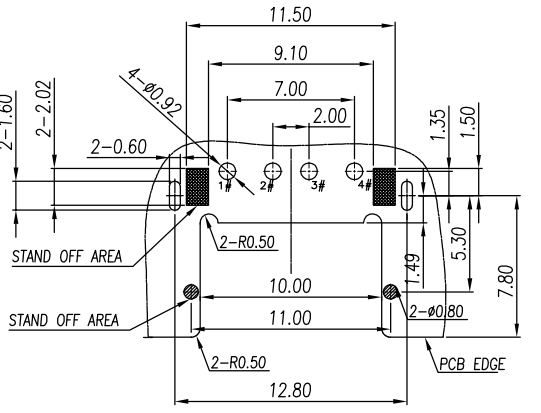
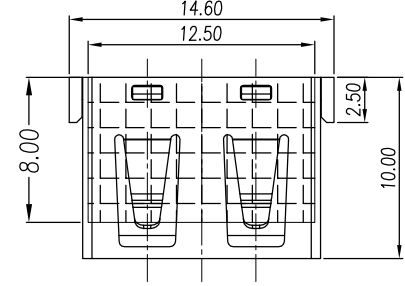
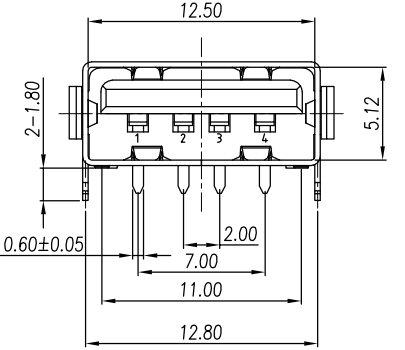
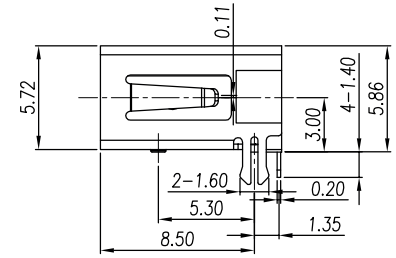

PCB LAYOUT - COMPONENT VIEW  
RECOMMENDED PCB THICKNESS : 1.2 mm

TECHNICAL CHARACTERISTICS

MATERIAL  
INSULATOR: LCP  
FLAMMABILITY RATING: UL94-V0  
COLOR: BLACK  
CONTACT MATERIAL: COPPER ALLOY  
CONTACT PLATING: GOLD OVER Ni  
COVER MATERIAL: STAINLESS STEEL  
COVER PLATING: Ni  
QUALITY CLASS: 5 000 MATING CYCLES

ENVIRONMENTAL  
OPERATING TEMPERATURE: -55°C UP TO +85°C  
COMPLIANCE: HALOGEN FREE & ROHS

ELECTRICAL  
CURRENT RATING: 1.5A  
WORKING VOLTAGE: 30 VAC MAX  
WITHSTANDING VOLTAGE: 500 VAC/MIN  
INSULATION RESISTANCE: > 1000 MΩ  
CONTACT RESISTANCE: 30 mΩ MAX

MECHANICAL  
INSERTION FORCE: 35.0N MAX  
EXTRACTION FORCE: 10.0N MIN

SOLDERING  
JEDEC LEAD FREE WAVE SOLDERING PROCESS

PACKAGING  
TAPE & REEL WITH MYLAR

RoHS Compliant			
G			
F			
E			
D			
C			
B			
A	22-JUN-15	PDF	AK
REV	DATE	FILE	BY

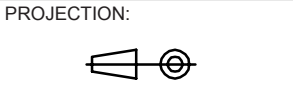

GENERAL TOLERANCE  
.X = +/- 0.2  
.XX = +/- 0.15



APPROVAL: NPr

UNIT: MM  
SCALE:  
SHEET: 1/3  
DRAW: AK

DESCRIPTION: USB TYPE A HORIZONTAL THT -SHORT TYPE  
WERI PART NO: 614 104 190 121

SIZE  
**A4**

A

B

C

D

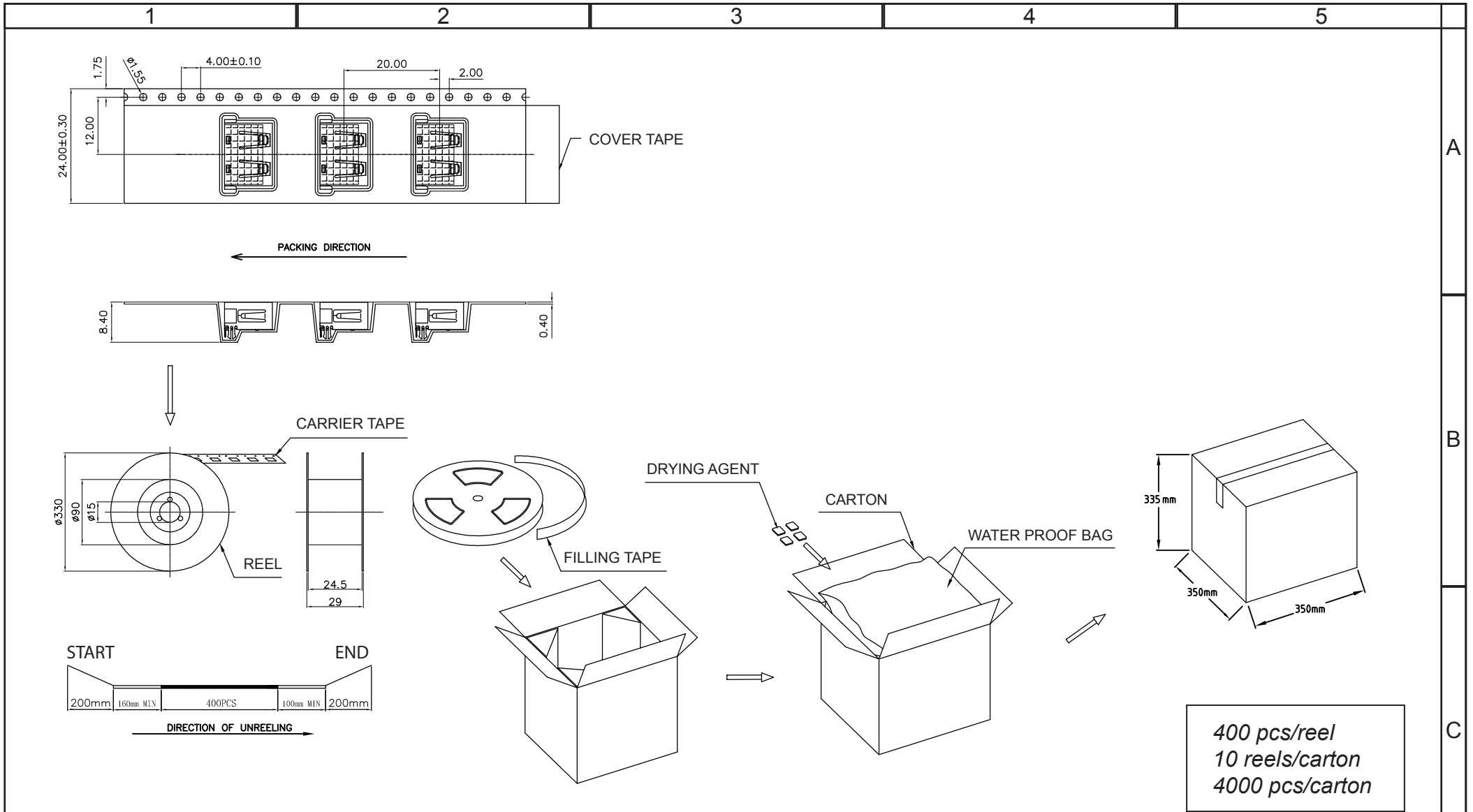

RoHS Compliant				PROJECTION:	GENERAL TOLERANCE		DESCRIPTION: USB TYPE A FEMALE HORIZONTAL THT WERI PART NO: 614 104 190 121	SIZE <b>A4</b>
G					.X = +/- 0.2 .XX = +/- 0.15			
F				APPROVAL: NPr	UNIT: MM			
E					SCALE:			
D					SHEET: 2/3			
C					DRAW: AK			
B								
A								
REV	DATE	FILE	BY					

1

2

3

4

5

## Cautions and Warnings:

This electronic component is designed and developed with the intention for use in general electronics equipments.

Before incorporating the components into any equipments in the field such as aerospace, aviation, nuclear control, submarine, transportation, (automotive control, train control, ship control), transportation signal, disaster prevention, medical, public information network etc. where higher safety and reliability are especially required or if there is possibility of direct damage or injury to human body, Würth Elektronik must be asked for a written approval.

In addition, even electronic component in general electronic equipments, when used in electrical circuits that require high safety, reliability functions or performance, the sufficient reliability evaluation-check for the safety must be performed before by the user before usage.

A

B

C

RoHS Compliant

G				PROJECTION: 	GENERAL TOLERANCE .X = +/- 0.2 .XX = +/- 0.15		
F							
E							
D							
C				APPROVAL: JC	UNIT: MM	DESCRIPTION: DISCLAIMER	SIZE <b>A4</b>
B					SCALE:		
A	10-SEP-14	PDF	QL		SHEET: 3/3	WERI PART NO: DISCLAIMER	
REV	DATE	FILE	BY		DRAW: QL		

D