

Features

- High collector- emitter voltage ($V_{CEO}=350V$)
- Current transfer ratio
(CTR: 50 to 600% at $I_F=5mA$, $V_{CE}=5V$)
- High isolation voltage between input and output
Viso = 5000 Vrms
- Compact dual-in-line package
- Pb free and RoHS compliant.
- UL approved (No E214129)
- VDE approved (No 132249)
- SEMKO approved
- NEMKO approved
- DEMKO approved
- FIMKO approved
- CSA approved

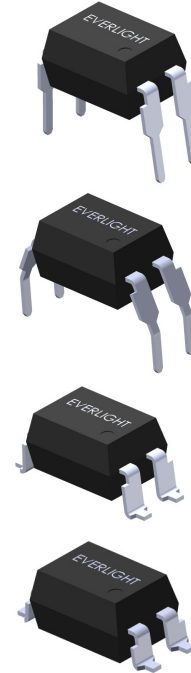

Description

The EL851 series devices consist an infrared emitting diodes, optically coupled to a phototransistor detector.

The devices are in a 4-pin DIP package and available in wide-lead spacing and SMD option.

Applications

- Telephone line interface
- Interface to power supply circuit
- Controller for SSRs. DC motor
- Programmable Controllers

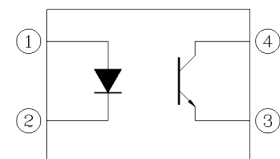

1. Anode
2. Cathode
3. Emitter
4. Collector

4 PIN DIP HIGH VOLTAGE PHOTOTRANSISTOR PHOTOCOUPLER

EL851 series

Absolute Maximum Ratings ($T_a=25^\circ\text{C}$)

Parameter		Symbol	Rating	Unit
Input	Forward current	I_F	80	mA
	Peak forward current (1 μs pulse)	I_{FM}	1	A
	Reverse voltage	V_R	6	V
	Power dissipation	P_D	150	mW
Output	Collector power dissipation	P_C	300	mW
	Collector-Emitter voltage	V_{CEO}	350	V
	Collector Current	I_C	100	mA
	Emitter-Collector voltage	V_{ECO}	7	V
Total power dissipation		P_{tot}	260	mW
Isolation voltage ^{*1}		V_{iso}	5000	Vrms
Operating temperature		T_{opr}	-55~+100	$^\circ\text{C}$
Storage temperature		T_{stg}	-55~+150	$^\circ\text{C}$
Soldering temperature ^{*2}		T_{sol}	260	$^\circ\text{C}$

Notes

*1 AC for 1 minute, R.H.= 40 ~ 60% R.H. In this test, pins 1 & 2 are shorted together, and pins 3 & 4 are shorted together.

*2 For 10 seconds.

4 PIN DIP HIGH VOLTAGE PHOTOTRANSISTOR PHOTOCOUPLER

EL851 series

Electrical Characteristics (T_a=25°C unless specified otherwise)

Input

Parameter	Symbol	Min.	Typ.*	Max.	Unit	Condition
Forward voltage	V _F	-	1.2	1.4	V	I _F = 10mA
Reverse current	I _R	-	-	10	μA	V _R = 5V
Input capacitance	C _{in}	-	30	-	pF	V = 0, f = 1MHz

Output

Parameter	Symbol	Min.	Typ.*	Max.	Unit	Condition
Collector-Emitter dark current	I _{CEO}	-	-	100	nA	V _{CE} = 200V
Collector-Emitter breakdown voltage	BV _{CEO}	350	-	-	V	I _C = 0.1mA
Emitter-Collector breakdown voltage	BV _{ECO}	7	-	-	V	I _E = 0.1mA
Collector-Emitter capacitance	C _{CE}	-	10	-	pF	V _{CE} = 0V, f = 1MHz

Transfer Characteristics

Parameter	Symbol	Min.	Typ.*	Max.	Unit	Condition
Current Transfer Ratio	CTR	50	-	600	%	I _F = 5mA, V _{CE} = 5V
Collector-emitter saturation voltage	V _{CE(sat)}	-	-	0.4	V	I _F = 20mA, I _C = 1mA
Isolation resistance	R _{IO}	10 ¹¹	-	-	Ω	V _{IO} = 500Vdc
Input-output capacitance	C _{IO}	-	0.6	-	pF	V _{IO} = 0, f = 1MHz
Rise time	t _r	-	4	18	μs	V _{CE} = 2V, I _C = 2mA, R _L = 100Ω
Fall time	t _f	-	5	18		

* Typical values at T_a = 25°C

Typical Performance Curves

Figure 1. Forward Current vs Forward Voltage

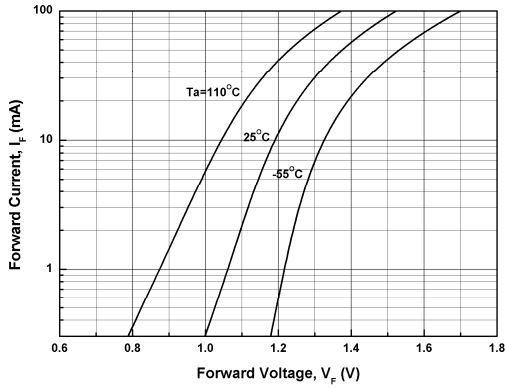

Figure 2. Current Transfer Ratio vs Forward Current

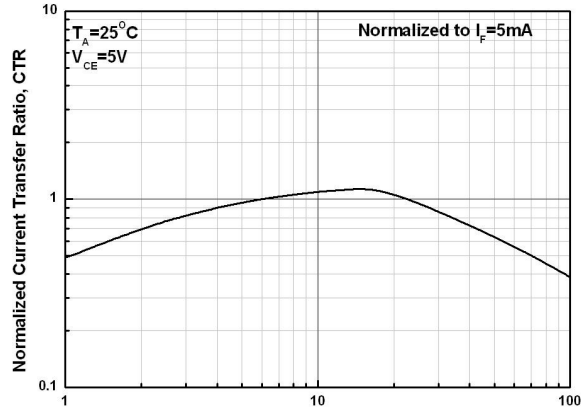

Figure 3. Collector Current vs Collector-emitter Voltage

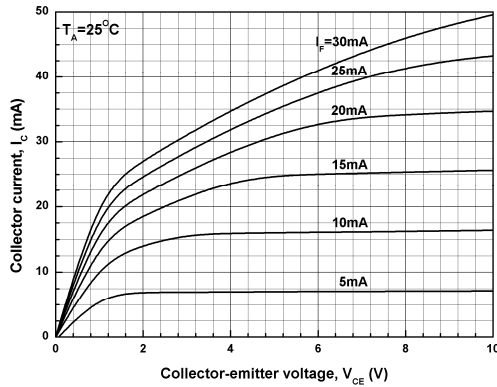

Figure 4. Relative Current Transfer Ratio vs Ambient Temperature

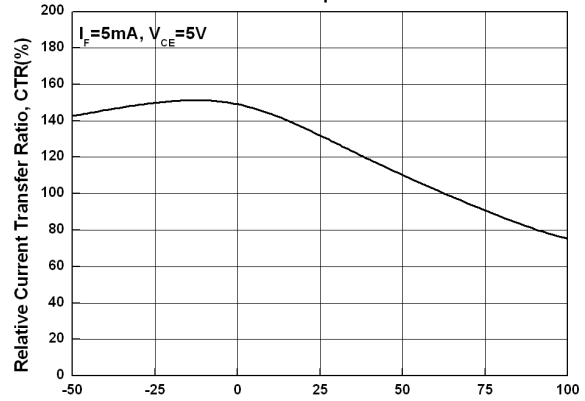
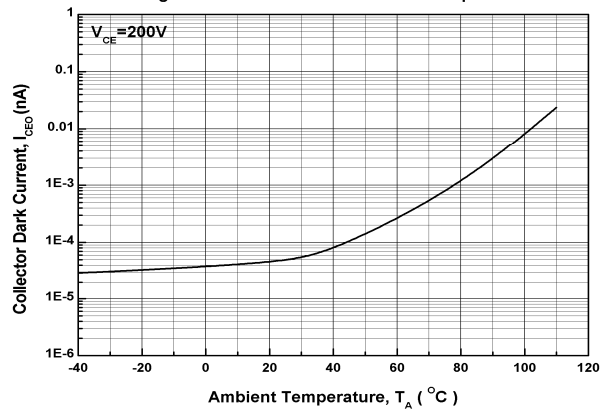
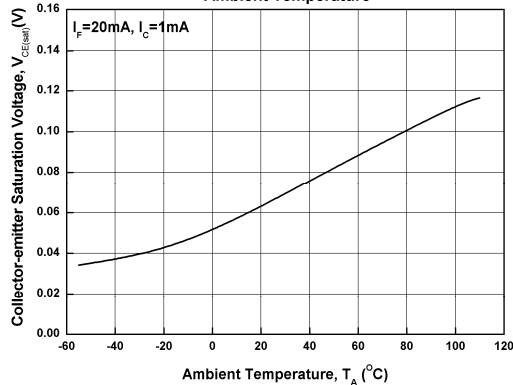

Figure 5. Collector-emitter Saturation Voltage vs Ambient Temperature



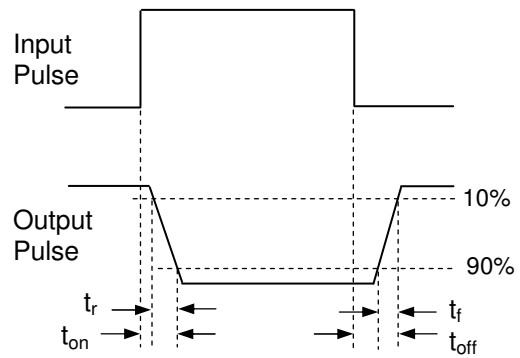
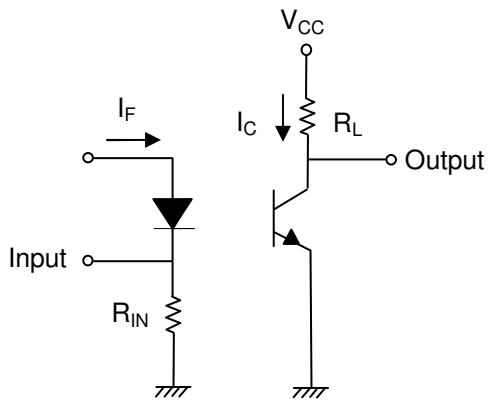
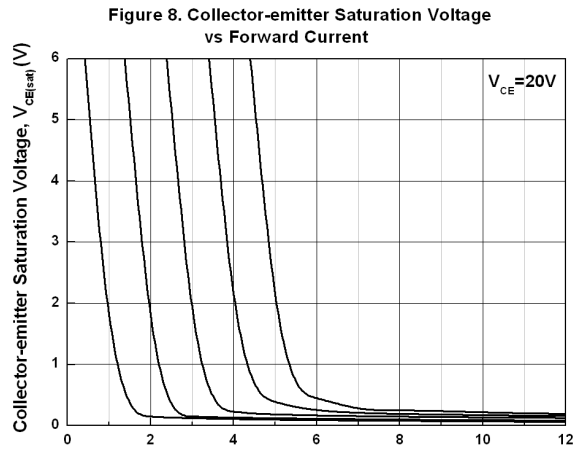
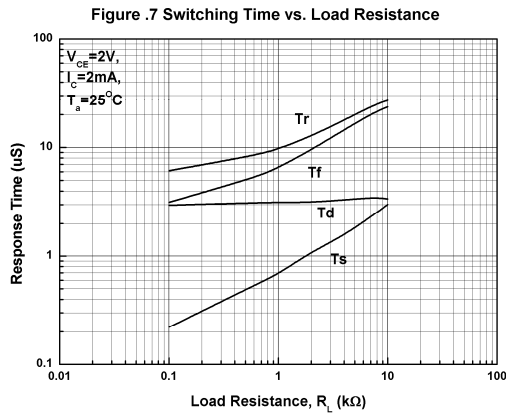

Figure 9. Switching Time Test Circuit & Waveforms

4 PIN DIP HIGH VOLTAGE PHOTOTRANSISTOR PHOTOCOUPLER

EL851 series

Order Information

Part Number

EL851Y(Z)-V

Note

- Y = Lead form option (S, S1, M or none)
Z = Tape and reel option (TA, TB, TU, TD or none)
V = VDE safety (optional)

Option	Description	Packing quantity
None	Standard DIP-4	100 units per tube
M	Wide lead bend (0.4 inch spacing)	100 units per tube
S (TA)	Surface mount lead form + TA tape & reel option	1000 units per reel
S (TB)	Surface mount lead form + TB tape & reel option	1000 units per reel
S1 (TA)	Surface mount lead form (low profile) + TA tape & reel option	1000 units per reel
S1 (TB)	Surface mount lead form (low profile) + TB tape & reel option	1000 units per reel
S (TU)	Surface mount lead form + TU tape & reel option	1500 units per reel
S (TD)	Surface mount lead form + TD tape & reel option	1500 units per reel
S1 (TU)	Surface mount lead form (low profile) + TU tape & reel option	1500 units per reel
S1 (TD)	Surface mount lead form (low profile) + TD tape & reel option	1500 units per reel

Package Drawings

(Dimensions in mm)

Standard DIP Type

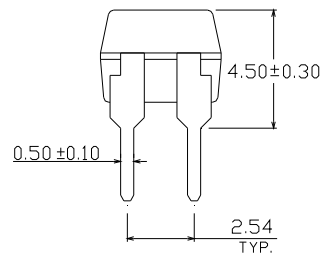
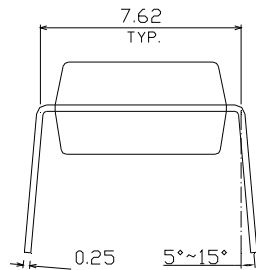
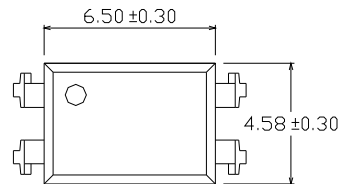

Option M Type

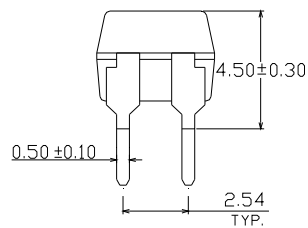
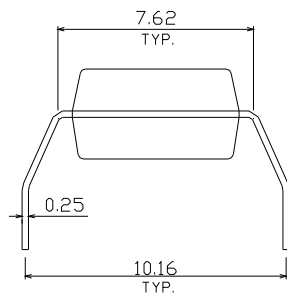
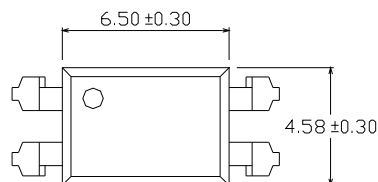

4 PIN DIP HIGH VOLTAGE PHOTOTRANSISTOR PHOTOCOUPLER

EL851 series

Option S Type

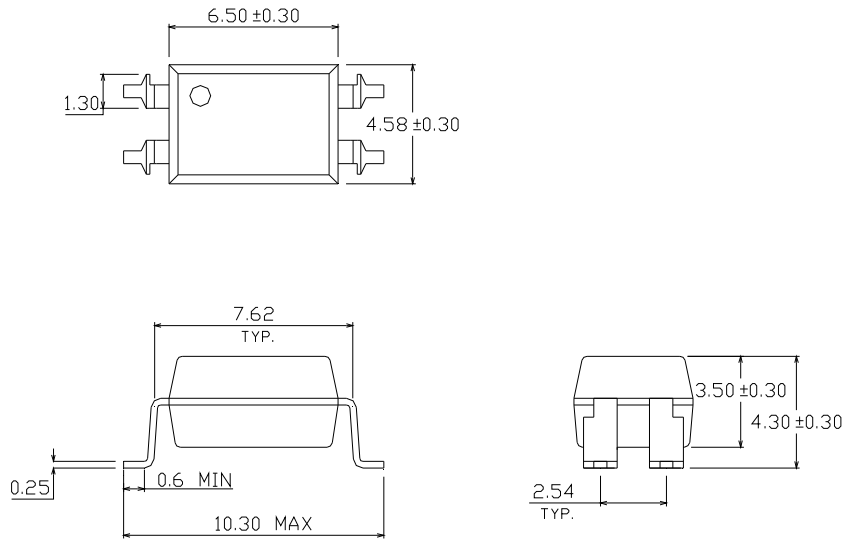

Option S1 Type

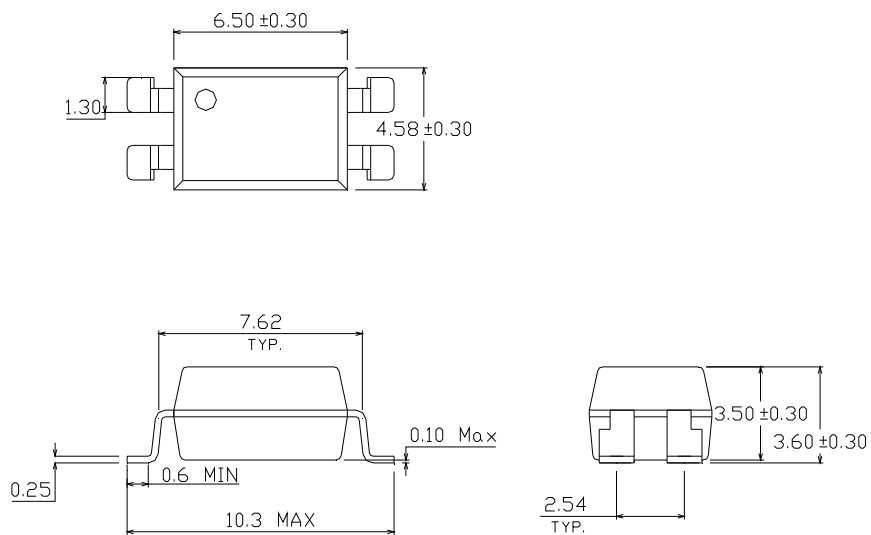

4 PIN DIP HIGH VOLTAGE PHOTOTRANSISTOR PHOTOCOUPLER

EL851 series

Recommended pad layout for surface mount leadform

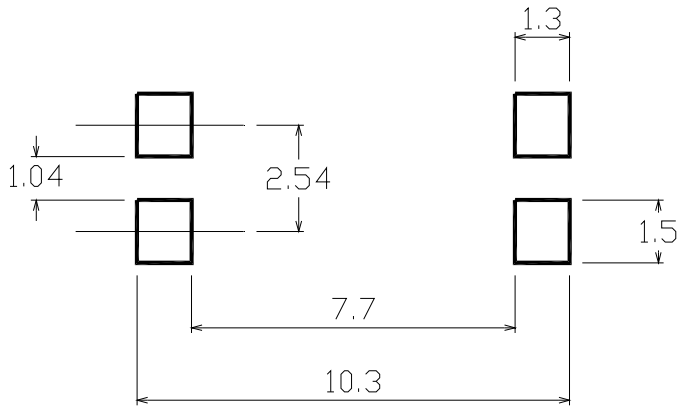

Device Marking

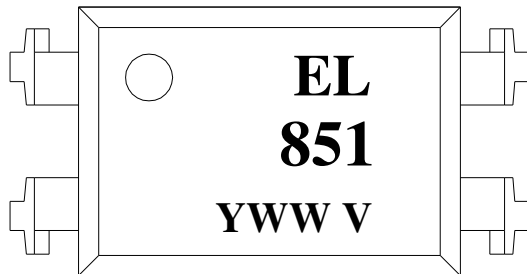

Notes

EL	denotes Everlight
851	denotes Part Number
Y	denotes 1 digit Year code
WW	denotes 2 digit Week code
V	denotes VDE safety

Tape & Reel Packing Specifications

Option TA

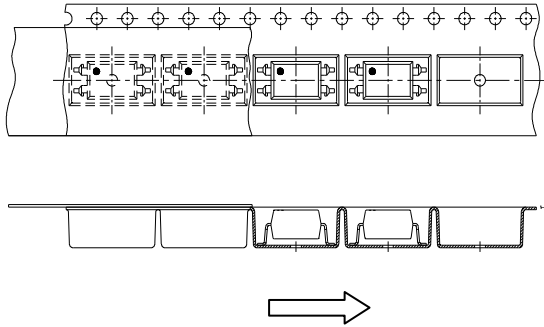

Direction of feed from reel

Option TB

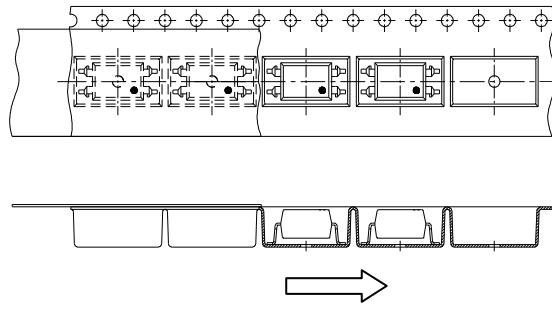

Direction of feed from reel

Tape dimensions

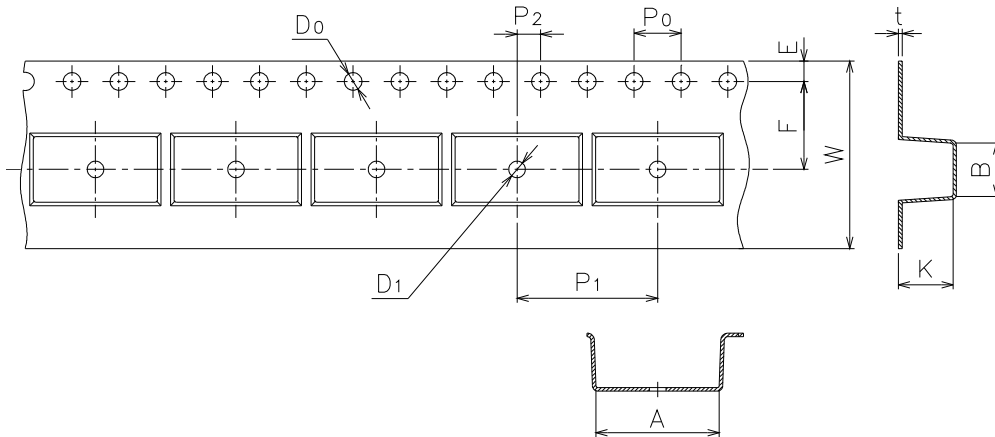

Dimension No.	A	B	Do	D1	E	F
Dimension(mm)	10.4±0.1	4.55±0.1	1.5±0.1	1.5±0.05	1.75±0.1	7.5±0.1
Dimension No.	Po	P1	P2	t	W	K
Dimension(mm)	4.0±0.1	12.0±0.1	2.0±0.1	0.33±0.1	16.0+0.3/ -0.1	4.55±0.1

4 PIN DIP HIGH VOLTAGE PHOTOTRANSISTOR PHOTOCOUPLER

EL851 series

Option TD

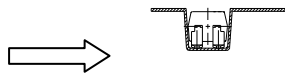
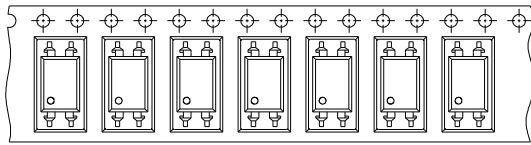

Direction of feed from reel

Option TU

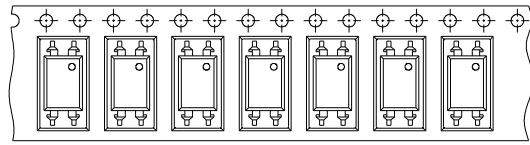

Direction of feed from reel

Tape dimensions

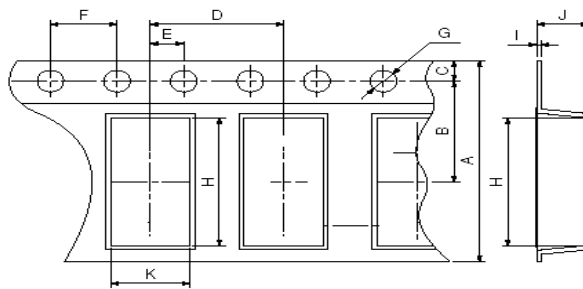

Dimension No.	A	B	C	D	E	F
Dimension(mm)	16.00±0.3	7.5±0.1	1.75±0.1	8.0±0.1	2.0±0.1	4.0±0.1
Dimension No.	G	H	I	J	K	
Dimension(mm)	1.5+0.1/-0	10.4±0.1	0.4±0.05	4.55±0.1	5.1±0.1	

Solder Reflow Temperature Profile

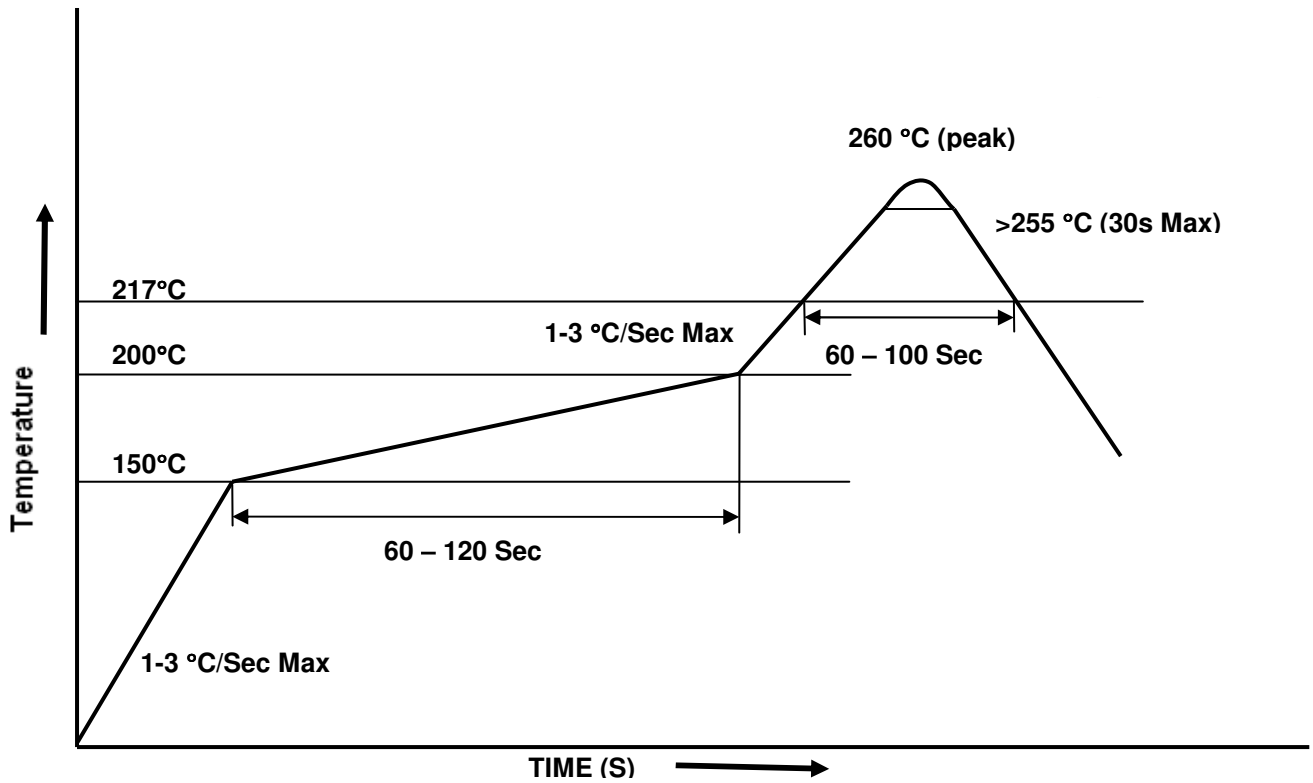

DISCLAIMER

1. The specifications in this datasheet may be changed without notice. EVERLIGHT reserves the authority on material change for above specification.
2. When using this product, please observe the absolute maximum ratings and the instructions for use as outlined in this datasheet. EVERLIGHT assumes no responsibility for any damage resulting from use of the product which does not comply with the absolute maximum ratings and the instructions included in this datasheet.
3. These specification sheets include materials protected under copyright of EVERLIGHT. Reproduction in any form is prohibited without the specific consent of EVERLIGHT.