

**SPECIFICATIONS**

- 1、Current Rating: 3A AC, DC
- 2、Voltage Rating: 250V AC, DC
- 3、Temperatuer Range: -25°C~+85°C
- 4、Contact Resistance: 20mΩ Max
- 5、Insulation Resistance: 1000MΩ Min
- 6、Withstanding Voltang: 800V AC/minute
- 7、Material: Wafer Nylon66, UL94V-0  
PIN Brass Tin-plated

编 号	尺寸 (mm)	
	A	B
HC-PHD-2*2A	2.00	6.00
HC-PHD-2*3A	4.00	8.00
HC-PHD-2*4A	6.00	10.00
HC-PHD-2*5A	8.00	12.00
HC-PHD-2*6A	10.00	14.00
HC-PHD-2*7A	12.00	16.00
HC-PHD-2*8A	14.00	18.00
HC-PHD-2*9A	16.00	20.00
HC-PHD-2*10A	18.00	22.00
HC-PHD-2*11A	20.00	24.00
HC-PHD-2*12A	22.00	26.00
HC-PHD-2*13A	24.00	28.00
HC-PHD-2*14A	26.00	30.00
HC-PHD-2*15A	28.00	32.00
HC-PHD-2*16A	30.00	34.00
HC-PHD-2*17A	32.00	36.00
HC-PHD-2*18A	34.00	38.00
HC-PHD-2*19A	36.00	40.00
HC-PHD-2*20A	38.00	42.00

**PCB LAYOUT**

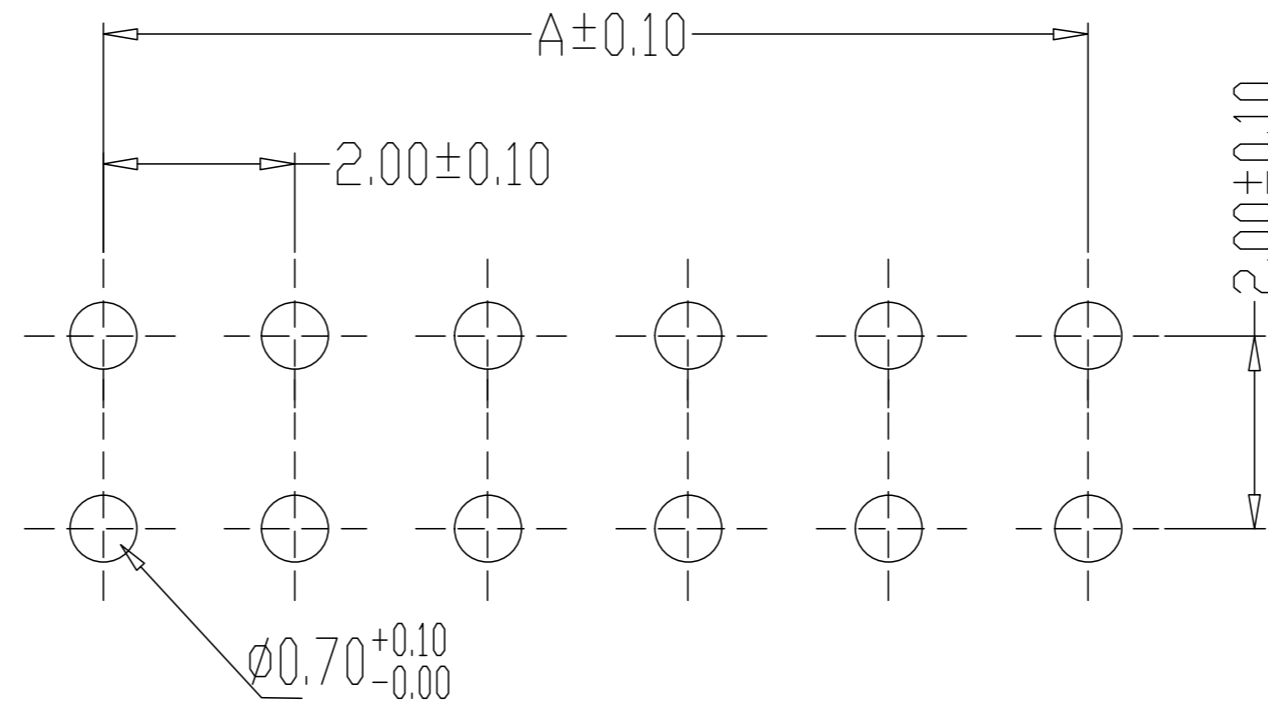
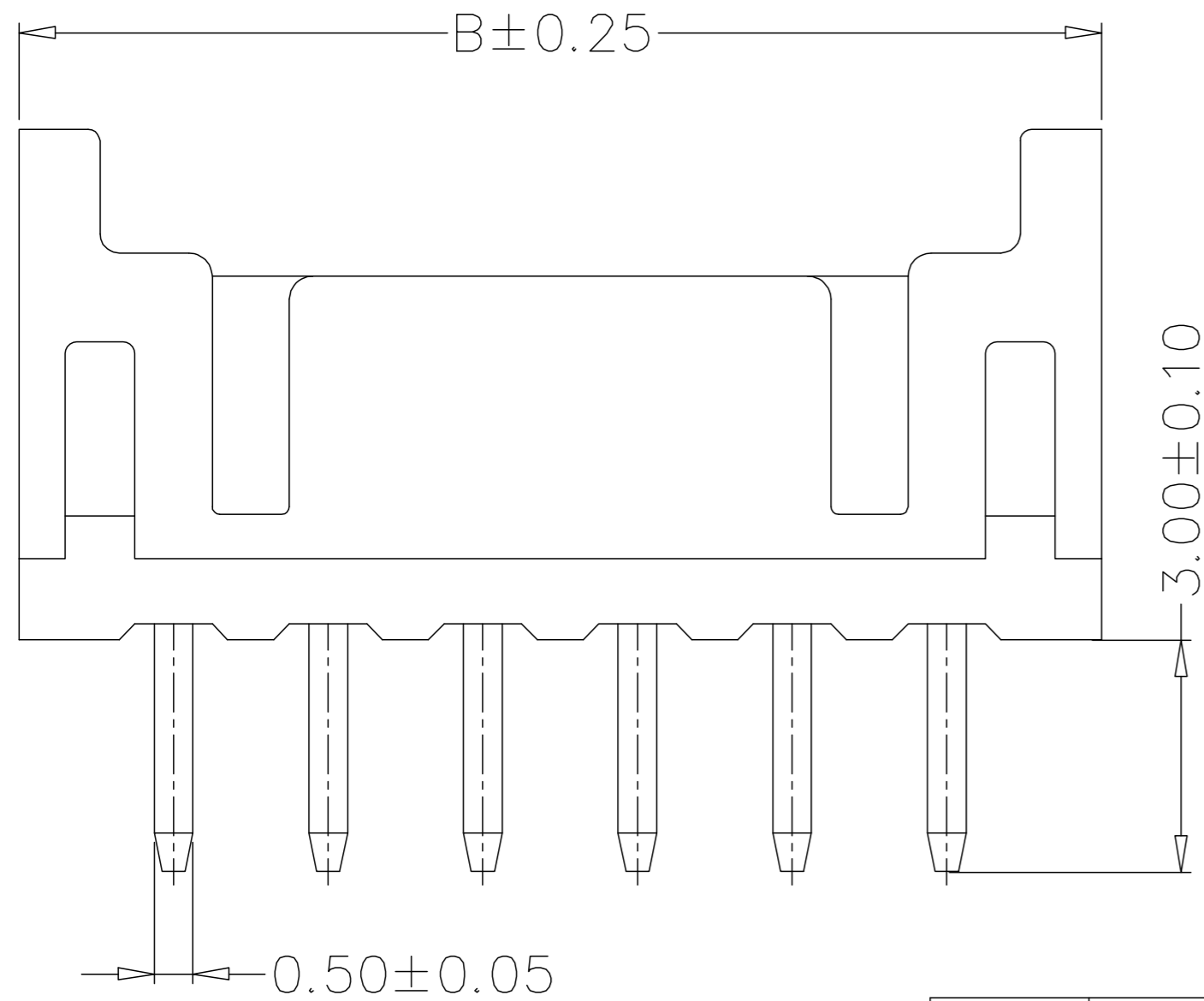
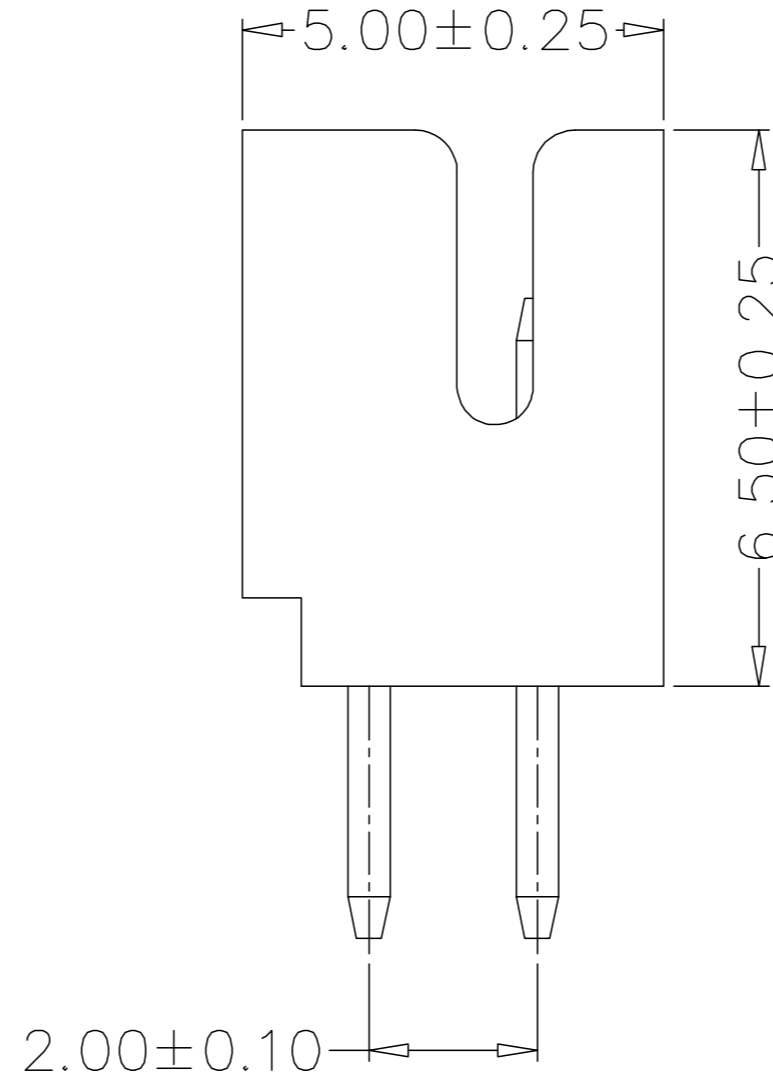
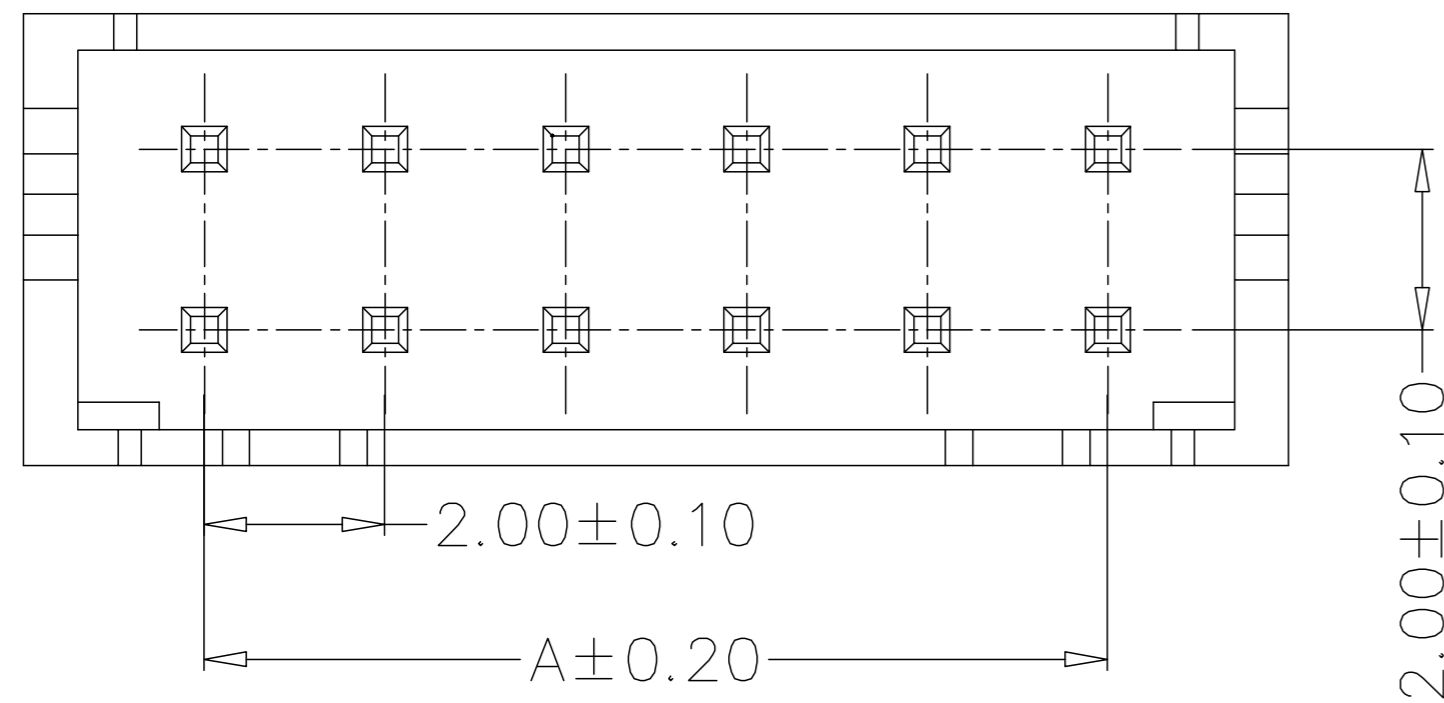

制图 DRAWN	变更内容 DESCRIPTION	日期 DATE	GENERAL TOLERANCE		制图 DRAWING	钱岳生			料号 PART NO.	HC-PHD-2*NAW		版本 REV.	A		
			X.±0.25	X.°±2°		审核 CHECK	2013、07、01			品名 TITLE	PHD弯针				
			.X±0.20	.X°±1°			2013、07、03				WAFER DIP TYPE				
			.XX±0.15	.XX°±0.5°			核准 APPROVAL	2013、07、05			客户料号 CUTM. NO.				
.XXX±0.10	.XXX°±0.5°	单位 UNITS	MM	比例 SCALE	1:1										
											深圳市华灿天禄电子有限公司				