

HSF

Recommended P.C.B Layout(Top Side)
(PCB BOARD TOLERANCE±0.05)

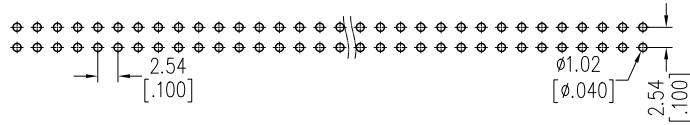

NOTES:

Current Rating: 3.0AMP
 Contact Resistance: 20mΩ Max
 Withstand Voltage: 1000V AC/DC \triangle
 Insulation Resistance: 1000MΩ Min
 Operation Temperature: -40℃ to +105℃

Contact Material: Brass \triangle
 Contact plating: Au Or Sn over Ni
 Insulator Material: PA9T Or PBT+30%G.F UL94V-0

06P-18P Without Slot "A" and "B"
 20P-58P Without Slot "A", With Slot "B"
 60P-64P With Slot "A" and "B"

Ordering Information

3210 - XX R XX X X X X 1

No. of Pins	Contact Plating	Insulator Color	Latch Type	Packing
06 24	G0=Gold Flash	B=Black	L=Long Latch	A=Tray
08 26	G3=10u"Gold	G=Grey(427C)	S=Short Latch	T=Tube
10 30	G4=15u"Gold		N=Without Latch	
12 34	G5=30u"Gold			
14 40	S0=Gold Flash/Tin			
16 50	S3=10u"Gold/Tin			
18 60	S4=15u"Gold/Tin			
20 64	S5=30u"Gold/Tin			
	SN=Tin			

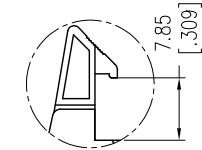
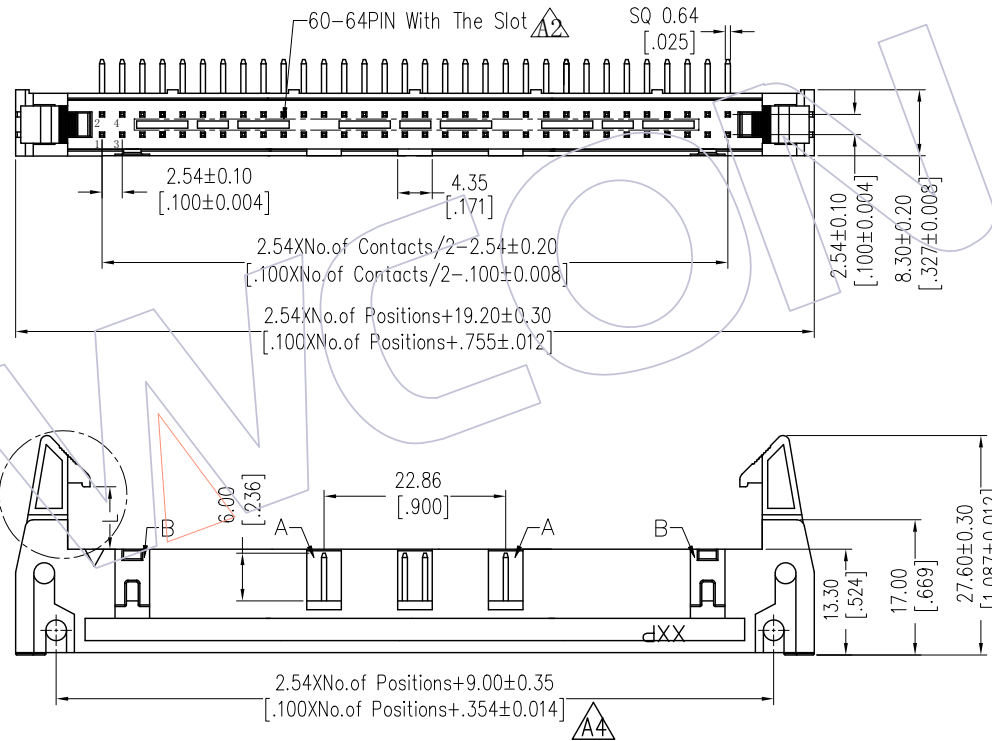

Long Latch



Short Latch

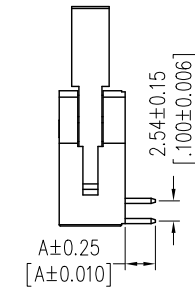

Item	Pitch	Mating
Standard	2.54	5211
Alternate		

Item	DIM.A
Standard	3.80
Alternate	---

A4	2019/01/04	MODIFY	\triangle A4	OPERATION	DRAW	DATE	SCALE	FIT	PART NO.
A3	2014/12/03	MODIFY	\triangle A3	x.x ±0.40	Ding	2019/01/04	UNIT	mm	3210-XXRXXXXX1
A2	2013/02/25	MODIFY	\triangle A2	x.xx ±0.25	CHECK	DATE	SIZE	A4	TITLE:
A0	2012/10/08	NEW	---	x.xxx ±0.15	APPROVE	DATE	SHEET	1/1	2.54 EJECTOR HEADER 90° DIP
REV	DATE	MODIFICATION DESCRIPTION	CHANGE	Angle ± 3°			PROJ.		Customer NO.
				DIM TOL					

WCON
 Http: www.wcon.com

WCON-Dongguan
 Tel: +86 769 85358920
 Fax: +86 769 85358915
 E-mail: sales@wcon.com

WCON-Kunshan
 Tel: +86 512 57468408
 Fax: +86 512 57468468
 E-mail: salesks@wcon.com