

## CTSLF1275F Series

From 1.2 $\mu$ H to 220 $\mu$ H



### SPECIFICATIONS

Part numbers are marked to indicate inductance tolerance available.  
M =  $\pm 20\%$ , N =  $\pm 30\%$

Part Number	Inductance ( $\mu$ H)	L Test Freq. (kHz)	DCR $\pm 20\%$ ( $\Omega$ )	Rated DC (A)	Itemp Max. (A)
CTSLF1275F-1R2N	1.2	1.0	0.0069	13	8.2
CTSLF1275F-2R7N	2.7	1.0	0.0094	10	7.0
CTSLF1275F-3R9N	3.9	1.0	0.0104	9.0	6.7
CTSLF1275F-5R6N	5.6	1.0	0.0116	7.8	6.3
CTSLF1275F-6R8N	6.8	1.0	0.0131	7.2	5.9
CTSLF1275F-100M	10	1.0	0.0156	5.5	5.4
CTSLF1275F-150M	15	1.0	0.0184	4.7	5.0
CTSLF1275F-220M	22	1.0	0.0263	4.0	4.0
CTSLF1275F-330M	33	1.0	0.0395	3.2	3.4
CTSLF1275F-470M	47	1.0	0.0528	2.7	3.0
CTSLF1275F-680M	68	1.0	0.0778	2.0	2.4
CTSLF1275F-101M	100	1.0	0.125	1.9	1.9
CTSLF1275F-151M	150	1.0	0.175	1.5	1.6
CTSLF1275F-221M	220	1.0	0.258	1.3	1.3

### PHYSICAL DIMENSIONS

Size	A	B	C	D	E	F
mm	12.5 $\pm$ 0.3	12.5 $\pm$ 0.3	7.5 $\pm$ 0.35	Typ. 8.6	Typ. 2.0	Typ. 3.0
inches	0.49 $\pm$ 0.012	0.49 $\pm$ 0.012	0.30 $\pm$ 0.014	0.339	0.079	0.118

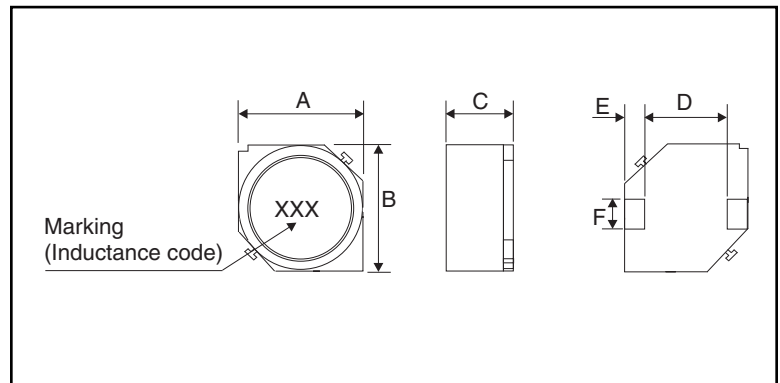

### CHARACTERISTICS

- Description:** SMD (shielded) power inductor
- Applications:** For power source circuits, low profile type DC to DC converters, DC to AC inverters etc.
- Operating Temperature:** -40°C to +125°C
- Inductance Tolerance:**  $\pm 20\%$  &  $\pm 30\%$
- Testing:** Inductance is tested on a HP4284A at 1.0 kHz, 0.5V
- IDC Current:** Value obtained when DC current flows and the initial value of inductance has fallen by 10%
- Itemp Current:** Value obtained when current flows and the temperature has risen to 40°C
- Packaging:** Tape & Reel
- Marking:** Parts are marked with inductance code
- Miscellaneous:** RoHS compliant. Magnetically shielded
- Additional Information:** Additional electrical & physical information available upon request
- Samples available. See website for ordering information.**

### PAD LAYOUT

