

# ZMW Series Mini Size Snap-acting Switches



## Features/Benefits

- Long & adequate stroke setting for high reliability & insulation
- Silent actuation for reduced audible click
- Compact size – ideal when space is limited
- Twin contacts design – sliding contacts prevent pollution of foreign materials
- IP67 for standalone switch except the metal terminal part; Full IP67 protection when potted with wire version
- RoHS compatible & compliant

## Typical Applications

- Industrial
- Home appliances
- Automotive: door latch, seat position detection, EV charging

## Specifications

CONTACT RATING: 100mA 30VDC @ 300,000 cycles min.  
50mA 16VDC @ 500,000 cycles min.  
1mA 5VDC @ 500,000 cycles min.

MECHANICAL LIFE: 500,000 cycles min.

INSULATION RESISTANCE: 100 M ohm min.

DIELECTRIC STRENGTH: Min. 600VAC (50-60Hz)/minute  
between Live Parts

OPERATING TEMPERATURE: -40°C to 85°C

OPERATING FORCE: 150 gf max.

## Materials

CASE: Nylon

COVER: PBT

ACTUATOR BUTTON: POM

MOVABLE CONTACTS: Silver alloy or gold plated

STATIONARY CONTACTS: Silver alloy or gold plated

TERMINALS: Brass, silver plated.

**NOTE:** Specifications and materials listed above are for switches with standard options. For information on specific and custom switches, consult Customer Service Center.

⚠ Sealing cap could possibly be damaged in case of contacts with oils or greases. Please try to avoid direct contact. If more support is needed, consult Customer Service Centre.

## Build-A-Switch

Our easy build-a-switch concept allows you to mix and match options to create the switch you need. To order, select desired option from each category and place it in the appropriate box.

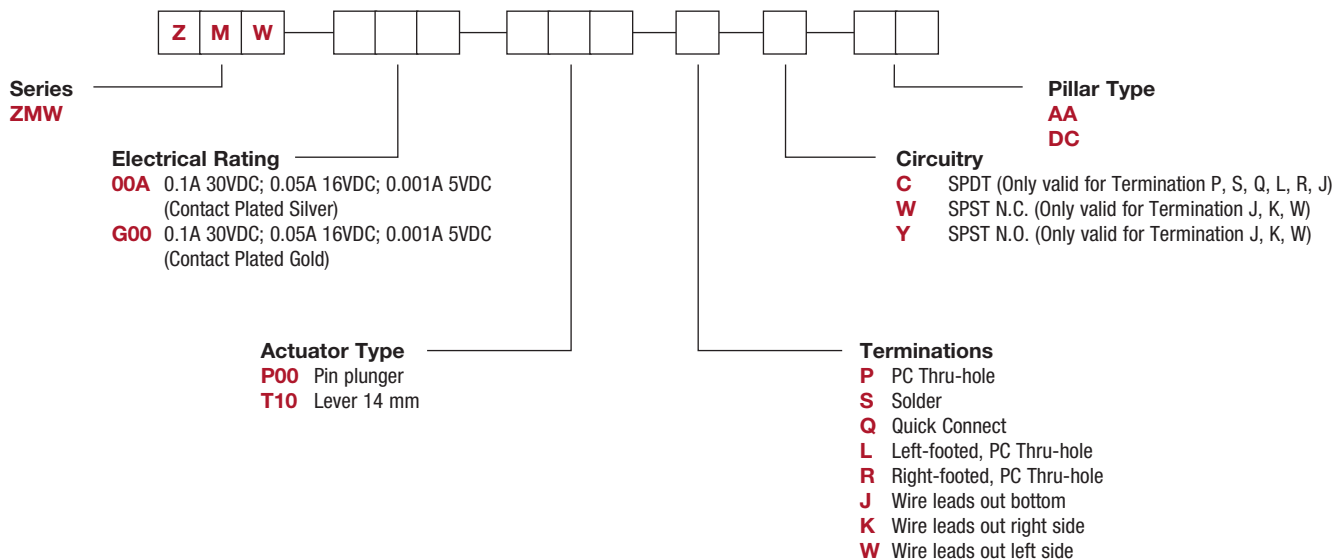

# ZMW Series Mini Size Snap-acting Switches

## SERIES

**ZMW** MINI SIZE SNAP-ACTING SWITCHES

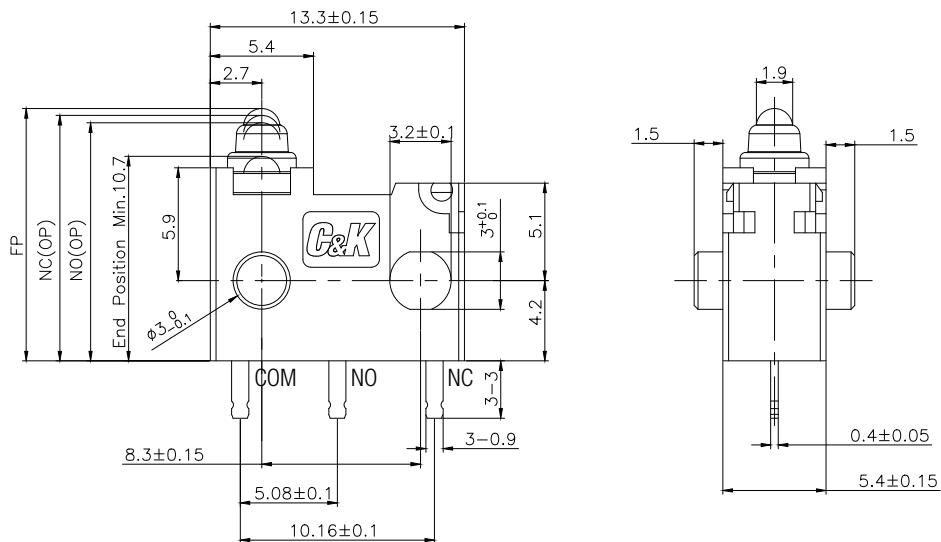

MOUNTING HOLES

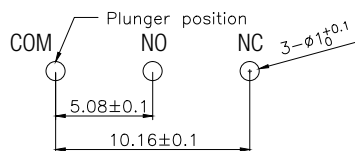

## ACTUATOR TYPE

**P00** PIN PLUNGER

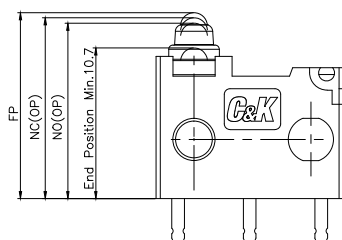

**T10** LEVER  
14 MM

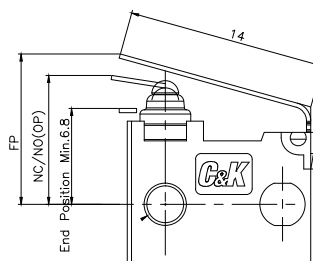

Snap-acting

# ZMW Series Mini Size Snap-acting Switches

## TERMINATIONS

**P** PC THRU-HOLE

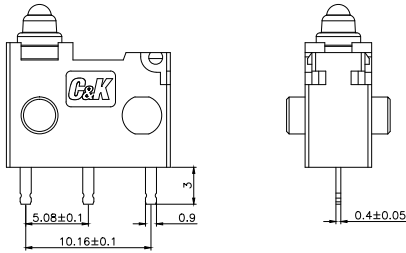

**S** SOLDER

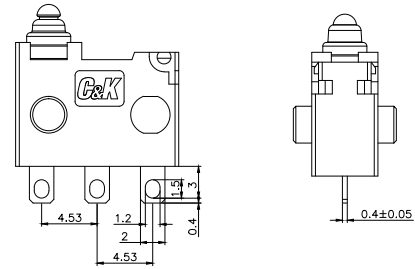

**Q** QUICK CONNECT

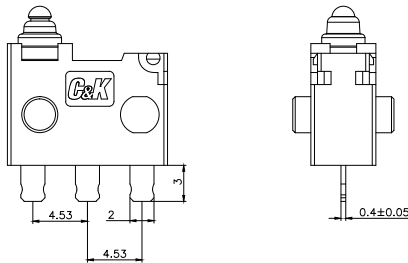

**L** LEFT-FOOTED,  
PC THRU-HOLE

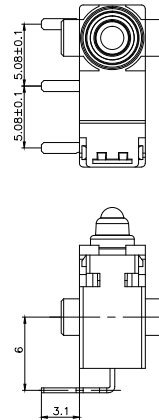

**R** RIGHT-FOOTED,  
PC THRU-HOLE

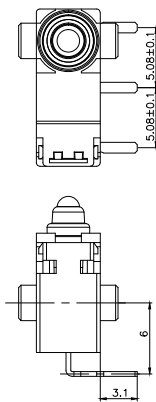

**J** WIRE LEADS OUT BOTTOM

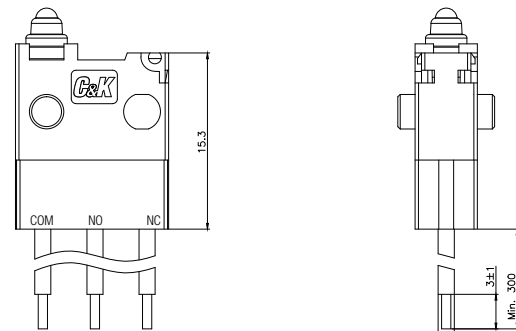

**K** WIRE LEADS OUT RIGHT SIDE

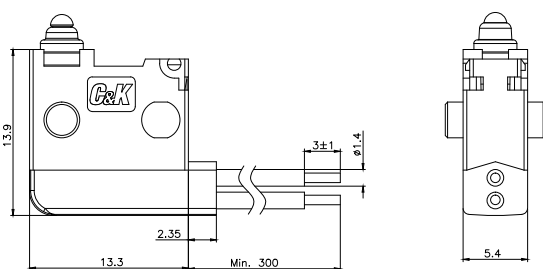

**W** WIRE LEADS OUT LEFT SIDE

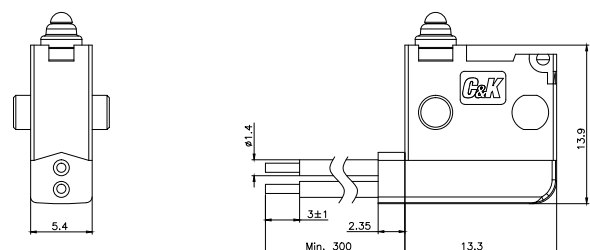

COM: AVSS 0.3 MM<sup>2</sup> BLACK OR EQUIVALENT  
NO: AVSS 0.3 MM<sup>2</sup> BLUE OR EQUIVALENT  
NC: AVSS 0.3 MM<sup>2</sup> GRAY OR EQUIVALENT

Dimensions are shown: mm  
Specifications and dimensions subject to change

# ZMW Series Mini Size Snap-acting Switches

## SWITCH CHARACTERISTICS

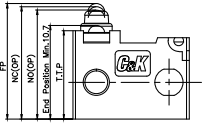
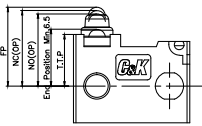
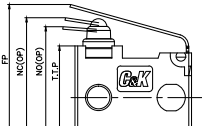
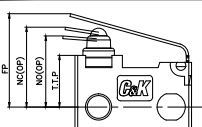
SWITCH TYPE	PART SUFFIX	OF Max (gf)	FP Max (mm)	NC-OP (mm)	NO-OP (mm)	NC-OT Min.(mm)	NO-OT Min. (mm)	
ZMWXXP00XXXX	 Datum from Bottom	S	153	13.4	12.9±0.3	12.6±0.3	2.5	2.2
	 Datum from Centre			9.2	8.7±0.3	8.4±0.3		
ZMWXXT10XXXX	 Datum from Bottom	S	185	15.7	14.0±0.6	13.45±0.6	3.0	2.45
	 Datum from Centre			11.5	9.8±0.6	9.25±0.6		

## PILLAR TYPE

DC

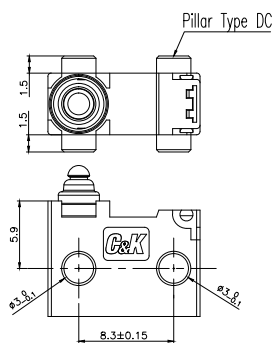

AA

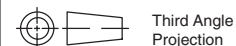
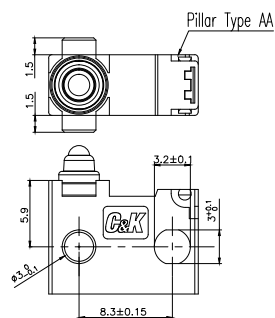

Dimensions are shown: mm  
Specifications and dimensions subject to change



Snap-acting