

DC Pass Bi-Directional Coupler

ZABDC20-252H+

50Ω Up to 100W 800 to 2500 MHz

Maximum Ratings

Operating Temperature	-55°C to 100°C
Storage Temperature	-55°C to 100°C
DC Current	2.0 A

* Case temperature is defined as temperature on ground leads. Permanent damage may occur if any of these limits are exceeded.

Coaxial Connections

INPUT	1
OUTPUT	4
COUPLED (forward)	2
COUPLED (reverse)	3

Outline Drawing

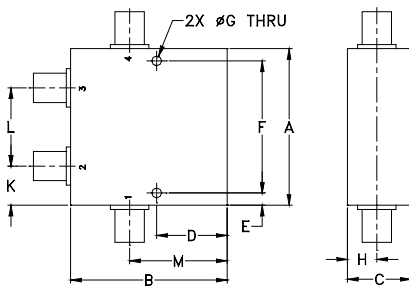

Outline Dimensions (inch/mm)

A	B	C	D	E	F	G			
2.00	2.00	.88	.90	.156	1.688	.125			
50.80	50.80	22.35	22.86	3.96	42.88	3.18			
H	J	K	L	M			wt		
.38	---	.50	1.00	1.25			grams		
9.65	---	12.70	25.40	31.75			225		

Features

- excellent mainline loss, 0.17 dB typ.
- excellent directivity, 28 dB typ.
- high power, up to 100W
- rugged shielded case
- DC current through input to output 2.0A Max. at 50 watt RF input power

Applications

- PCS/DCS/UMTS
- power leveling & monitoring
- VSWR measurement

Bi-Directional Coupler Electrical Specifications

FREQ. (MHz)	COUPLING (dB)		MAINLINE LOSS ¹ (dB)		DIRECTIVITY (dB)		VSWR (:1)	POWER INPUT (W)		
	Norm.	Flatness	Typ.	Max.	Typ.	Min.		Typ.	Max.	
f_L - f_U										
800-2500			0.20	0.35			28	20	1.05	50
800-1000	23±1.0	±0.9	0.15	0.25	30	23	1.05		100	
1300-2500	19.7±0.7	±0.75	0.20	0.35	28	20	1.05		50	

1. Mainline loss includes theoretical power loss at coupled port.

Typical Performance Data

Frequency (MHz)	Mainline Loss (dB)	Coupling (dB)		Directivity (dB)		Return Loss (dB)			
		In-Out	In-Cpl Fwd	Out-Cpl Rev	Out-Cpl Fwd	In-Cpl Rev	In	Out	Cpl Fwd
800.00	0.11	23.88	23.85	32.78	36.66	39.78	35.40	47.06	42.20
1000.00	0.12	22.32	22.28	30.17	32.23	39.27	35.77	38.27	37.38
1200.00	0.13	21.22	21.15	31.42	32.87	35.59	36.09	34.59	34.96
1400.00	0.15	20.43	20.38	35.46	36.13	32.74	34.79	33.78	35.02
1600.00	0.17	19.92	19.86	42.35	35.55	30.21	33.34	31.94	33.00
1800.00	0.19	19.63	19.58	32.79	29.28	29.43	33.84	33.22	32.26
2000.00	0.20	19.58	19.54	28.91	26.99	30.64	33.90	36.72	35.98
2200.00	0.21	19.77	19.73	28.11	26.09	31.14	35.70	41.69	36.37
2400.00	0.21	20.21	20.16	27.14	25.13	35.33	36.16	49.29	35.25
2500.00	0.21	20.53	20.48	27.45	24.97	37.60	37.56	38.44	34.58

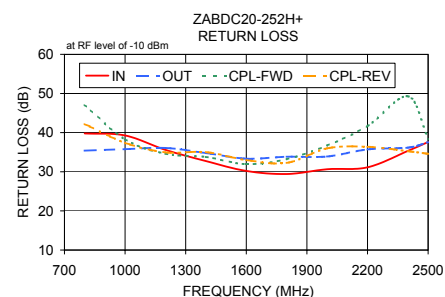
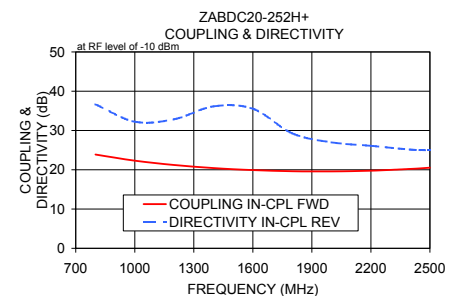
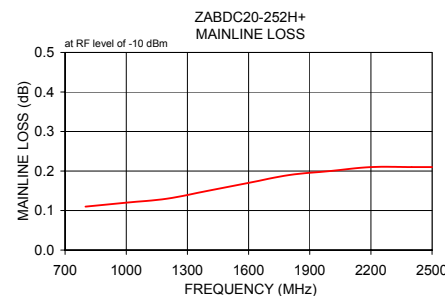

Electrical Schematic

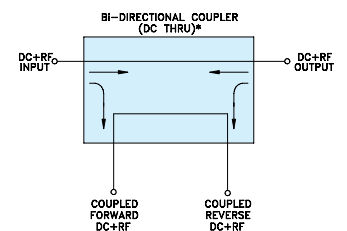

* ELECTRICAL SCHEMATIC IS FOR BI-DIRECTIONAL COUPLER WITHOUT INTERNAL TRANSFORMERS AND RESISTORS.

Notes

- Performance and quality attributes and conditions not expressly stated in this specification document are intended to be excluded and do not form a part of this specification document.
- Electrical specifications and performance data contained in this specification document are based on Mini-Circuit's applicable established test performance criteria and measurement instructions.
- The parts covered by this specification document are subject to Mini-Circuits standard limited warranty and terms and conditions (collectively, "Standard Terms"); Purchasers of this part are entitled to the rights and benefits contained therein. For a full statement of the Standard Terms and the exclusive rights and remedies thereunder, please visit Mini-Circuits' website at www.minicircuits.com/WCLStore/terms.jsp

