

DWG. NO.		260-910-0631G	
REV	DESCRIPTION	BY DATE	APPD
B	ECR 8576	MSJ 06/15/05	DCM

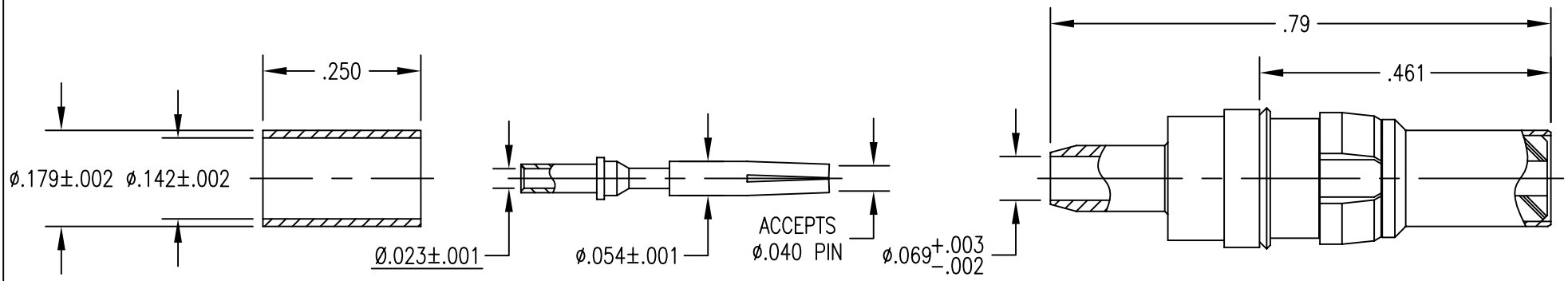

NOTES:

- MATERIALS:
 BODY AND FERRULE: BRASS PER ASTM B16
 CONTACT: BERYLLIUM COPPER PER ASTM B196
 INSULATOR: TEFLON PER ASTM D1710
 SPRING WASHER: PHOSPHOR BRONZE PER ASTM B103
- FINISH:
 BODY AND FERRULE: .000030 MIN. GOLD PER MIL-G-45204
 OVER .000050 MIN. NICKEL PER QQ-N-290
 FERRULE AND SPRING WASHER: .000005 MIN. GOLD PER MIL-G-45204
 OVER .000050 MIN. NICKEL PER QQ-N-290
 CLIP RING: .000100 MIN. NICKEL PER QQ-N-290 OVER COPPER FLASH
- FOR ASSEMBLY USE CAP 9-07 WITH ABOVE TRIM DIMENSIONS.
- FOR USE WITH RD316 OR EQUIVALENT.

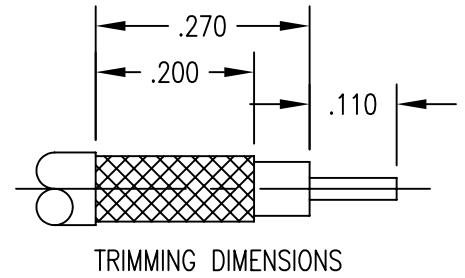

PER ASME Y14.5M-1994 UNLESS OTHERWISE SPECIFIED: DIMENSIONS ARE IN INCHES OR INCHES/MILLIMETER TOLERANCES: DECIMALS .XX ± .01/0.254 .XXX ± .005/0.127 ANGLES ± 2° SCALE: 4:1				Litton Winchester Electronics/RETCONN <small>400 Park Road Watertown, Connecticut 06795</small>			
CUSTOMER DRAWING				TITLE			
RDM PLUG, CRIMP/CRIMP CAPTIVE CENTER CONTACT							
DRAWN	DATE	CHECKED	DATE	A	260-910-0631G	SHT. 1 OF 1	REV. B
GCP	01/04/05						
APPROVED	DATE	APPROVED	DATE				
CCA	01/05/05						