

Micro-D Backshells

EMI, Banding, Elliptical, Split, 507-178



Split Backshell With Elliptical Cable Entry provides added room for larger wire bundles. Terminate cable shields with **BAND-IT**® microbands.

Floating Jackscrews allow the connectors to be mated prior to engaging the screws.

Rugged Aluminum housing with stainless steel hardware, available in standard nickel plating, or choose optional finishes.

HOW TO ORDER 507-178 EMI BACKSHELLS

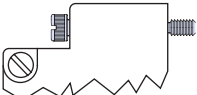
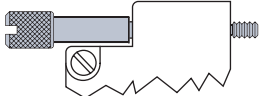
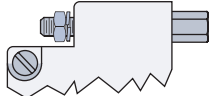
| Series | Shell Finish | Connector Size | Cable Entry Code | | | EMI Band Strap Option | Hardware Option | |
|---------|-------------------------------------|----------------|------------------|--------|-------------------|--------------------------------------|--|---|
| 507-178 | E – Chem Film (Alodyne) | 09 | D | In. | mm. | OMIT- Band Strap Not Supplied | Omit for Slot Head Low Profile Jackscrew | |
| | | 15 | | | | | | |
| | J – Cadmium, Yellow Chromate | 21 | Code | ± .010 | ± 0.25 | Available on Shell Size | B – Microband Supplied (600-057) |  |
| | | 25 | | | | | | |
| | M – Electroless Nickel | 31 | 05 | .312 | 7.92 | 15 Thru 31 | K – Coiled Microband Supplied (600-057-1) | H – Hex Head Jackscrew |
| | | 37 | 06 | .375 | 9.53 | 21 Thru 51 | | |
| | NF – Cadmium, Olive Drab | 51 | 07 | .437 | 11.10 | 25 Thru 51 | E – Extended Jackscrew |  |
| | | 51-2 | 08 | .500 | 12.70 | 25 Thru 51 | | |
| | Z2 – Gold | 67 | 09 | .562 | 14.27 | 31 Thru 100 | FF – Jackpost, Female |  |
| | | 69 | 10 | .625 | 15.88 | 31 Thru 100 | | |
| | | 100 | 11 | .688 | 17.48 | 37 Thru 100 | | |
| | | 12 | .750 | 19.05 | 37 Thru 100 | | | |
| | | 13 | .812 | 20.62 | 37,51-2,67,69,100 | | | |
| | | 14 | .875 | 22.23 | 51-2, 67, 69, 100 | | | |
| | | 15 | .938 | 23.83 | 51-2, 67, 69, 100 | | | |
| | | 16 | 1.000 | 25.40 | 51-2, 67, 69, 100 | | | |

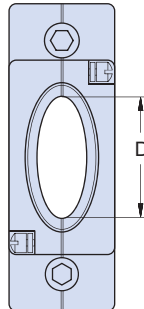

Sample Part Number

507-178 M 25 06

MATERIALS (SEE ORDERING INFO FOR FINISH OPTIONS)

| | |
|--------------------------------|--|
| Shell, Saddle Clamps | Aluminum Alloy 6061 -T6 Per QQ-A-200, QQ-A-225 (Machined Components) Aluminum Alloy 6061-T6 Per QQ-A-591 (A380) (Die-Cast Components) |
| Clips | 17-7PH Stainless Steel |
| Jackscrews, Washers, Jackposts | 300 Series Stainless Steel, Passivated |

| CABLE ENTRY | | | |
|-------------|-----------|-----------|-------------------------|
| Code | D | | Available on Shell Size |
| | In. ±.010 | mm. ±0.25 | |
| 04 | .250 | 6.35 | 09, 15, 21 |
| 05 | .312 | 7.92 | 15 Thru 31 |
| 06 | .375 | 9.53 | 21 Thru 51 |
| 07 | .437 | 11.10 | 25 Thru 51 |
| 08 | .500 | 12.70 | 25 Thru 51 |
| 09 | .562 | 14.27 | 31 Thru 100 |
| 10 | .625 | 15.88 | 31 Thru 100 |
| 11 | .688 | 17.48 | 37 Thru 100 |
| 12 | .750 | 19.05 | 37 Thru 100 |
| 13 | .812 | 20.62 | 37,51-2,67,69,100 |
| 14 | .875 | 22.23 | 51-2, 67, 69, 100 |
| 15 | .938 | 23.83 | 51-2, 67, 69, 100 |
| 16 | 1.000 | 25.40 | 51-2, 67, 69, 100 |

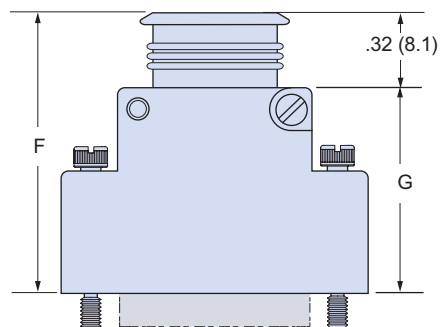
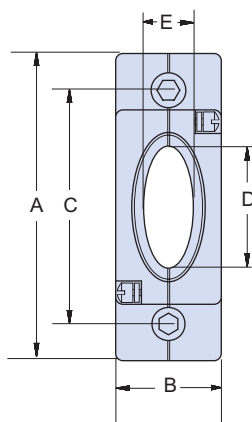

NO DESIGNATOR
SLOT HEAD
LOW PROFILE

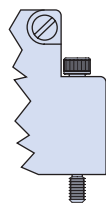

CODE H
HEX HEAD
JACKSCREW

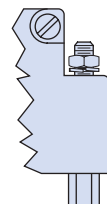

CODE FF
FEMALE
JACKPOST

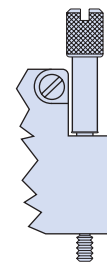

CODE E
EXTENDED
JACKSCREW

DIMENSIONS

| Size | A Max. | | B Max. | | C | | E | | F Max. | | G Max. | |
|------|--------|-------|--------|-------|-------|-------|-----------|-----------|--------|-------|--------|-------|
| | In. | mm. | In. | mm. | In. | mm. | In. ±.010 | mm. ±0.25 | In. | mm. | In. | mm. |
| 09 | .915 | 23.24 | .450 | 11.43 | .565 | 14.35 | .160 | 4.06 | 1.033 | 26.24 | .721 | 18.31 |
| 15 | 1.065 | 27.05 | .450 | 11.43 | .715 | 18.16 | .190 | 4.83 | 1.096 | 27.84 | .783 | 19.89 |
| 21 | 1.215 | 30.86 | .450 | 11.43 | .865 | 21.97 | .220 | 5.59 | 1.127 | 28.63 | .815 | 20.70 |
| 25 | 1.315 | 33.40 | .450 | 11.43 | .965 | 24.51 | .260 | 6.60 | 1.190 | 30.23 | .877 | 22.28 |
| 31 | 1.465 | 37.21 | .450 | 11.43 | 1.115 | 28.32 | .275 | 6.99 | 1.221 | 31.01 | .908 | 23.06 |
| 37 | 1.615 | 41.02 | .450 | 11.43 | 1.265 | 32.13 | .285 | 7.24 | 1.283 | 32.59 | .971 | 24.66 |
| 51 | 1.565 | 39.75 | .495 | 12.57 | 1.215 | 30.86 | .350 | 8.89 | 1.346 | 34.19 | 1.033 | 26.24 |
| 51-2 | 1.965 | 49.91 | .450 | 11.43 | 1.615 | 41.02 | .350 | 8.89 | 1.346 | 34.19 | 1.033 | 26.24 |
| 67 | 2.365 | 60.07 | .450 | 11.43 | 2.015 | 51.18 | .350 | 8.89 | 1.346 | 34.19 | 1.033 | 26.24 |
| 69 | 1.865 | 47.37 | .495 | 12.57 | 1.515 | 38.48 | .350 | 8.89 | 1.346 | 34.19 | 1.033 | 26.24 |
| 100 | 2.305 | 58.55 | .540 | 13.72 | 1.800 | 45.72 | .490 | 12.45 | 1.408 | 35.76 | 1.096 | 27.83 |