

6

5

4

3

2

1

APPROVED: \_\_\_\_\_  
 DATE: \_\_\_\_\_ TITLE: \_\_\_\_\_

Rev	AWO #	Description	Date	Appr
-		RELEASED	7/31/09	
A		REVISED SPEC.	05/15/12	

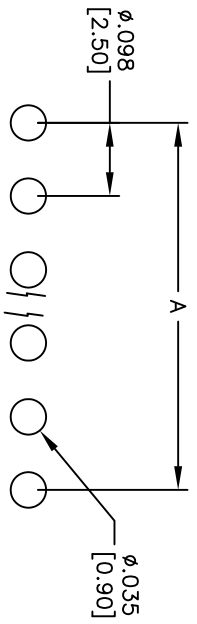
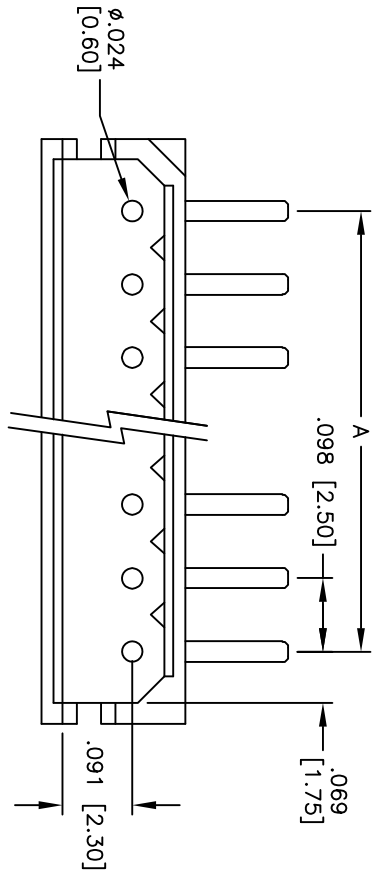

RECOMMENDED PCB LAYOUT

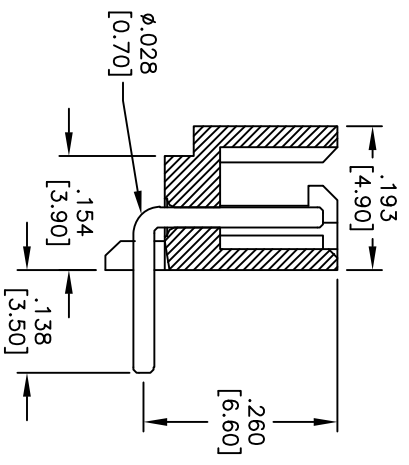
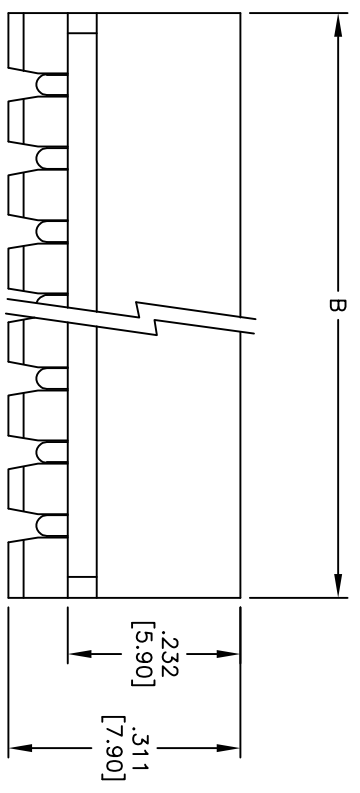

**SPECIFICATIONS:**

Material: Nylon66, rated UL 94V-0  
 Insulator color: Beige  
 Contacts: Brass  
 Plating: Tin over copper underplate overall.

**Electrical:**

Voltage Rating: 250V AC  
 Current Rating: 3 Amps Max  
 Dielectric Withstanding Voltage: 1000V AC for 1 minute.  
 Insulation Resistance: 1000 Megohms Min  
 Contact Resistance: 20 Milliohms Max  
 Temperature Range: -40°C to 105°C  
 Environmental: Lead free, RoHS compliant

Positions: 02 thru 20  
 A = .098 [2.50] x No. of Spaces  
 B = .098 [2.50] x No. of Spaces + .197 [5.00]

UNLESS OTHERWISE SPECIFIED  
 ALL DIMENSIONS ARE INCHES [MM]  
 TOLERANCES: EXCEPT AS NOTED  
 INCHES Holes  
 .X ±.10 ØXX ±.10  
 .XX ±.020 ØXXX ±.015  
 .XXX ±.015 ØXXXX ±.010

APPROVALS	DATE
DRAWN	DY
CHECKED	
APPROVED	

**ADAM TECH**  
 909 Rahway Avenue, Union, NJ 07083  
 Phone: 908-687-5000 Fax: 908-687-5710  
 TITLE: .098 [2.50] PITCH WAFER, RIGHT ANGLE  
 PCB TYPE

SIZE	PART NO.	REV.
X	25SH-E-XX-TR	A

REF: S00123T SCALE: NTS SHEET 1 OF 1



6

5

4

3

2

1