

FRONT EDGE OF CONNECTOR
PCB LAYOUT

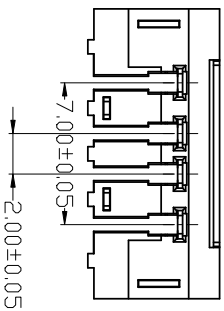
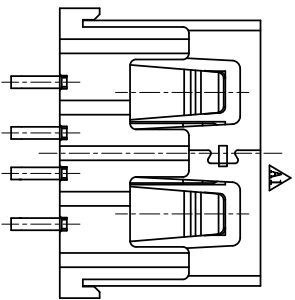
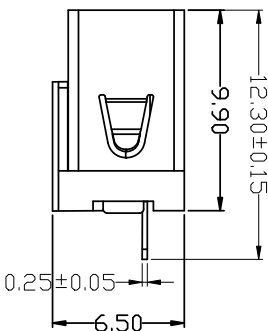
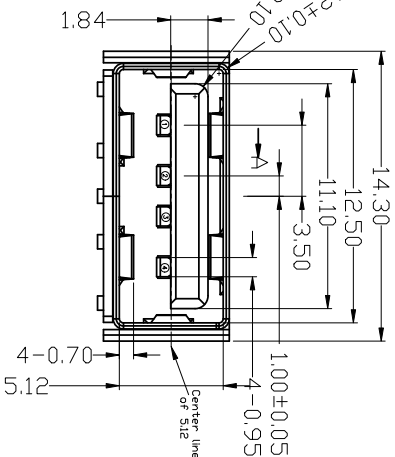

目 录 MAPX	设 变 内 容 MODIFICATION	日 期 DATE
-------------	-------------------------	-------------

电气特性:Electrical:

1. 额定电流: Current Rating
1.5A/contact terminal
2. 额定电压: Voltage Rating
30V DC
3. 接触阻抗: Contact Resistance
30 milliohms MAX
4. 耐压: Dielectric Withstanding Voltage:
500 V AC AT Sea Level
5. 绝缘阻抗: Insulation Resistance:
1000OMEGA ohms MIN

物理性能:Mechanical:

1. 插拔力: Connector Mate and Unmate Force
Mate force:3.57kgf (MAX)
Umate force:1.02kgf (MIN)
 2. 端子保持力: Terminal Retention
1. 2kgf (MIN)
 3. 寿命: 1500次
 - 原材料:Material:
1. 塑胶:Housing:PBT NC
 2. 端子>Contact:Copper Alloy C2680
 3. 外壳:Shell:SPCC
- 电镀:Finish:
1. 端子Contact: Au 0.7u" Plated on contact area
Tin50u" Plated on solder area
 2. 外壳Shell: Nickel 50u" Min plating over all.

产品图

Pin NUMBER	SIGNAL NAME
------------	-------------

1	VBUS
2	D-
3	D+
4	GND

公差一览表

TOLERANCE UNLESS OTHERWISE	
X	±0.25
.X	±0.20
.XX	±0.15
.XXX	±0.10

深圳市精拓金电子有限公司

单位 UNITS	MM	制图 DRAWING	林属升	产品料号 PRODUCT PART NO.	910-461A1012Y10100
比例 SCALE	1:1	审核 CHKD	郭志富	产品名称 PRODUCT NO.	AF10.0C款180度无脚无边壳
日期 DATE	2015/10/20	批准 APRD	黄国荣	角法 NEW	PBT自胶6.5
				版本 VER	A0