

**PLEASE CHECK WWW.MOLEX.COM FOR LATEST PART INFORMATION**

**Part Number:** [0495480390](#)  
**Status:** **Active**  
**Description:** 1.78mm (.070") Tab, 8.50mm (.335") Pitch Wire-to-Wire Female Housing TPA™, 3 Circuits, Vertical, Lower Type

**Documents:**

[Drawing \(PDF\)](#)

[RoHS Certificate of Compliance \(PDF\)](#)

**General**

|                |                           |
|----------------|---------------------------|
| Product Family | Accessories               |
| Series         | <a href="#">49548</a>     |
| Component Type | Retainer                  |
| Product Name   | TPA™ - Term Pos Assurance |

**Physical**

|                               |                 |
|-------------------------------|-----------------|
| Circuits (Loaded)             | 3               |
| Lock to Mating Part           | Yes             |
| Number of Rows                | 1               |
| Packaging Type                | Bag             |
| Temperature Range - Operating | -40°C to +120°C |

**Material Info**

**Reference - Drawing Numbers**

|               |              |
|---------------|--------------|
| Sales Drawing | SD-49547-001 |
|---------------|--------------|

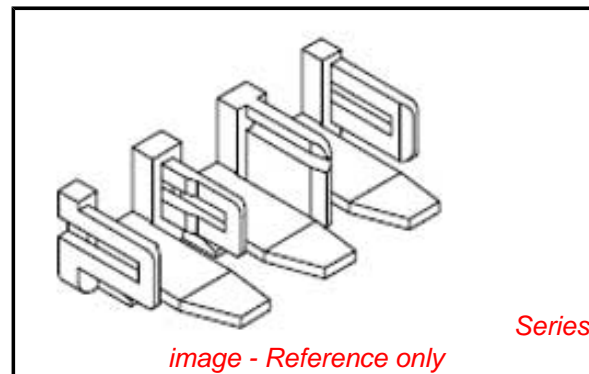

**EU RoHS**

**ELV and RoHS  
Compliant**

**REACH SVHC**

**Contains SVHC: No**

**Halogen-Free**

**Status**

**Halogen-Free**

**China RoHS**



**Need more information on product  
environmental compliance?**

Email [productcompliance@molex.com](mailto:productcompliance@molex.com)  
 For a multiple part number RoHS Certificate of Compliance, [click here](#)

Please visit the [Contact Us](#) section for any non-product compliance questions.

**Search Parts in this Series**

[49548Series](#)

**Use With**

[35965](#) Wire-to-Wire Female Housing

DWG. NO.  
SD-49547-001

SIMILAR ITEM

PROJECT NO.

B

DO NOT SCALE DRAWING  
DIMENSION IN METRIC

8 7 6 5 4 3 2 1

F

E

D

C

B

A

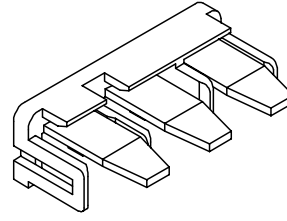
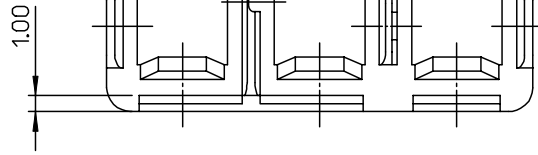

UPPER TYPE

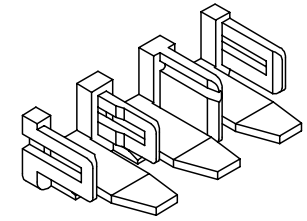

LOWER TYPE

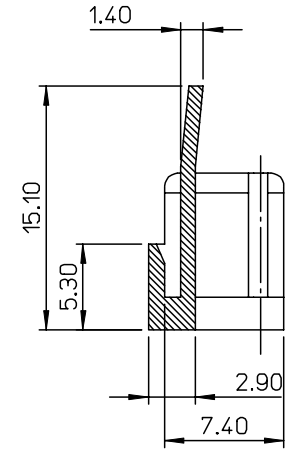
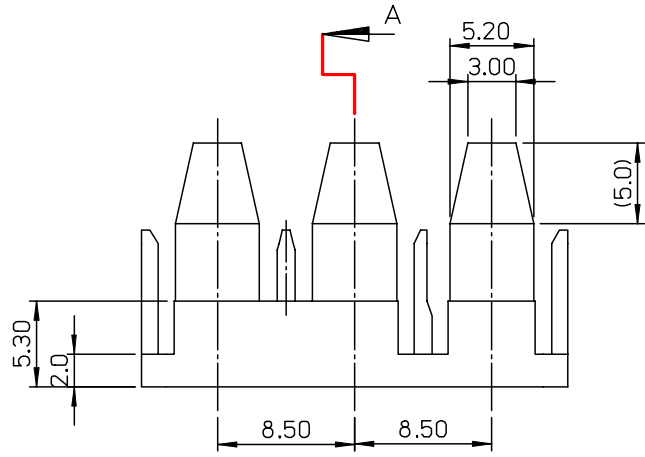
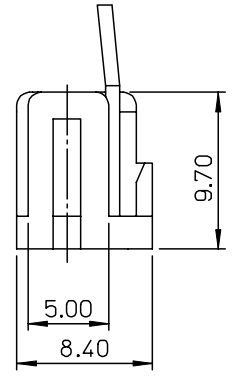

SECTION A-A

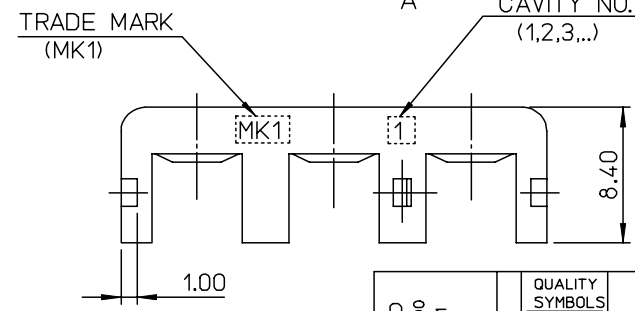
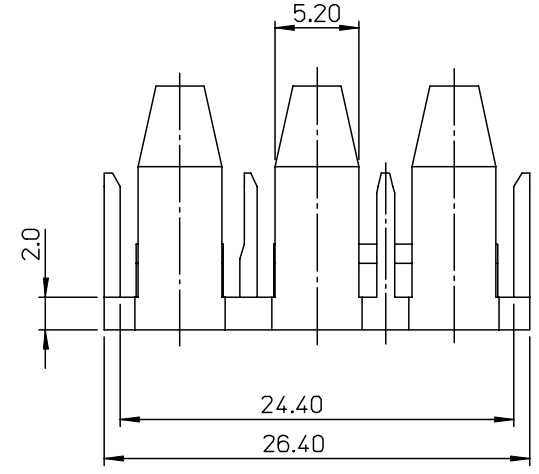

| NO. | DESCRIPTION | MATERIAL NO. | PART NO.   | FINISH        |
|-----|-------------|--------------|------------|---------------|
| 1   | UPPER TPA   | 495470392    | 49547-0392 | RED COLOR     |
| 2   | LOWER TPA   | 495480390    | 49548-0390 | NATURAL COLOR |

NOTES

- MATERIAL : POLYAMIDE,UL94V-2
- MATED HOUSING : 35965-02\*\*

|   |  |  |   |   |   |                    |
|---|--|--|---|---|---|--------------------|
| NEW RELEASED<br>ECN NO:KOR2006-0100<br>DRWN: J.B.JIN 06/02/11<br>CHK: W.Y.YANG<br>APPR: SH.CHOI | QUALITY SYMBOLS<br>MAJOR $\nabla = 0$<br>CRITICAL $\nabla C = 0$ | GENERAL TOLERANCES:<br>(UNLESS SPECIFIED)  | SCALE 3.5:1<br>DESIGN UNITS <input checked="" type="checkbox"/> mm <input type="checkbox"/> INCH  | THIRD ANGLE PROJECTION <input checked="" type="checkbox"/> THIRD ANGLE <input type="checkbox"/> FIRST ANGLE             | SHT<br>REV  |                    |
|   | DESCRIPTION<br>A   | DIMENSIONS:<br><input type="checkbox"/> mm <input type="checkbox"/> INCH <input checked="" type="checkbox"/> mm ONLY | 4 PLACES $\pm 0.$ mm $\pm -$ INCH<br>3 PLACES $\pm 0.$ mm $\pm -$ INCH<br>2 PLACES $\pm 0.20$ mm $\pm -$ INCH<br>1 PLACE $\pm 0.30$ mm $\pm -$ INCH | DRAWN BY & DATE<br>J.B.JIN 05/11/18<br>CHECKED BY & DATE<br>W.Y.YANG 05/11/18<br>APPROVED BY & DATE<br>SH.CHOI 05/11/18 | TITLE:<br>.070 MULTI W-I-W CONN.<br>COMMON TPA-3P<br>(UPPER,LOWER TYPE) | REVISE ON CAD ONLY |
|   | CAD FILENAME<br>S49547AA.MI                                      | MATERIAL NO.<br>SEE TABLE  | DRAWING NO.<br>SD-49547-001   | SHEET NO.<br>1 OF 1   | MOLEX INCORPORATED  | SIZE<br>B          |
|   | DRAFT WHERE APPLICABLE MUST REMAIN WITHIN DIMENSIONS             | ANGULAR: $\pm 1^\circ$   | THIS DRAWING CONTAINS INFORMATION THAT IS PROPRIETARY TO MOLEX INCORPORATED AND SHOULD NOT BE USED WITHOUT WRITTEN PERMISSION.                      | KOREA   | MX-A3   | 1 OF 1             |

8 7 6 5 4 3 2 1 KOREA MX-A3