

MATERIALS AND FINISHES

SMA JACK:
SEE SD-73391-026

MCX PLUG:
SEE SD-73366-001

CABLE: RG316

SHRINK TUBE: VERSAFIT OR
EQUIVALENT

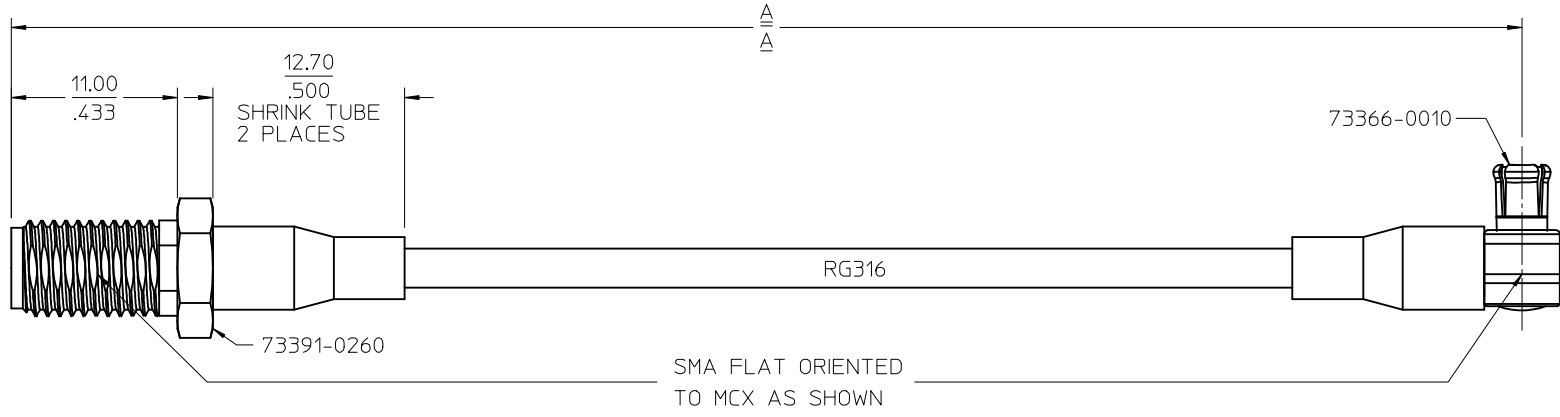
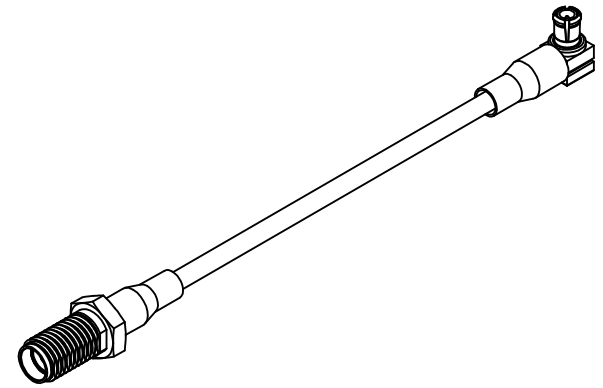

CABLES WILL BE INDIVIDUALLY BAGGED

BAG LABEL:
MOLEX: P/N
DATE CODE

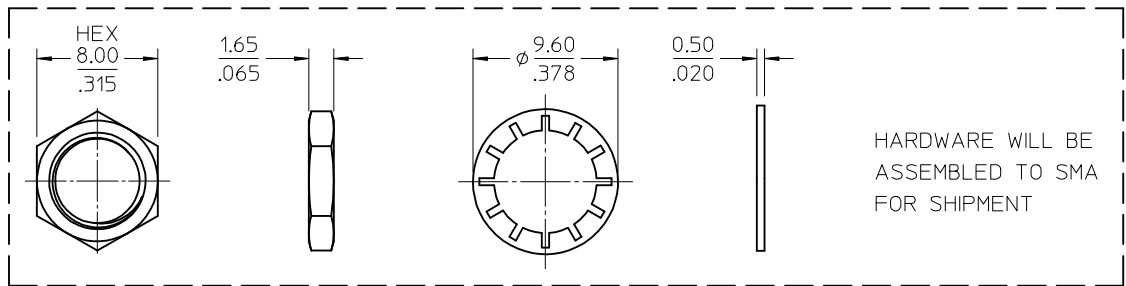

89761-6772	18.00±.35	457.20±8.89	POLYBAG
89761-6771	12.00±.25	304.80±6.35	POLYBAG
89761-6770	6.00±.25	152.40±6.35	POLYBAG
PART NO.	IN	MM	PACKAGING
	DIM A	DIM A	

CECC-22-220	INTERFACE MCX
MIL-STD-348A, FIG. 310.2	INTERFACE SMA
SPECIFICATION	DESCRIPTION

CHG: REGENERATED IN SYSTEM PER RF12-E082 EC NO: URF2013-0035 DRWR:YEH CHKD: APPR:MHUANG 2012/07/11 2012/07/28	QUALITY SYMBOLS ∇=0 ∇=0 ∇=0	GENERAL TOLERANCES (UNLESS SPECIFIED)		DIMENSION STYLE	SCALE	DESIGN UNITS	THIRD ANGLE PROJECTION	
				MM/IN	4:1	METRIC		
				DRAWN BY	DATE	TITLE		
				CHECKED BY	DATE	CA SMA JACK STR BKHD TO MCX PLUG R/A WITH RG316 CA-SMAJ/MCXP, EWR-3874		
		ANGULAR ± 2°		APPROVED BY	DATE	molex		
		DRAFT WHERE APPLICABLE MUST REMAIN WITHIN DIMENSIONS		MATERIAL NO.	DOCUMENT NO.	SHEET NO.		
				SEE TABLE	SD-89761-677	1 OF 1		
		THIS DRAWING CONTAINS INFORMATION THAT IS PROPRIETARY TO MOLEX INCORPORATED AND SHOULD NOT BE USED WITHOUT WRITTEN PERMISSION						