

● PROFESSIONAL LED INDICATORS Ø5.0mm Mounting

FEATURES



604 SERIES

PACK QUANTITY = 10 PIECES

- Bright nickel plated brass housing
- Sealed to IP67
- Excellent wide viewing angle characteristics
- Suitable for high vibration applications
- Internal reverse protection diode fitted as standard in all voltage models.

SPECIFICATION

Ordering Information & Typical Technical Characteristics (Ta = 25°C)

Mean Time Between Failure = 100,000 Hours. Luminous intensity figures refer to the unmodified discrete LED.

| PART NUMBER | COLOUR | LENS | VOLTAGE DC (Vdc) Vopr | CURRENT DC (mA) Iopr | LUMINOUS INTENSITY Iv@20mA (mcd) | WAVE LENGTH λp (nm) | OPERATING TEMP Topr | STORAGE TEMP Tstg | |
|-----------------------|------------|--------|--------------------------|-------------------------|-------------------------------------|------------------------|------------------------|----------------------|-----|
| HIGH INTENSITY | | | | | | | | | |
| 604-301-04 | Red | Smoked | 2.1 | 20 | 900 | 660 | -30 ~ +85 [^] | -40 ~ +85 | Yes |
| 604-325-04 | Yellow | Smoked | 2.2 | 20 | 4300 | 590 | -30 ~ +85 [^] | -40 ~ +85 | Yes |
| 604-324-04 | Green | Smoked | 2.2 | 20 | 7800 | 525 | -30 ~ +85 [^] | -40 ~ +85 | Yes |
| 604-934-04 | Blue | Smoked | 2.2 | 20 | 2300 | 470 | -30 ~ +85 [^] | -40 ~ +85 | Yes |
| 604-998-04 | Cool White | Smoked | 2.2 | 20 | 4600 | *see below | -30 ~ +85 [^] | -40 ~ +85 | Yes |
| 604-301-23 | Red | Smoked | 24-28 | 20 | 900 | 660 | -30 ~ +85 [^] | -40 ~ +85 | Yes |
| 604-325-23 | Yellow | Smoked | 24-28 | 20 | 4300 | 590 | -30 ~ +85 [^] | -40 ~ +85 | Yes |
| 604-324-23 | Green | Smoked | 24-28 | 20 | 7800 | 525 | -30 ~ +85 [^] | -40 ~ +85 | Yes |
| 604-934-23 | Blue | Smoked | 24-28 | 20 | 2300 | 470 | -30 ~ +85 [^] | -40 ~ +85 | Yes |
| 604-998-23 | Cool White | Smoked | 24-28 | 20 | 4600 | *see below | -30 ~ +85 [^] | -40 ~ +85 | Yes |
| UNITS | | | Vdc | mA | mcd | nm | °C | °C | |



Other voltages AC/DC available. Please contact our Technical sales.

[^] = Products must be derated according to the derating information. Each derating graph refers to specific LEDs. Refer to page 3.

| 998 | *Typical emission colour cool white | | | |
|-----|-------------------------------------|-------|-------|-------|
| x | 0.296 | 0.283 | 0.330 | 0.330 |
| y | 0.276 | 0.305 | 0.339 | 0.318 |

Intensities (Iv) and colour shades of white (x,y co-ordinates) may vary between LEDs within a batch.

How to Order:

website: www.marl.co.uk • email: sales@marl.co.uk •

• Telephone +44 (0)1229 582430 • Fax: +44 (0)1229 585155

The information contained in this datasheet does not constitute part of any order or contract and should not be regarded as a representation relating to either products or service. Marl International reserve the right to alter without notice the specification or any conditions of supply for products or service.



BS EN ISO 9001:2000
Approved Manufacturer

604 Series

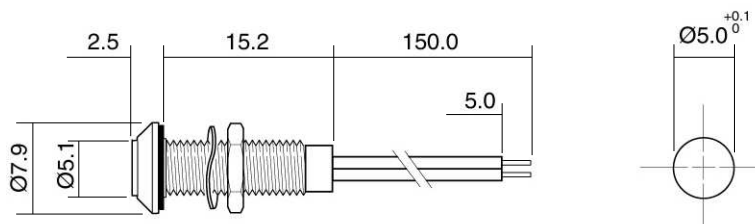

MOUNTING HOLE

Dimensions in mm (Typical)
Not to scale

Anode termination indicated by red lead.
Mounting hole to be clean and burr free

MATERIALS

| | |
|---------------|----------------------------|
| Body | Bright Nickel Plated Brass |
| Nut | Bright Nickel Plated Brass |
| Panel Seal | Viton |
| Fresnel lens | Polycarbonate |
| Encapsulation | Epoxy |
| Lock Washer | Beryllium Copper |

TECHNICAL CHARACTERISTICS

| SERIES | MAXIMUM POWER DISSIPATION | MAXIMUM REVERSE VOLTAGE | PANEL CUTOUT | NUT MOUNTING TORQUE | MINIMUM MOUNTING CENTRES | MIN/MAX. PANEL THICKNESS |
|--------|---------------------------|-------------------------|--------------|---------------------|--------------------------|--------------------------|
| 604 | 425 | 3* / 75• | 5.0 | 0.35 | x,y =10.0 | 1.5-8.0 |
| | mW | Vdc | mm | Nm | mm | mm |

* = Current Version • = Voltage Version

OPTIONAL FLYING LEAD TERMINATIONS

| ORDER CODE SUFFIX | SUPPLY VOLTAGE | WIRE COLOUR | WIRE LENGTH | NO/DIAMETER OF CONDUCTORS | DIAMETER OVER INSULATION | COMMENTS |
|-------------------|----------------|---------------------------|-------------|---------------------------|--------------------------|------------------------------|
| 19 | DC Products | Red-anode / Black-cathode | 1000mm | 19/0.15mm | 1.2mm | Customised lengths available |

How to Order:

website: www.marl.co.uk • email: sales@marl.co.uk •

• Telephone +44 (0)1229 582430 • Fax: +44 (0)1229 585155

The information contained in this datasheet does not constitute part of any order or contract and should not be regarded as a representation relating to either products or service. Marl International reserve the right to alter without notice the specification or any conditions of supply for products or service.



BS EN ISO 9001:2000
Approved Manufacturer

DERATING INFORMATION

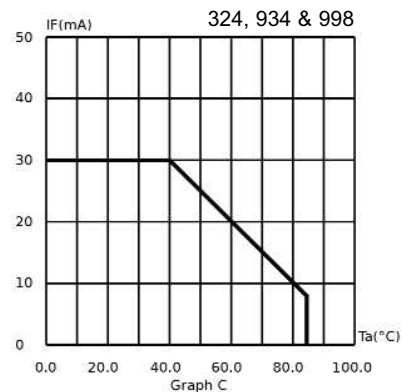
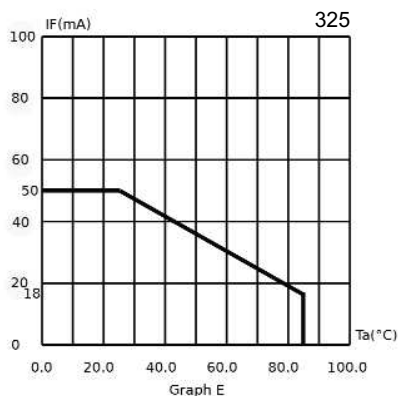
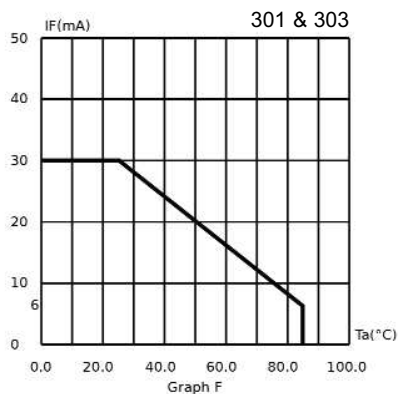

ALSO AVAILABLE

Part numbers also available in the 604 Series:

| PART NO. | COLOUR | VOLTAGE DC (Vdc) Vopr |
|---------------|--------|-----------------------|
| 604-301-23-19 | Red | 28 VDC |
| 604-303-21 | Red | 12 VDC |
| 604-312-01 | Green | 2mA |
| 604-312-22 | Green | 24 VDC |
| 604-324-20-19 | Green | 5/6 VDC |
| 604-324-22-19 | Green | 24 VDC |
| 604-324-23-19 | Green | 28 VDC |
| 604-325-23-19 | Yellow | 28 VDC |
| UNITS | | |

The products listed above illustrate all of the options available to order. These products may have custom modifications that alter their operation beyond the generic information contained within this datasheet. Please contact sales for further information.

How to Order:

website: www.marl.co.uk • email: sales@marl.co.uk •

• Telephone +44 (0)1229 582430 • Fax: +44 (0)1229 585155

The information contained in this datasheet does not constitute part of any order or contract and should not be regarded as a representation relating to either products or service. Marl International reserve the right to alter without notice the specification or any conditions of supply for products or service.



BS EN ISO 9001:2000
Approved Manufacturer