

REPAIR KIT	TERMINATING HEAD		
	PART NUMBER	DESCRIPTION	INSTRUCTION SHEET
856600-1	58246-1	MTA-100 Receptacles	408-6929
	58246-3		408-4147
856600-2	58247-1	MTA-156 Receptacles	408-6930
	58247-3		408-4146
	58392-1	MTA-156 Quad Connectors	408-9450

Figure 1

**1. INTRODUCTION**

This instruction sheet covers the installation of MTA Terminating Head Repair Kits 856600-[ ] for repair of the terminating heads listed in Figure 1. Read these instructions thoroughly before using the repair kit. Refer to the instructions packaged with the MTA terminating head for setup and adjustment instructions.

Reasons for reissue of this instruction sheet are provided in Section 5, REVISION SUMMARY.

**2. DESCRIPTION**

Each repair kit is designed to replace all of the wearable parts in the terminating head. The items contained in the repair kit and their function are as follows:

- Cam — indexes the feed slide after each termination
- Locating pawl — aligns the connector for insertion and retains it during termination
- Feed pawl (with compression spring) — engages the connector and indexes it into position for termination
- Feed slide — automatically positions the connector after each termination
- Drill blank — helps to remove and install the roll pin in the locating pawl

**3. INSTALLATION (Terminating Head Repair)**

1. Remove the four hex head screws securing the housing to the terminating head. See Figure 2.
2. Depress the adjuster slightly, and pull the housing straight off the terminating head.

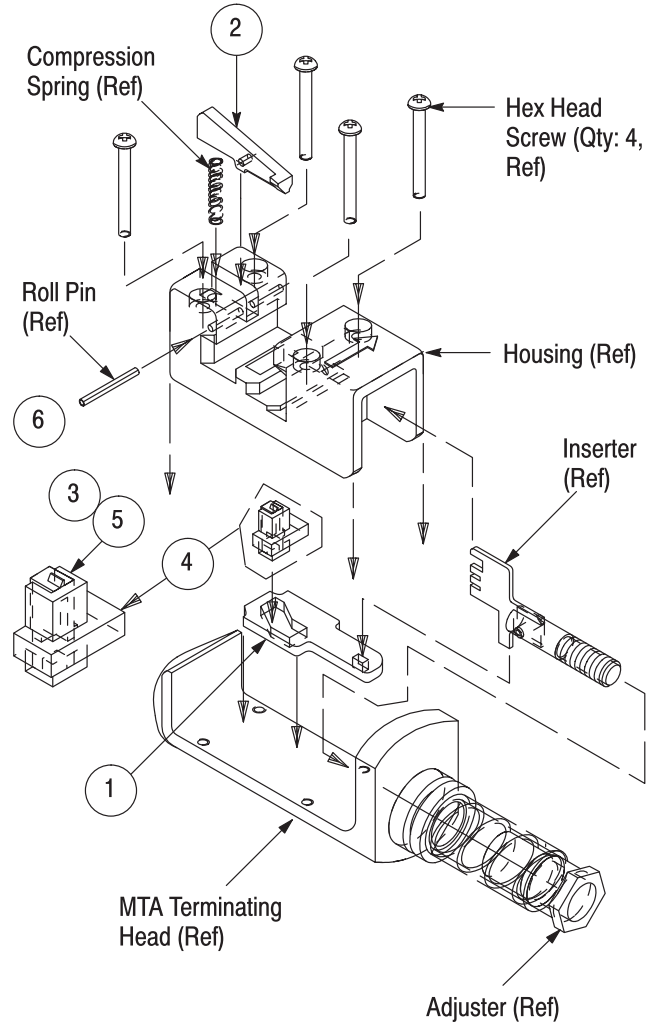

ITEM	PART NUMBER	DESCRIPTION	QTY PER REPAIR KIT	
			-1 (MTA -100)	-2 (MTA -156)
1	312159-1	CAM	1	—
	312153-1	CAM	—	1
2	312161-1	PAWL, Locating	1	—
	312147-1	PAWL, Locating	—	1
3	312192-1	PAWL, Finished Feed	1	1
4	312151-1	SLIDE, Feed	1	1
5	1-23147-2	SPRING, Compression	1	1
6	21667-4	DRILL BLANK	1	1

Figure 2

3. Remove the feed slide (subassembly) from the housing.



*The feed slide (subassembly) is spring-loaded. Handle the subassembly carefully to avoid inadvertent disassembly.*

4. Using the drill blank, drive the roll pin past the feed pawl. Remove and discard the old feed pawl.
5. Install the new feed pawl.



*BE SURE that the compression spring under the locating pawl is properly located.*

6. Install the new feed slide (subassembly).
7. Rotate and depress the adjuster slightly to remove the cam. Inspect the condition of the inserter. If the inserter is damaged or broken, it must be replaced according to Section 4. The inserter is not normally a wearing part and is not contained in the repair kit.
8. Install the new cam, and rotate the adjuster. Make sure that the cam and the inserter are oriented as shown in Figure 2.
9. Install the housing into the terminating head as follows:
  - a. Depress the adjuster slightly.
  - b. Guide the inserter into the slot in the housing.
  - c. Engage the feed slide into the opening in the cam.
  - d. Place the housing on the terminating head and secure it with the four hex head screws.

#### 4. REPLACEMENT AND REPAIR

The repair kit should be stocked to prevent lost time when replacement of parts is necessary. Order replacement parts through your representative, or call 1-800-526-5142, or send a facsimile of your purchase order to 717-986-7605, or write to:

CUSTOMER SERVICE (038-035)  
TYCO ELECTRONICS CORPORATION  
PO BOX 3608  
HARRISBURG PA 17105-3608

Terminating heads may be submitted for evaluation and repair. For customer repair service, call 1-800-526-5136.

#### 5. REVISION SUMMARY

Revisions to this instruction sheet include:

- Updated document to corporate requirements
- Added text to Section 2
- Corrected terminology in Steps 4 and 5 of Section 3