

**No. 396 / TE5®**

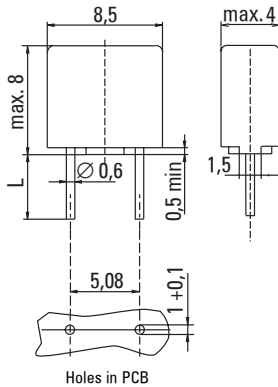

**Dimensions (mm)**



Long Leads (L=18.8 mm)  
Short Leads (L=4.3 mm)

Limits for Pre-arcing Time	
Rated Current	2.0 x I <sub>N</sub>
50 mA ... 6.30 A	< 60 s

**UL 248-14, 125 V, T  
Leadfree**

**Time-Current Characteristic**  
Time Lag (T)

**Standard**  
UL 248-14  
CSA C22.2 No. 248.14

**Approvals**  
UL Listed  
cUL Listed  
METI-PSE  
CCCe for China Import

**Features**

- Leadfree
- Reduced PCB space requirements
- Direct solderable or plug-in versions
- Internationally approved
- Low internal resistance
- Shocksafe casing
- Vibration resistant
- halogen free

**WebLinks**

**Further infos see:**  
[www.wickmanngroup.com](http://www.wickmanngroup.com)  
**Further application infos see**  
**Fuseology:**  
[www.wickmanngroup.com/download/fuseology.pdf](http://www.wickmanngroup.com/download/fuseology.pdf)



**Specifications**

**Packaging**

000: Tape/Ammopack (1400 pcs.)  
044: Short Leads - Bulk (1400 pcs.)

**Materials**

Base/Cap: Brown Thermoplastic  
Polyamide PA 6.6, UL 94V0  
Round Pins: Copper, Sn plated

**Operating Temperature**

-40 °C to +85 °C (consider de-rating)

**Climatic Category**

-40 °C/+85 °C/21 days  
(EN 60068-1,-2-1,-2-2,-78)

**Stock Conditions**

+10 °C to +60 °C  
relative humidity ≤ 75 % yearly average,  
without dew, maximum value for 30 days -95 %

**Vibration Resistance**

24 cycles at 15 min. each (IEC 60068-6)  
10 - 60 Hz at 0.75 mm amplitude  
60 - 2000 Hz at 10 g acceleration

**Lead Pull Strength**

10 N (IEC 60068-2-21)

**Solderability**

260 °C, ≤ 3 s (Wave)  
350 °C, ≤ 3 s (Soldering Iron)

**Soldering Heat Resistance**

260 °C, 10 s (IEC 60068-2-20)

**Marking**

Ⓜ, T, Current Rating, Approvals

**Unit Weight**

0.60 g (approx.)

**CCCe**

Permissible continuous operating current is ≤ 70 % at ambient temperature of 23 °C (73.4 °F).

Rated Current	Amp Code	Voltage Rating	Breaking Capacity	Voltage Drop 1.0 x I <sub>N</sub> Ⓜ max. (mV)	Power Dissipation 1.0 x I <sub>N</sub> Ⓜ max. (mW)	Melting Integral 10 x I <sub>N</sub> Ⓜ min. (A²s)	Approvals			
							UL	cUL	METI-PSE	CCCe
50mA	0050	125V		900	45	0.0056	•	•		•
63mA	0063	125V		800	50	0.009	•	•		•
80mA	0080	125V		700	55	0.014	•	•		•
100mA	0100	125V		600	60	0.025	•	•		•
125mA	0125	125V		550	70	0.044	•	•		•
160mA	0160	125V		480	80	0.058	•	•		•
200mA	0200	125V		390	80	0.1	•	•		•
250mA	0250	125V		350	90	0.17	•	•		•
315mA	0315	125V		300	95	0.26	•	•		•
400mA	0400	125V	100A / 125 V AC	250	100	0.32	•	•		•
500mA	0500	125V	50-60 Hz	220	110	0.58	•	•		•
630mA	0630	125V	cos φ = 1.0	210	135	0.75	•	•		•
800mA	0800	125V		160	130	0.98	•	•		•
1.00A	1100	125V		155	155	2.2	•	•	•	•
1.25A	1125	125V		145	185	3.8	•	•	•	•
1.60A	1160	125V		130	210	5.2	•	•	•	•
2.00A <sup>1</sup>	1200	125V		125	250	7.5	•	•	•	•
2.50A <sup>1</sup>	1250	125V		120	300	14	•	•	•	•
3.15A <sup>1</sup>	1315	125V		110	350	22	•	•	•	•
4.00A	1400	125V		110	400	27	•	•	•	•
5.00A	1500	125V		95	475	59	•	•	•	•
6.30A	1630	125V		95	570	100	•	•		•

**Order Information**

Qty.	Order-Number	Series	Amp Code	Packaging
		396		

Specifications are subject to change without notice

## TE5<sup>®</sup> / No. 396

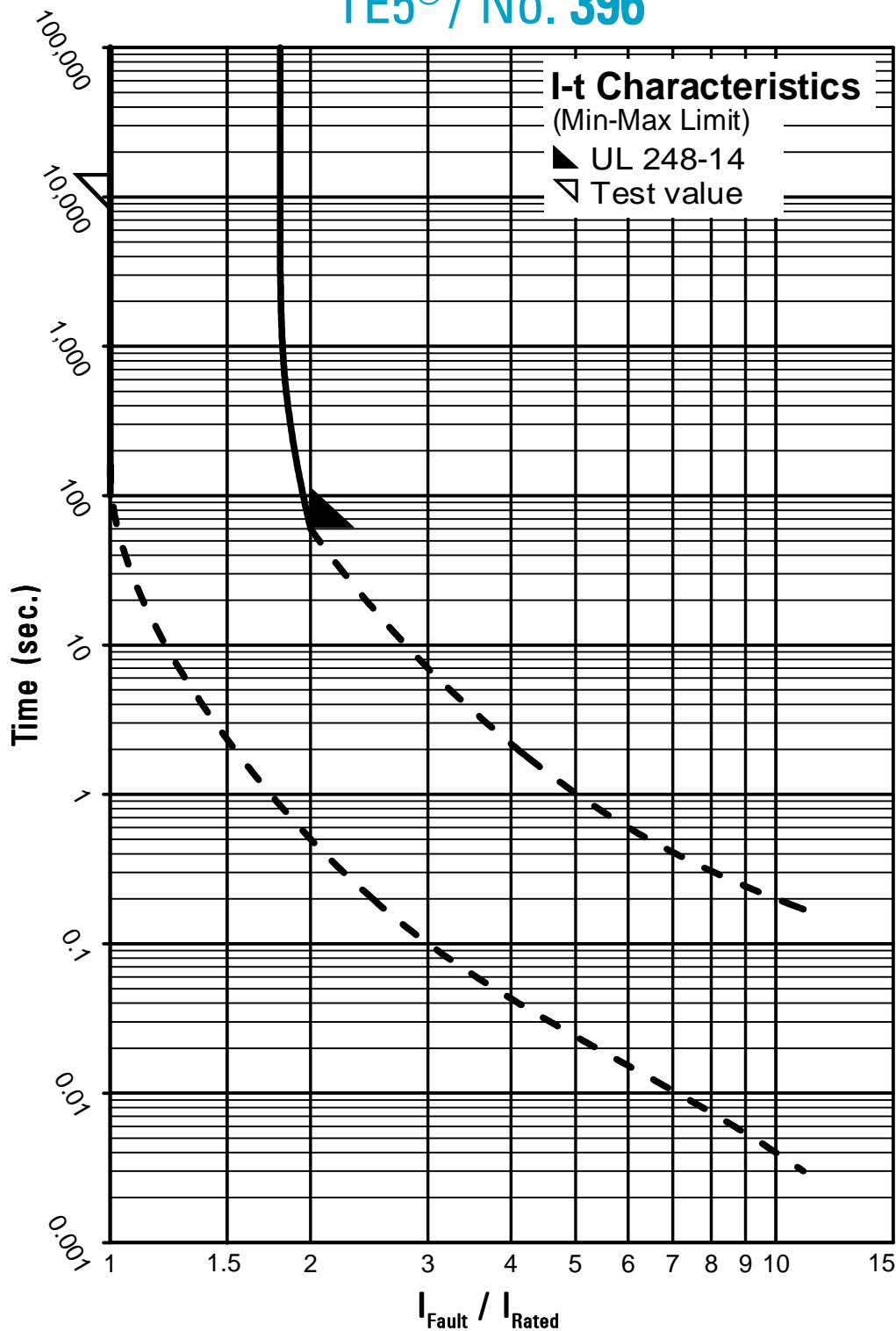

Contact WICKMANN for individual I-t curves