

Rev	AWO #	Description	Date	Appr
-		RELEASED	4/21/11	

APPROVED: \_\_\_\_\_  
 DATE: \_\_\_\_\_ TITLE: \_\_\_\_\_

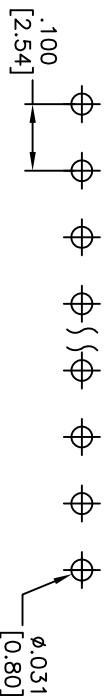

RECOMMENDED PCB LAYOUT

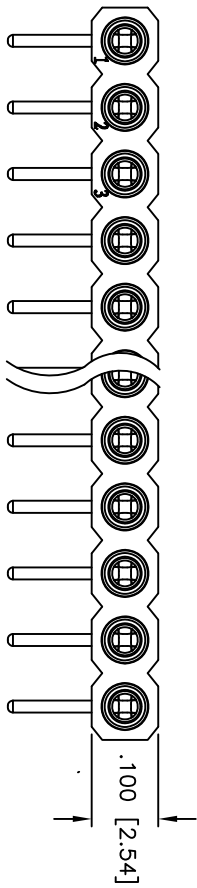
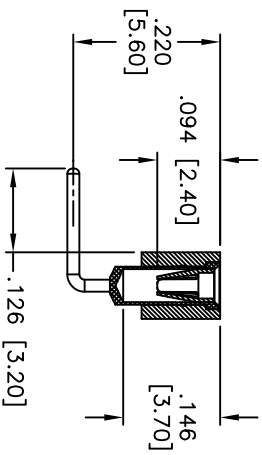
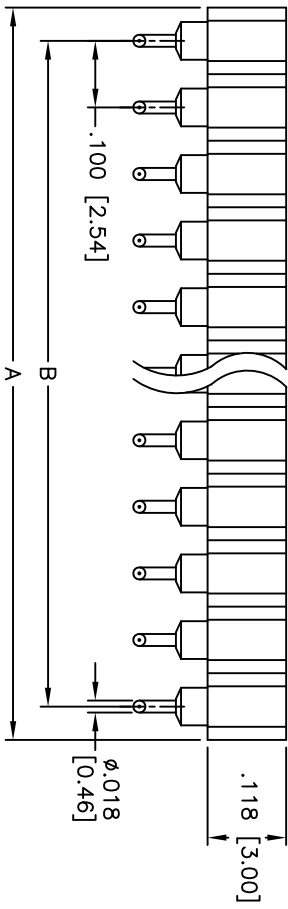

**SPECIFICATIONS:**  
 Material: HI-thermoplastic, Glass reinforced, rated UL 94V-0  
 Insulator color: Black  
 Contacts: BeCu  
 Sleeve: Brass  
 Plating:  
 Inner contact: Gold flash over Nickel underplate  
 Outer sleeve: Tin over Copper underplate overall  
 Electrical:  
 Current rating: 3 Amp  
 Contact resistance: 10 mohms max  
 Dielectric Strength: 1000V RMS min  
 Temperature Rating:  
 Operating temperature: -40°C to +105°C  
 Environmental:  
 Lead free, RoHS compliant  
 Recommended soldering temp: 260°C for 5 seconds

Positions: 2 thru 40  
 A = .100 [2.54] x No. of Positions  
 B = .100 [2.54] x No. of Spaces

UNLESS OTHERWISE SPECIFIED  
 ALL DIMENSIONS ARE INCHES [MM]  
 TOLERANCES: EXCEPT AS NOTED  
 INCHES: .X ± .10 Ø.X ± .10  
 .XX ± .020 Ø.XXX ± .015  
 .XXX ± .015 Ø.XXX ± .010

DRAWN	DY	4/21/11
CHECKED		
APPROVED		

**ADAM TECH**  
 909 Rahway Avenue, Union, NJ 07083  
 Phone: 908-687-5000 Fax: 908-687-5710

TITLE: .100 [2.54] MACHINED FEMALE HEADER,  
 SINGLE ROW, RIGHT ANGLE, GOLD/TIN PLATED

SIZE: X PART NO.: SMC-1R-XX-1-GT-HT  
 REF: S00019C SCALE: NTS SHEET 1 OF 1

**ROHS COMPLIANT**