

# HSS



RoHS Compliant

## Miniature Slide Switches



### Part Numbering

**HSS 1 12 A 12**

Series code      Number of poles      Current      Switching function      Terminal style

1	1 pole		1 pole	2 poles	Switching function	None	#187 Tab terminal
2	2 poles		A	K	ON — OFF	12	Solder terminal
			D	N	ON — ON		

### Terminal Styles

Single pole		Double poles	
Tab term.#187	Solder term.	Tab term.#187	Solder term.

### Panel Cut Out Dimension

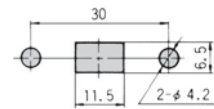

Table of Part Numbers → Page 524.

### HSS112

### 1 pole

Opposite side 4.6  
Depth 1.0

Stroke (5)

Part number marking side

Solder term.

Terminal numbers are shown on the bottom of the switch.

**S/D**

### Dimension L

Part No.	Terminal style	TAB#250	Solder
HSS112A	■	24	20.5
HSS112D	■	24	20.5

### Specifications

	Rating	Initial contact resistance	Dielectric strength	Insulation resistance	Electrical life
HSS112A	AC125V 12A Max. AC250V 6A Max.	100mΩ Max. (DC2~4V 1A)	AC1500V 1 minute	100MΩ Min. (DC500V)	15,000 cycles
HSS112D	AC-DC 6V 1mA Min.				

Part No.	Switching function	
	Viewed from part No. marking side	
HSS112A		
HSS112D		

### HSS208

### 2 pole

Opposite side 4.6  
Depth 1.0

Stroke (5)

Part number marking side

Solder term.

Terminal numbers are shown on the bottom of the switch.

**S/D**

Part No. marking

**TAB**

### Specifications

	Rating	Initial contact resistance	Dielectric strength	Insulation resistance	Electrical life
HSS208K	AC125V 8A Max. AC250V 5A Max.	100mΩ Max. (DC2~4V 1A)	AC1500V 1 minute	100MΩ Min. (DC500V)	15,000 cycles
HSS208N	AC-DC 6V 1mA Min.				

Part No.	Switching function	
	Viewed from part No. marking side	
HSS208K		
HSS208N		

■ To check the full part number of the products marked with the ■, please refer to "Table of Part Numbers" on P. 530.