

REV	DESCRIPTION	BY DATE	APPD
A	RELEASE PER ECR 7317	JWH 4/1/02	JEM

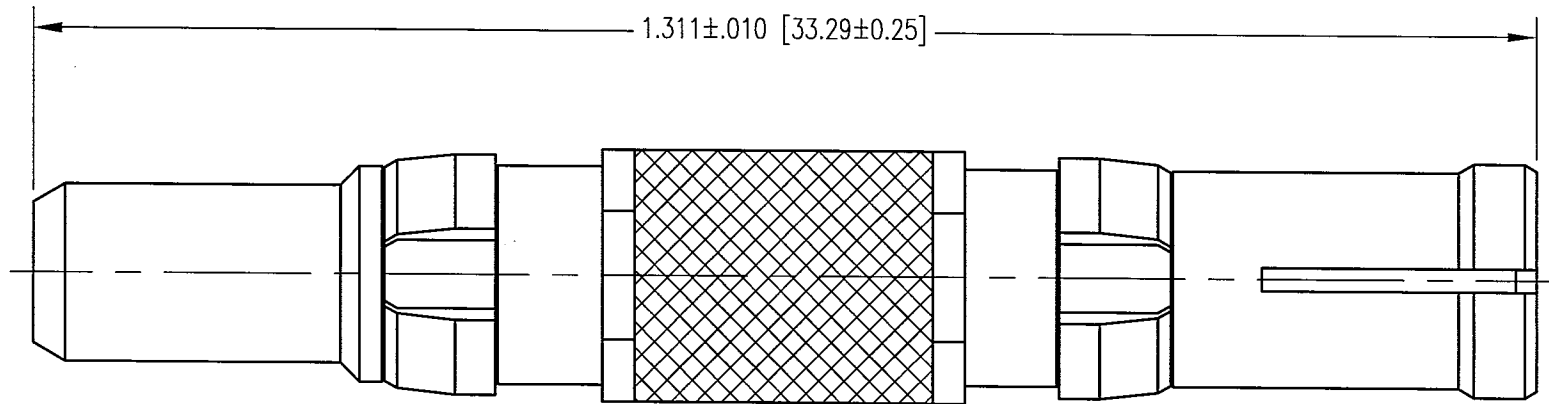

NOTES:

1. MATERIALS:

- PLUG BODY & RECEPTACLE CONTACT: BRASS PER ASTM B16
- RECEPTACLE BODY & PLUG CONTACTS: COPPER ALLOY
- CLIP RINGS: BERYLLIUM COPPER PER ASTM B194

2. FINISH:

- BODIES AND CONTACT: .000030 MIN. GOLD PER MIL-G-45204 OVER
.000050 MIN. NICKEL PER QQ-N-290
- CLIP RINGS: .000100 MIN. NICKEL PER QQ-N-290 OVER
COPPER FLASH

PER ASME Y14.5M-1994 UNLESS OTHERWISE SPECIFIED: DIMENSIONS ARE IN INCHES [MM]		NORTHROP GRUMMAN	
TOLERANCES: DECIMALS .XX ± .01 [0.254] .XXX ± .005 [0.127]		Winchester Electronics 400 Park Road Watertown, CT 06795	
ANGLES ± 2° SCALE: 6:1		TITLE 31 SERIES PLUG TO 31 SERIES RECEPTACLE ADAPTER	
CUSTOMER DRAWING			
DRAWN MJF	DATE 1/15/02	CHECKED JWH	DATE 1/16/02
APPROVED JEM	DATE 1/15/02	APPROVED JED	DATE 1/15/02
A 310-311-1000G		SHT. 1	DF 1
		REV. A	