

PCB LAYOUT
S=2:1

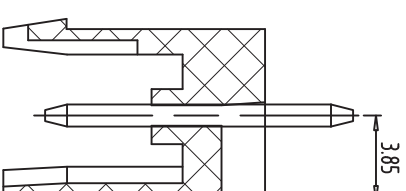

SECTION:A-A

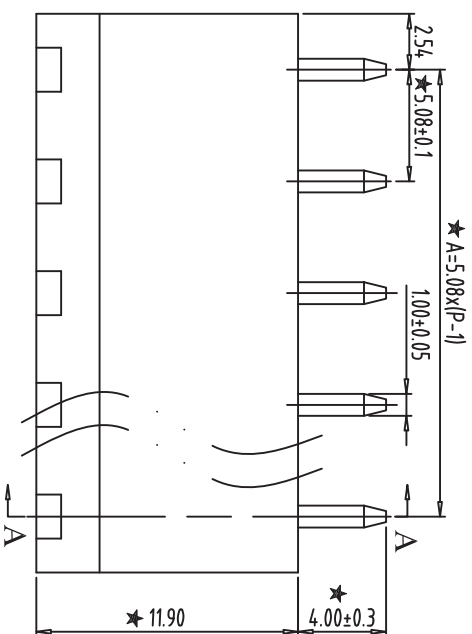
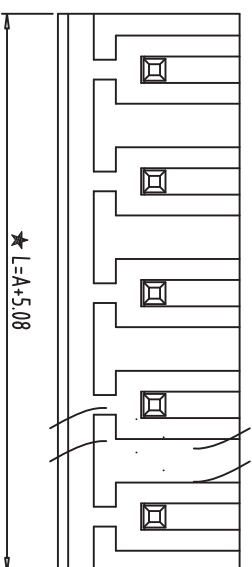
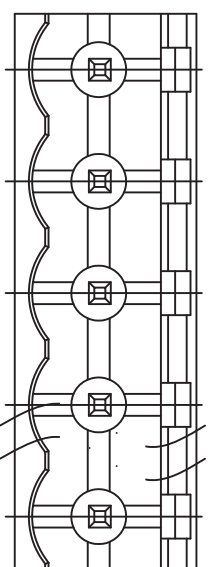
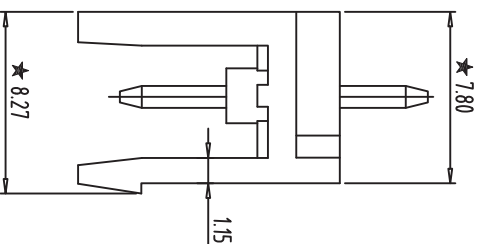

- NOTES:
1. Rating:300V 15A ;
 2. Insulation Withstands Voltage: AC2000V/MIN
 3. Insulation Resistance: 500MΩ or more at DC500V
 4. Using Temperature Range: -40°C~+105°C
 5. "★" is the important dimension
 6. RoHS compliance

REV	CONTENT	CHK	DATE
V0.0	CONTENT	SK	2014/08/19

Total Pitch Tolerances		Nominal dimension range																								
In mm		In mm																								
0	to	0	to	30	to	53	to	70	to	90	to	115	to	150	to	200	to	250	to	320	to	100	to	150		
±0.18	to	±0.25	to	±0.3	to	±0.35	to	±0.44	to	±0.50	to	±0.55	to	±0.70	to	±0.80	to	±0.90	to	0.2	to	0.3	to	0.3	to	0.5

ITEM	NAME OF PART	NO. OF PART	Q'TY	MATERIAL	NOTE
DWG	SK	DATE	2014/08/19	A4	SHEET/OF 1/1
CHK	DATE	DATE	SCALE	3:1	2EDG-5.08
APP.	DATE	DATE	SCALE	NAME	

深圳市金航标电子有限公司
KH-F400V-6P-5.08G
WWW.BDS666.COM
0755-83044319