

LPH6012 Series



<http://www.abco.co.kr>

■ Shape & Dimensions / Recommended Solder Land Pattern

(Dimensions in mm)

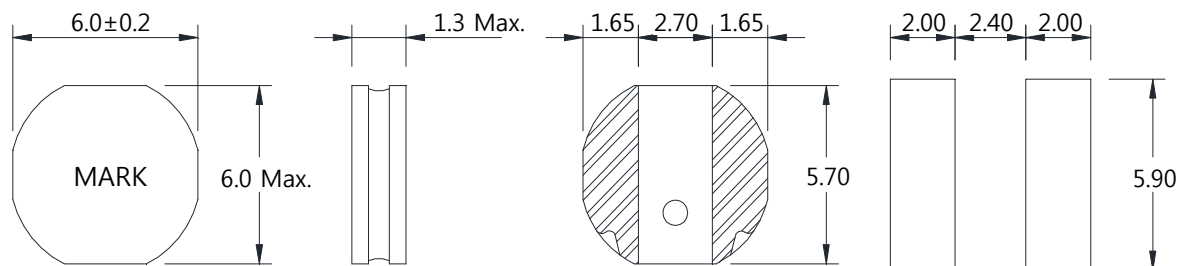

■ Electrical Characteristics

Ordering Code	Inductance		Freq. F (KHz)	DC Resistance (Ω) Rdc ($\pm 20\%$)	Rated DC current (A)	
	L (μ H)	Tol. (%)			Idc1 (Max.)	Idc2 (Typ.)
LPH6012T-1R0N	1.0	± 30	100	0.065	4.80	3.40
LPH6012T-2R2N	2.2			0.100	3.50	2.50
LPH6012T-6R8M	6.8	± 20		0.230	1.90	1.70

■ Test Equipments

- . L : Agilent E4980A LCR Meter
- . Rdc : HIOKI 3540 m Ω HiTESTER
- . Idc1 : Agilent 4284A LCR Meter + Agilent 42841A Bias Current Source
- . Idc2 : Yokogawa DR130 Hybrid Recorder + Agilent 6692A DC Power Supply

■ Test Condition

- . L(Frequency , Voltage) : F=100 (KHz) , V=0.5 (V)
- . Idc1(The saturation current) : $\Delta L \leq 30\%$ reduction from initial L value
- . Idc2(The temperature rise): $\Delta T = 40^\circ\text{C}$ typical at rated DC current
- ※ Rated DC current(Idc) : The value of Idc1 or Idc2 , whichever is smaller