

ALTERNATOR DIODE FOR AUTOMOTIVE APPLICATION.

#### FEATURES

- Average Forward Current :  $I_O=50A$ .
- Repetitive Peak Reverse Voltage :  $V_{RRM}=200V$ .

#### POLARITY

E50A2CS (+ Type)

E50A2CR (- Type)

#### MAXIMUM RATING (Ta=25 )

CHARACTERISTIC	SYMBOL	RATING	UNIT
Repetitive Peak Reverse Voltage	$V_{RRM}$	200	V
Average Forward Current	$I_{F(AV)}$	50	A
Peak 1 Cycle Surge Current	$I_{FSM}$	600 (50Hz)	A
Junction Temperature	$T_J$	-40 190	
Storage Temperature Range	$T_{stg}$	-40 150	

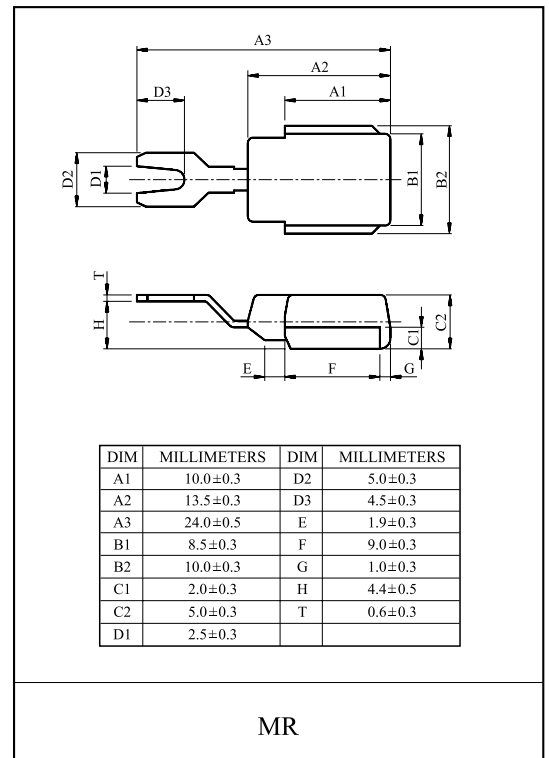

#### ELECTRICAL CHARACTERISTICS (Ta=25 )

CHARACTERISTIC	SYMBOL	TEST CONDITION	MIN.	TYP.	MAX.	UNIT
Peak Forward Voltage	$V_{FM}$	$I_{FM}=100A$	-	-	1.05	V
Repetitive Peak Reverse Current	$I_{RRM}$	$V_{RRM}=200V$	-	-	50	μA
Reverse Recovery Time	$t_{rr}$	$I_F=0.1A, I_R=0.1A$	-	-	15	μs
Temperature Resistance	$R_{th}$	DC total junction to case	-	-	1.0	/W

# E50A2CS, E50A2CR

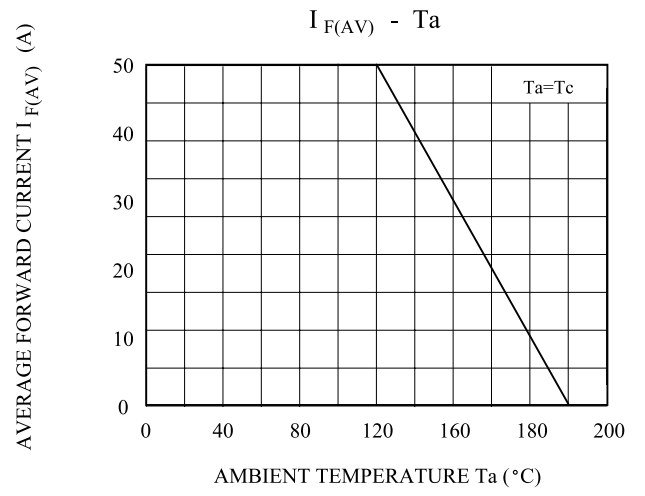
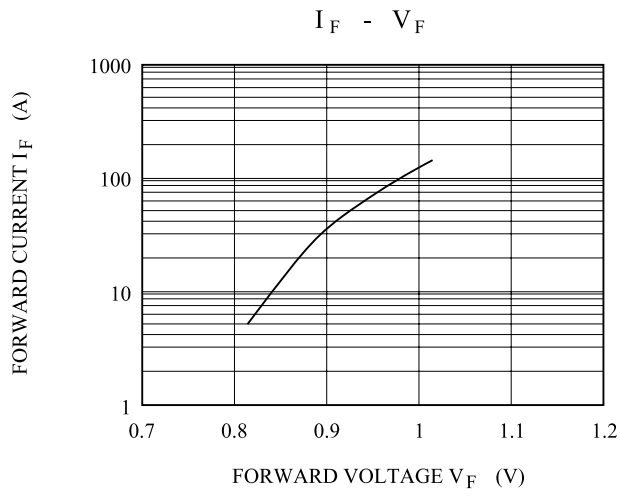

**Not recommended  
for new design**